

### CERTIFICATE OF LOCATION OF GOVERNMENT CORNER

East Quarter Corner, Section 15, Township 142 North, Range 26 West, of the Fifth Principal Meridian, Cass County, Minnesota.

July, 1997, Northern Lights Surveying and Mapping, Inc. monumented the quarter corner at the intersection of the line connecting the East Quarter Corner, Section 16, and the Center Quarter of Section 15 with the line connecting the Northeast Corner, Section 22, to iron pipes set or found by Walt Curo along the line between Sections 14 and 15.

#### SKETCH OF REFERENCE TIES & EVIDENCE

## T.142N., R.26W.

Section 15

Section 14

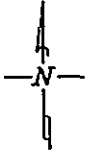

#### NOT TO SCALE

Bearings are Grid North Minnesota Central Zone, measured with a hand compass adjusted to 3°E East declination.

New bearing trees were blazed, scribed & painted red. A tag stating the bearing & distance was affixed to the tree. A nail was placed in the base of the tree and the distance was measured from the monument to the nail.

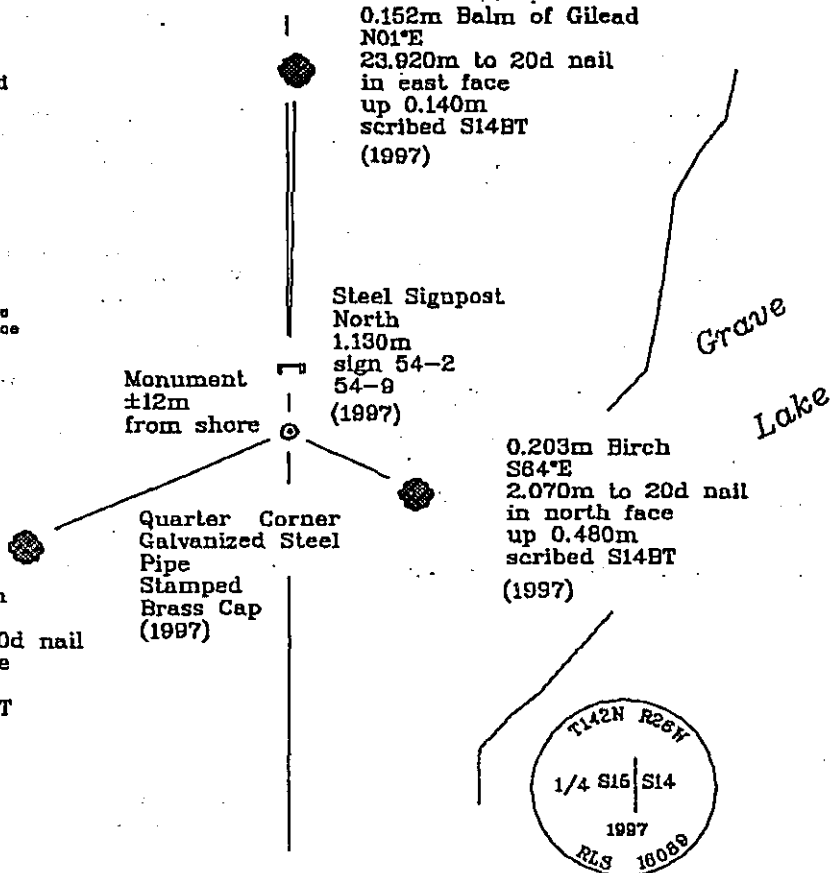

395055

Statement of evidence relative to this corner location is on the back of this page

I hereby certify that this survey, plan, or report was prepared by me or under my direct supervision and that I am a duly Licensed Land Surveyor under the laws of the State of Minnesota.

*LaVerne Leuelling*  
LaVerne Leuelling  
Date 11-16-97

Registered Land Surveyor No. 16089  
NORTHERN LIGHTS SURVEYING & MAPPING

OFFICE OF THE COUNTY RECORDER  
County of Cass

I hereby certify that this document was filed in the Recorder's office.

Time: 3:18 P .M. Date: Dec. 8, 1997  
Recorder Claudine Kayer  
By K.F. Deputy  
DOCUMENT NO. 395055

## Statement of Evidence

East Quarter Corner, Section 15, Township 142 North, Range 28 West, of the Fifth Principal Meridian, Cass County, Minnesota.

1872; General Land Office (G.L.O.) survey notes; Deputy Surveyor E.W. Griffin set a wooden post for the quarter and referenced it with the following:

10" Spruce (0.254m)	10" Spruce (0.254m)
S42°W	S88°E
20 Links (4.023m)	15 Links (3.018m)

Said records are on file with the Secretary of State, St. Paul, Minnesota; handwritten copies of these notes are on file with the Cass County Surveyor's Office, Walker, Minnesota.

April, 1983; U.S.D.A.-F.S. Field Book #1, p. 32; U.S.D.A.-F.S. crew found a metal location poster on a 10" (0.254m) Aspen stub which read 15 Links (3.018m) NW to corner. The crew chained 2640' (804.874m) north from the section corner common to Sections 14, 15, 22, and 23. They found a squared post on the ground 20' (6.096m) east of the corner, but the post was not scribed.

October, 1993; U.S.D.A.-F.S. Field Book #1, p.32; U.S.D.A.-F.S. crew of Krause and Hayes, along with adjacent landowner Bill Aegerton, chained north from the section corner 2640' (804.874m). They found no evidence of the original corner, nor of the metal tag. The chainage fell about 80' (24.384m) west of the lakeshore and about 40' (12.192m) north of a presumed property line as pointed out by R. Plagens, also an adjacent landowner. The feature call from original G.L.O. notes (enter cedar at 2145' {853.797m}) fit, but could also have fit if the line was moved easterly.

November 25, 1998; Northern Lights Surveying and Mapping, Inc. crew of Leuelling and Sherek traversed to and searched a position for the quarter corner and found no conclusive G.L.O. evidence. Also tied into were a number of property corners set by Walt Curo during private surveys (R.L.S. #11395).

July 16, 1997; Northern Lights Surveying and Mapping, Inc. crew of Smith and Gerving monumented the quarter corner position which is at the intersection of the prolongation of lines through the quarter corner common to Sections 15 and 16 and center quarter corner of Section 15, and the line connecting the section corner common to Sections 14, 15, 22 and 23 to iron pipes set or found by Walt Curo along the line between Sections 14 and 15, respectively; the monument is a 1.219m long, 0.051m diameter galvanized steel pipe with a 0.083m diameter stamped brass cap, up 0.240m. The crew set the following references:

0.203m Birch	0.203m Birch	0.152m Balm of Gilead	Steel Signpost
S66°W	S64°E	N01°E	North
5.068m to 20d nail	2.070m to 20d nail	23.920m to 20d nail	1.130m
in south face	in north face	in east face	sign 54-2
up 0.110m	up 0.480m	up 0.140m	54-9
scribed S15BT	scribed S14BT	scribed S14BT	

Northern Lights Surveying and Mapping, Inc. Slater Township Field Book #2, p.51.

## Coordinates:

## Cass County North

Northing = 84,986.73 meters  
Easting = 173,028.45 meters

State Plane Coordinate System  
Minnesota Central Zone  
NAD 83

Northing = 334,4981.07 meters  
Easting = 823,157.01 meters

Latitude = 47°06'49.18851" North  
Longitude = 93°56'41.57805" West