

# CERTIFICATE OF LOCATION OF GOVERNMENT CORNER

Northeast Corner of Section 23, Township 143, Range 25, 5th P.M.

STATE OF MINNESOTA, County of Cass

At the corner location shown on the sketch:

- On 10/14/94 found a 2 inch iron pipe with brass cap up 16 inches  
DATE
- left monument as found,  lowered monument,  removed monument (explain)
- On \_\_\_\_\_ placed a \_\_\_\_\_  
DATE

Magnetic Decl: 5° East  
Not to Scale

### SKETCH OF REFERENCE TIES

All distances are horizontal to nail in side of tree

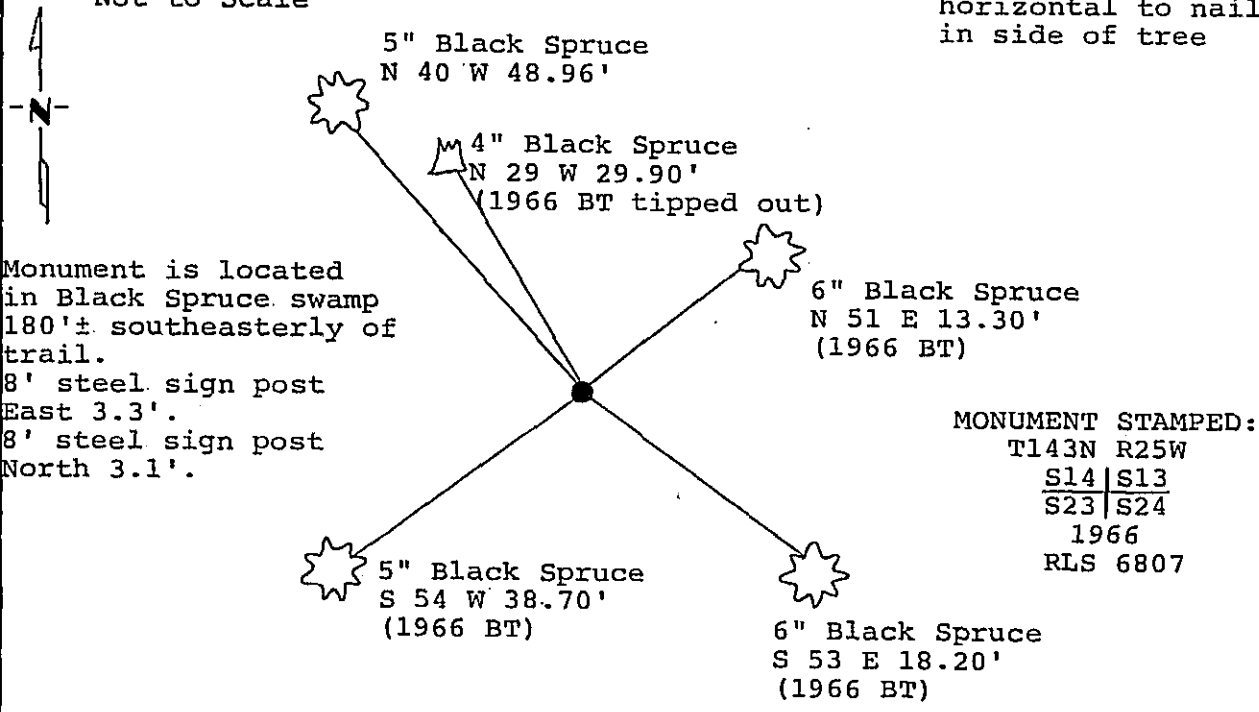

Monument is located in Black Spruce swamp 180'± southeasterly of trail.  
8' steel sign post East 3.3'.  
8' steel sign post North 3.1'.

All bearing trees are scribed, painted with red enamel and marked with a 54-3 (bearing tree) tag.

Statement of evidence relative to this corner location is on back of page.

I hereby certify that this document and the data contained herein was prepared by me or under my direct supervision.

*Clyde L. Sumner*  
SIGNATURE

3/16/95  
DATE

Registration No. 21367

- Land Surveyor
- County Surveyor

365397

OFFICE OF THE COUNTY RECORDER  
County of CASS

I hereby certify that this document was filed in the Co. Recorders office at 12:00 P.M. on the 16th day of MARCH A.D., 1995

County Recorder Claudine Kaylar

By N.S., Deputy

DOCUMENT NO. 365397

Statement of Evidence:

Northeast corner, Section 23, Township 143  
North, Range 25 West, Cass County, Minnesota

N-21

1872 Hayward Griffin, U.S. Deputy Surveyor, originally established this corner position while subdividing Township 143 North, Range 25 West. The notes indicate that he set a wood post and marked the following bearing trees: a 4 inch Spruce South 11 degrees West a distance of 15 lks (9.90 feet); a 4 inch Spruce North 32 degrees East a distance of 18 lks (11.88 feet); and a 4 inch Spruce North 78 degrees West a distance of 10 lks (6.60 feet).

1966 on October 9, United States Forest Service notes in Book 1, Page 63 for Township 143 North, Range 25 West, show that Technician James Eckstrom found a very old, rotted post, rotted stump of the original Southeast bearing tree and an old C-C tag. Tie to Skunk Lake to west fits good. He set a 2 inch by 60 inch steel pipe filled with concrete and capped with bronze cap. He marked the following bearing trees: a 4 inch Black Spruce North 51 degrees East a distance of 13.30 feet; a 4 inch Black Spruce North 29 degrees West a distance of 29.90 feet; a 4 inch Black Spruce South 54 degrees West a distance of 38.70 feet; and a 4 inch Black Spruce South 53 degrees East a distance of 18.20 feet.

1976 Bureau of Land Management dependent resurvey, notes on file in Secretary of State Office, found United States Forest Service 2 and 1/2 inch iron pipe with brass cap and all 1966 bearing trees in good condition.

1979 Milo Stefan, United States Forest Service, Registered Land Surveyor Number 12261, filed "Certificate of Location of Government Corner", document #246209. Corner was set from evidence of original survey. Monument and ties are the same as the 1966 United States Forest Service report by Eckstrom.

1994 on October 14, a Landecker & Associates, Inc. survey crew traverse through corner and find 2 inch iron pipe with brass cap. On December 1, they tie out corner using 1966 bearing trees. One new bearing tree was marked as shown and steel sign posts set as noted on front of this certificate. Landecker & Associates, Inc. accepts the found monument as a perpetuation of the original corner.