

CERTIFICATE OF LOCATION OF GOVERNMENT CORNER

Reference Monument on

West Line of Section 34/35, Township 139N, Range 26W, 5th P.M.

35 Roosevelt Lake

STATE OF MINNESOTA, County of Cass

At the corner location shown on the sketch:

On 07/31/91 found a 1-1/2 inch pipe
DATE

left monument as found, lowered monument, removed monument (explain)

On _____ placed a _____
DATE

SKETCH OF REFERENCE TIES

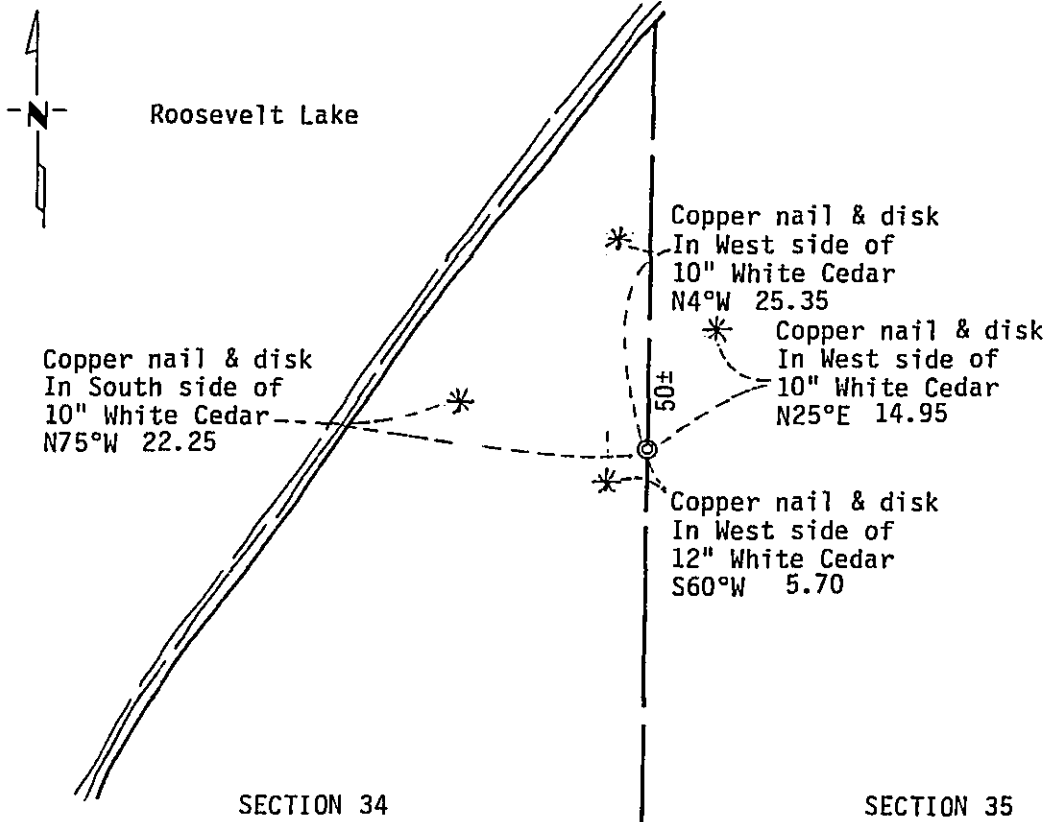

Statement of evidence relative to this corner location is on back of page.

I hereby certify that this document and the data contained herein was prepared by me or under my direct supervision.

James W. Nielsen 4/14/1993
SIGNATURE DATE

Registration No. 11865

Land Surveyor, Professional Engineer

County Surveyor, County Engineer

347761
OFFICE OF THE COUNTY RECORDER
County of CASS

I hereby certify that this document was filed in the Co. Recorders office at 4:10 P.M. on the 2nd day of June A.D., 19 93

County Recorder Claudine Kaylar

By N.O., Deputy

DOCUMENT NO. 347761

Statement of Evidence:

Reference Monument on West Line of Section 35,
Township 139 North, Range 26 West, Roosevelt Lake

In 1863 the Original Public Land Survey was run and a wood post was set at the meander corner on the south side of Roosevelt Lake 2072.40 feet north of the West Quarter Corner of Section 35.

1951 Mn/DOT location notes call for an iron pipe 420.1 feet north of P.O.S.T. Station 390+22.5.

In 1969 Mr. Don Coulter surveyed Government Lots 1 and 2 in Section 35 and indicates he found a monument on the west line of Section 35, 2019.32 feet north of the West Quarter Corner of Section 35.

In 1991 Mn/DOT found a 1-1/2 inch pipe on the west line of Section 35 2019.40 feet north of the West Quarter Corner of Section 35. This pipe also agrees with the 1951 location and is accepted by Mn/DOT as a Reference Monument on the west line of Section 35.

For details and survey analysis contact the Mn/DOT Surveys Office in Baxter, MN.