

CERTIFICATE OF LOCATION OF GOVERNMENT CORNER

NORTH QUARTER Corner of Section 23 , Township 140 , Range 29 , 5th P.M.

STATE OF MINNESOTA, County of CASS

At the corner location shown on the sketch:

On 7-8-91 found a 3/4" IRON PIPE (FLUSH)
DATE

left monument as found, lowered monument, removed monument (explain)

On _____ Placed a _____
DATE

SKETCH OF REFERENCE TIES

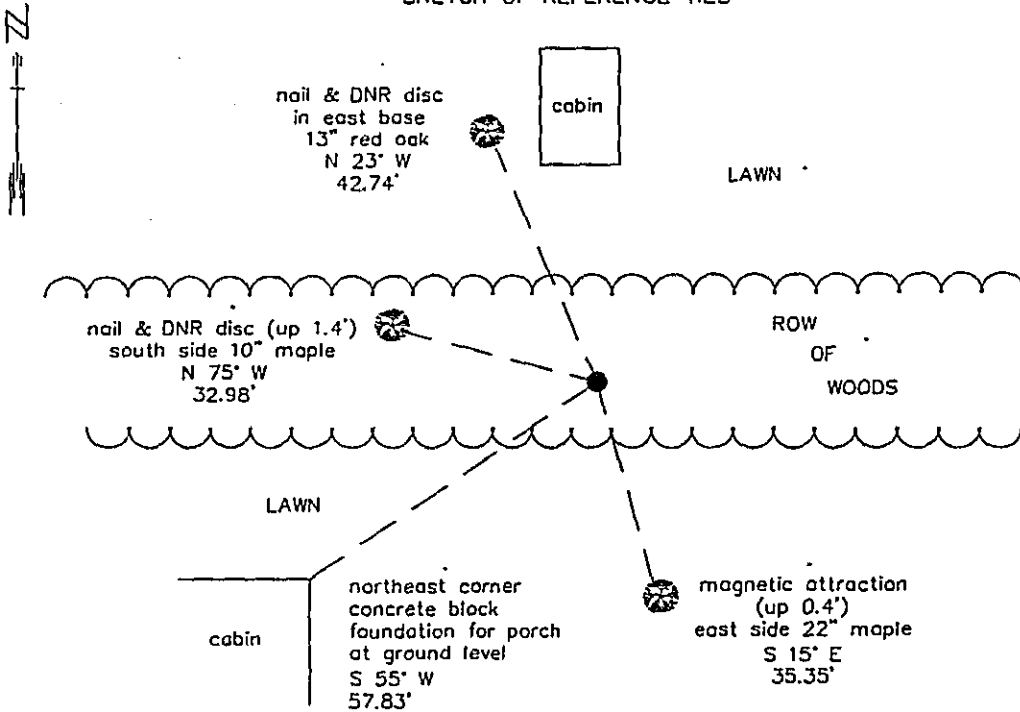

bearings observed with a compass

Statement of evidence relative to this corner location is on back of page.

8-20-91
WMA 00355

343678

I hereby certify that this document and the data contained herein was prepared by me or under my direct supervision.

John W. Walker 3-26-92
SIGNATURE DATE

Registration No. 16098

- Land Surveyor, Professional Engineer
 County Surveyor, County Engineer

OFFICE OF THE COUNTY RECORDER

County of Cass

I hereby certify that this document was filed in the Co. recorders office at 3:30 P.M. on the 10 day of December A.D., 1992

County Recorder Claudia Kayler
By ms Deputy

DOCUMENT NO. 343678

North Quarter Corner Section 23, Township 140 North, Range 29 West

The DNR Bureau of Engineering contacted the following for survey information:

Minnesota Secretary of State's Office
Cass County Surveyor's Office
Gary Stevenson, RLS, Walker, MN
Walt Curo, RLS, Hackensack, MN
Roger Mustonen, RLS, Hackensack, MN

- 1870 This corner was established by the U.S. General Land Office marked with a post and witnessed by the following bearing trees:
W. Pine, 24" North 20° East, 14 links (9.24')
R. Maple, 5" South 3° East, 53 links (34.98')
- 1922 Plat of the END O' THE TRAIL, SECOND ADDITION as surveyed by Egan, Field and Nowak, gives a distance of 1302.5 feet along the north line of the NW 1/4 - NW 1/4 of said Section 23, resulting in a total distance of 2605 feet.
- 1954 November, The plat of SUNNY ACRES as surveyed by Harold Curo shows this corner to be an iron monument.
- 1967 December, The plat of WILSON'S POINT as surveyed by W. J. Spain, Jr., shows this corner as an iron monument.
- 1981 County Surveyor, G. H. Stevenson, found a 3/4" iron pipe and took two ties:
Maple, 20" South 15° East, 35.35'
Maple, 8" North 75° West, 33.12'
He believes that the 20" Maple could possibly be an original BT.
- 1982 August, A field crew of the Department of Natural Resources, Bureau of Engineering (hereinafter referred to as the DNR-BOE), found a 3/4" iron pipe, flush with the ground, with the county ties in place.
- 1983 February, Computations by the office of the DNR-BOE found the distance west to the NW corner of Section 23 to be 2605.88.

The iron pipe is accepted as the quarter corner.
- 1991 Ties were taken as shown on the face of this certificate.