

CERTIFICATE OF LOCATION OF GOVERNMENT CORNER

North Quarter _____ Corner of Section 19, Township 141, Range 28, 5th P.M.
 STATE OF MINNESOTA, County of Cass

At the corner location shown on the sketch:

- On 7/7/92 found a 1 inch by 36 inch 1918 General Land Office
brass cap monument with 6 foot steel sign post along side
 left monument as found, lowered monument, removed monument (explain)
- On _____ placed a _____

Magnetic Decl: 5° East SKETCH OF REFERENCE TIES All distances are horizontal to nail in side of tree.
 Not to Scale

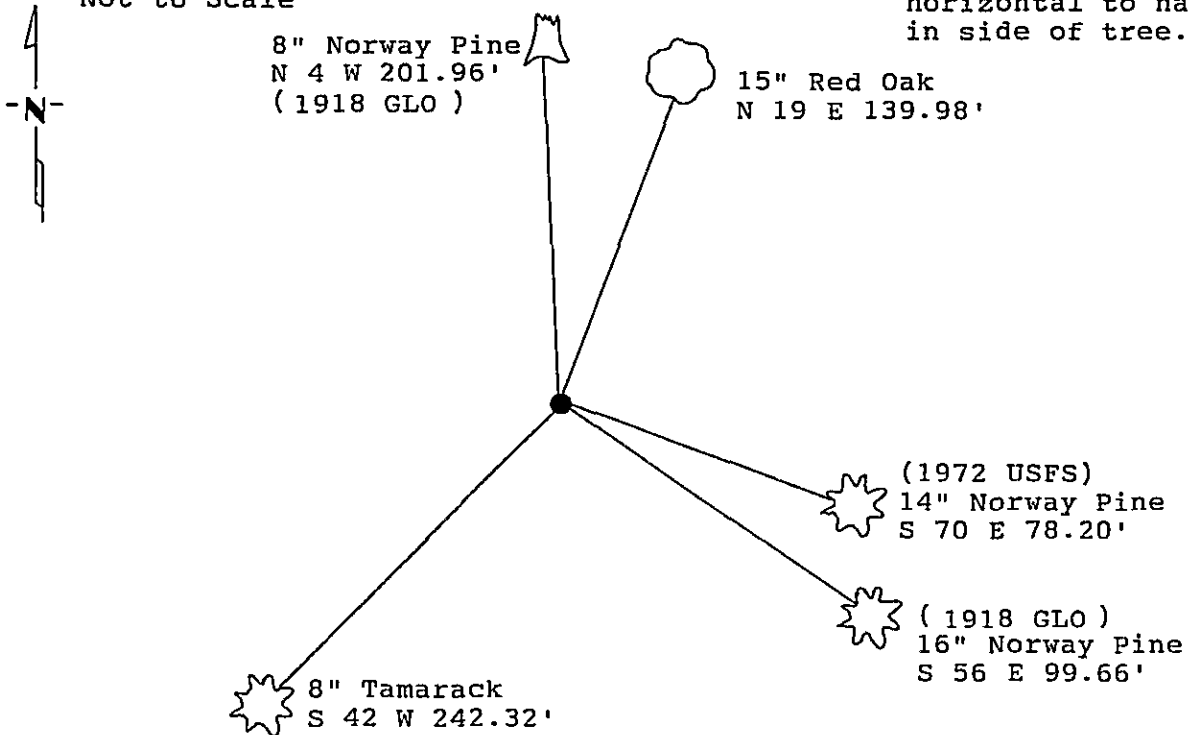

All bearing trees are scribed, painted with red enamel and marked with a 54-3 (bearing tree) tag.

Statement of evidence relative to this corner location is on back of page. 341348

I hereby certify that this survey, plan or report was prepared by me or under my direct supervision and that I am a duly Registered Land Surveyor under the laws of the State of Minnesota.

Terry L. Freeman
 Terry L. Freeman
 Date 9/18/92 Registration No. 21367

OFFICE OF THE COUNTY RECORDER
 County of Cass

I hereby certify that this document was filed in the Co. Recorders office at 9:40 A .M. on the 21 day of Sept A.D., 19 92
 County Recorder Clodie Kugel
 By m Deputy
 DOCUMENT NO. 341348

Statement of Evidence:

North Quarter corner, Section 19, Township 141 North,
Range 28 West, Cass County, Minnesota

N-3

1874 P.H. Conger, U.S. Deputy Surveyor, originally established this corner position while subdividing Township 141 North, Range 28 West. The notes indicate that he set a wood post. There were no trees available for bearing references.

1917 Cass County Surveyor's Office Record Book "C", Page 528 and microfilm roll 115, Book 77, Page 109, show a survey by E.B. Horst. The notes indicate that he set a 4 inch by 4 inch by 36 inch Poplar post for the Quarter corner at the proportionate position on the north line of Section 19. At the East One-sixteenth corner of Section 19 he set another 4 inch by 4 inch by 36 inch Poplar post and marked two bearing trees: a 4 inch Poplar North a distance of 9.0 feet; and a 3 inch Poplar West a distance of 8.2 feet.

1918 General Land Office records shows survey by Earl Harrington. The notes indicate that he set a 1 inch by 36 inch iron pipe with brass cap at proportional position between the Northeast and Northwest corners and marked the following bearing trees: a 6 inch Norway Pine South 56 and 1/4 degrees East a distance of 151 links (99.66 feet); and an 8 inch Norway Pine North 4 and 1/2 degrees West a distance of 306 links (201.96 feet).

1972 on November 15, United States Forest Service notes in Book 3 of Township 141 North, Range 28 West, Page 27 show survey by J. Ekstrom. The notes indicate that he found the 1918 General Land Office brass cap monument in good condition and the 1918 bearing trees: Norway Pine South 56 and 1/4 degrees East a distance of 99.66 feet, now 16 inches in diameter; and the 8 inch Norway Pine North 4 and 1/2 degrees West 201.96 feet, now a stump. He marked the following new bearing trees: a 14 inch Norway Pine South 70 degrees East a distance of 78.20 feet and a 19 inch Norway Pine South 62 degrees East a distance of 90.20 feet. A 6 foot steel sign post was set next to the corner with 54-2 and 54-4 signs.

1973 on April 10, William Okerman, Registered Land Surveyor Number 6807, filed a Certificate of Location of Government Corner Number 890 showing the 1972 United States Forest Service information.

1992 on July 7, a Landecker & Associates of Walker, Inc., survey crew found the 1918 General Land Office brass cap in good condition with 6 foot steel sign post directly wired to monument. They found the 1918 bearing trees: stump North 4 and 1/2 degrees West and 16 inch Norway Pine South 56 degrees East and 1972 United States Forest Service bearing tree: 14 inch Norway Pine South 70 degrees East and marked new bearing trees as shown on front of this certificate.