

CERTIFICATE OF LOCATION OF GOVERNMENT CORNER

Northeast Corner of Section 6, Township 141, Range 31, 5th P.M.

STATE OF MINNESOTA, County of Cass

At the corner location shown on the sketch:

On 10/10/90 found a 2 inch iron pipe with stamped brass cap up
DATE
19 inches

left monument as found, lowered monument, removed monument (explain)

On _____ placed a _____
DATE

Magnetic Decl: 5° East SKETCH OF REFERENCE TIES
 Not to Scale

All distances are horizontal to nail in side of tree

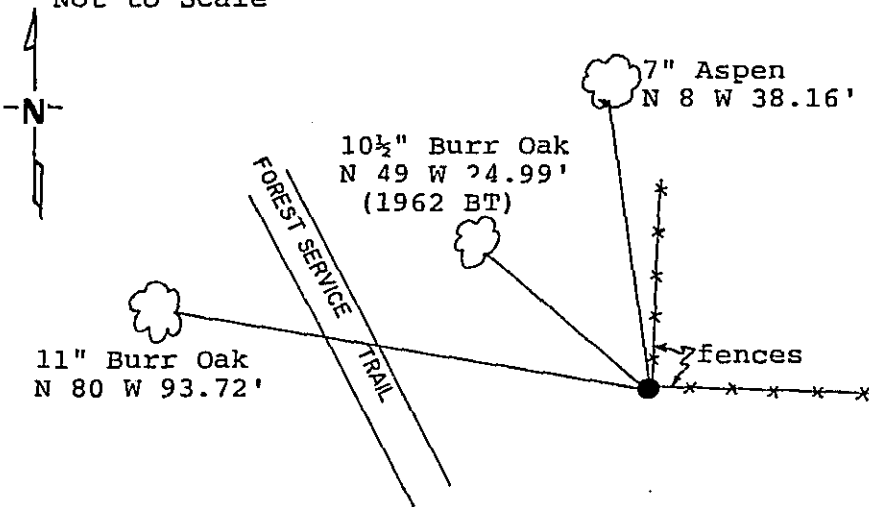

Monument Stamped
 T142N R31W
 S31 | S32
 S 6 | S 5
 T141N
 1962
 RLS 3628

- 8' steel sign post North 3.6'
- 8' steel sign post East 3.2'
- 8' steel sign post West 3.55'
- 8' steel sign post South 3.50'

Monument is located 4'± westerly of fence corner and 22'± easterly of Forest Service trail

All trees are scribed, painted with red enamel and marked with a 54-3 (bearing tree) tag.

Statement of evidence relative to this corner location is on back of page. 327281

I hereby certify that this document and the data contained herein was prepared by me or under my direct supervision.

Alvin A. Laska 3/6/91
SIGNATURE DATE

Registration No. 17008

- Land Surveyor, Professional Engineer
 County Surveyor, County Engineer

OFFICE OF THE REGISTER OF DEEDS

County of Cass

I hereby certify that this document was filed in the Reg. of Deeds office at 3:30 P. .M. on the 11 day of March A.D., 19 91

Register of Deeds Claudine Kayler

By m), Deputy

DOCUMENT NO. 327281

Northeast corner, Section 6, Township 141 North, Range
31 West, Cass County, Minnesota

A-5 141-31

1873 P.H. Conger, U.S. Deputy Surveyor, originally established this corner position while running the north line of Township 141 North, Range 31 West. The notes indicate a wood post was set to mark the corner position and the following witnesses: a 4 inch Poplar North 4 degrees East a distance of 68 links; a 14 inch Yellow Pine North 30 degrees West a distance of 100 links; a 6 inch Tamarak South 28 degrees West a distance of 42 links; and an 18 inch White Pine South 41 and 1/2 degrees East a distance of 142 links.

1917 County Surveyor's Record Book C, page 125, shows survey by E.B. Horst. An iron monument was set and the following bearing trees marked: a 12 inch White Pine North 47 degrees 15 minutes East a distance of 69.7 feet; a 12 inch Norway Pine North 79 degrees West a distance of 34.6 feet; a 12 inch Norway Pine South 87 degrees East a distance of 40.4 feet.

1919 County Surveyor's Record Book C, page 498, shows survey by E.B. Horst. The notes indicate an iron monument was found. The notes do not indicate that any bearing trees were marked.

1919 County resurvey in County Recorder's Office file cabinet E number 62 shows survey by E.B. Horst. The notes indicate an iron monument was found.

1925 County resurvey in County Recorder's Office file cabinet E number 62 shows survey by John Greene. The notes indicate an iron monument was set using a different method of proportioning the south line of Section 32 than that used by Horst in 1919. Greene re-established the south line of Section 32 and re-subdivided Section 32.

1962 USFS personnel, R.H. McDonald, found the 2 inch iron monument tipped over in trail alongside corner. He also found a metal location poster on a 10 inch Oak from 1937 stating corner is approximately 20 links East. This is alongside a fence corner on west edge of field. He set a 2 inch by 5 foot iron pipe with stamped bronze tablet and marked the following ties: an 8 inch Oak North 49 degrees West a distance of 24.9 feet; an 11 inch Oak South 78 degrees West a distance of 13.9 feet; a 6 foot sign post North 84 degrees East a distance of 3.05 feet.

1964 Pete Meyer, Licensed Land Surveyor Number 3628, files Affidavit as to location of Government corner using the 1962 information.

1978 USFS, Milo Stefan, Licensed Land Surveyor Number 12261, surveys in Section 5 and 6. He used the corner as monumented in 1962.

1990 Landecker & Associates, Inc. find corner and Northwest bearing tree as perpetuated by USFS in 1962 and accept position of the USFS monument as a perpetuation of the 1925 Greene survey as noted in the 1962 and 1978 USFS surveys.

1991 on January 28, a Landecker & Associates, Inc. survey crew mark two new bearing trees as shown and steel sign posts are in place as noted on front of this certificate.