

CERTIFICATE OF LOCATION OF GOVERNMENT CORNER

Northwest Corner of Section 30, Township 142, Range 31, 5th P.M.

STATE OF MINNESOTA, County of Cass

At the corner location shown on the sketch:

- On 1/5/91 found a Ash post with nail as set by USFS from
stumps ^{DATE} of all four original bearing trees
 left monument as found, lowered monument, removed monument (explain)
- On 2/1/91 placed a 2 inch by 48 inch iron pipe with brass cap
DATE

Magnetic Decl: 5° East SKETCH OF REFERENCE TIES
 Not to Scale

All distances are horizontal to nail in side of tree

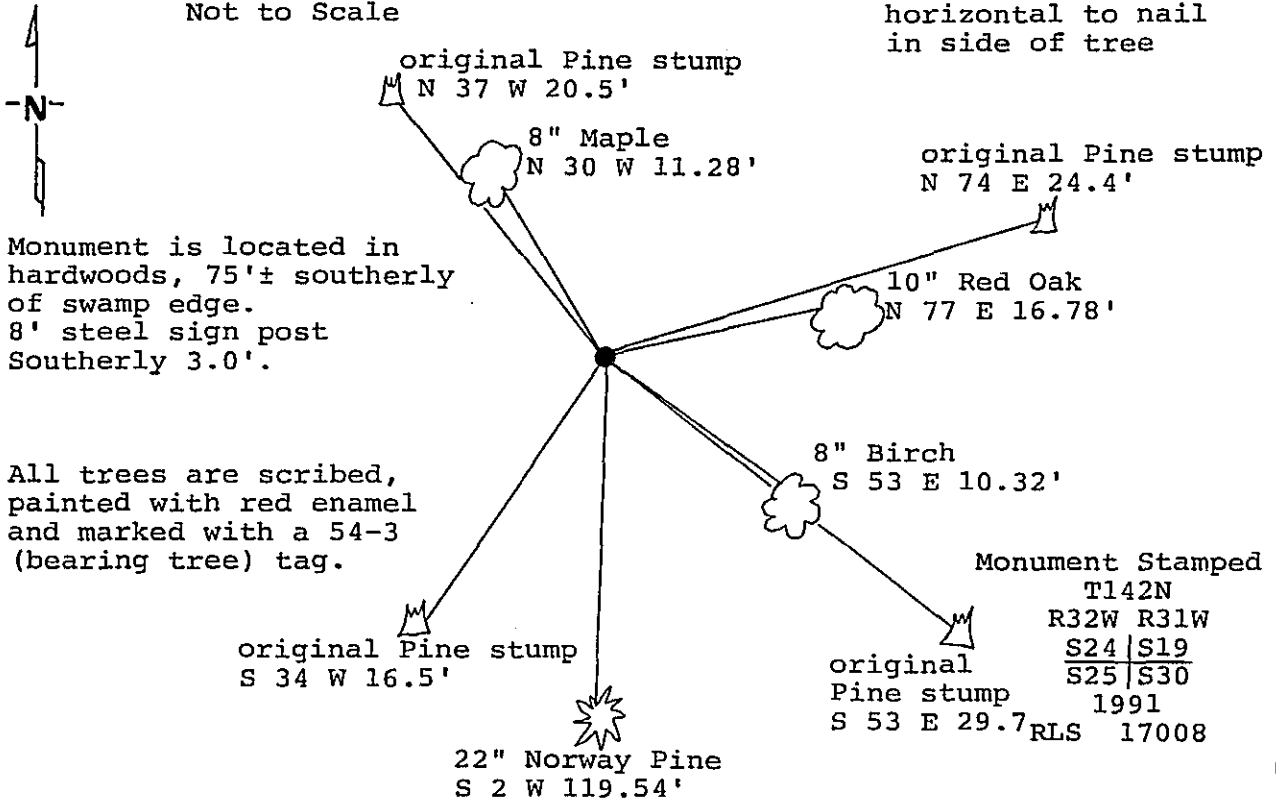

Statement of evidence relative to this corner location is on back of page. 327273

I hereby certify that this document and the data contained herein was prepared by me or under my direct supervision.

[Signature] 3/6/91
SIGNATURE DATE

Registration No. 17008

- Land Surveyor, Professional Engineer
- County Surveyor, County Engineer

OFFICE OF THE REGISTER OF DEEDS

County of Cass

I hereby certify that this document was filed in the Reg. of Deeds office at 2:50 P.M. on the 11 day of March A.D., 19 91

Register of Deeds Clondine Kayler

By [Signature], Deputy

DOCUMENT NO. 327273

Northwest corner, Section 30, Township 142 North,
Range 31 West, Cass County, Minnesota

R-1 142-31

1871 George Stuntz, U.S. Deputy Surveyor, originally established this corner position while running the West line of Township 142 North, Range 31 West. The notes indicate a wood post was set to mark the corner position and the following witnesses: a 20 inch Yellow Pine North 70 degrees East a distance of 37 links; a 25 inch White Pine South 58 degrees East a distance of 45 links; a 30 inch Yellow Pine South 30 degrees West a distance of 25 links; and a 10 inch White Pine North 25 degrees West a distance of 31 links.

1987-1988 United States Forest Service personnel search for corner. They find remains of all four original bearing trees (all stumps). All check for distance, check o.k. for bearing. They set a 3 inch Ash post with nail for corner and tie into traverse of the West line of the township.

1990-1991 Landecker & Associates, Inc. review search notes and traverse notes of USFS along East line of township. They accept the evidence as found by USES as establishing the corner in its obliterated position. Find Ash post with nail for corner and tie into their traverse of West township line. They find all four original GLO stumps as noted by the USFS. On February 1, 1991 the survey crew set a 2 inch by 48 inch iron pipe with bras cap up 12 inches. New bearing trees were marked as shown and a steel sign post set as noted on front of this certificate.