

# CERTIFICATE OF LOCATION OF GOVERNMENT CORNER

North Quarter Corner of Section 34, Township 143, Range 25, 5th P.M.

STATE OF MINNESOTA, County of Cass

At the corner location shown on the sketch:

On 10/26/90 found a 2½ inch aluminum capped monument 8 inches  
DATE  
above ground.

left monument as found,  lowered monument,  removed monument (explain)

On \_\_\_\_\_ placed a \_\_\_\_\_  
DATE

Magnetic Decl: 5° East SKETCH OF REFERENCE TIES  
 Not to Scale

All distances are horizontal to nail in side of tree

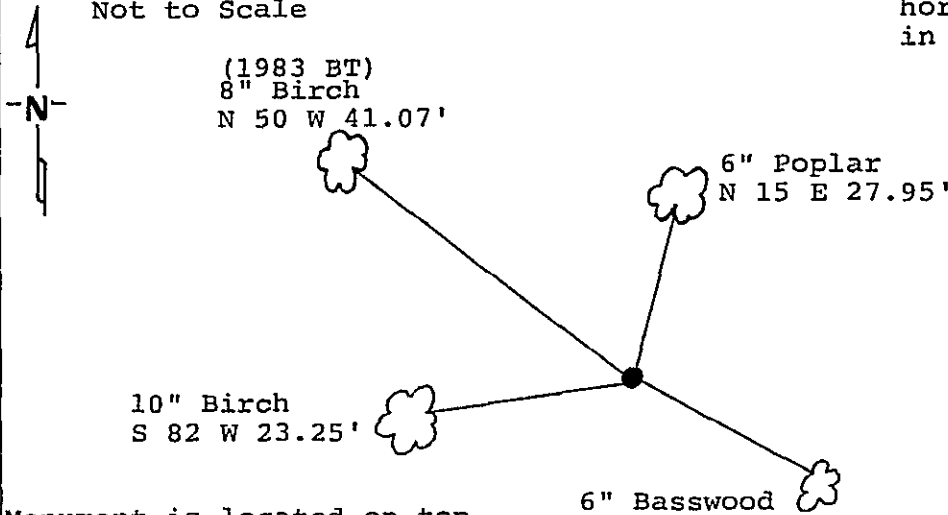

Monument is located on top of bank, 15' from crest, 25' from edge of Sugar Lake. 8' steel sign post 3.15' West.

Monument Stamped  
 Dept. of the Interior  
 Do Not Disturb  
 T143N R25W  
 S27  
 ¼ S34  
 1983  
 Cadastral Survey  
 Bur. of Land Management

All trees are painted with red enamel and marked with a 54-3 (Bearing Tree) tag.

Statement of evidence relative to this corner location is on back of page. 325279

I hereby certify that this document and the data contained herein was prepared by me or under my direct supervision.

*David A. ...* 11/28/90  
SIGNATURE DATE

Registration No. 17008  
 Land Surveyor,  Professional Engineer  
 County Surveyor,  County Engineer

OFFICE OF THE REGISTER OF DEEDS  
 County of Cass

I hereby certify that this document was filed in the Reg. of Deeds office at 4:10 P. M. on the 29 day of November A.D., 19 90

Register of Deeds *Claudine Keyler*  
 By m, Deputy

DOCUMENT NO. 325279

North Quarter corner, Section 34,  
Township 143 North, Range 25 West, Cass  
County, Minnesota

V-15

1872 Hayward and Griffin, U.S. Deputy Surveyors, originally established this corner position while subdividing Township 143 North, Range 25 West. The notes indicate a wood post was set to mark the corner position and the following witnesses: a 14 inch Cedar North 50 degrees East a distance of 6 links; and a 10 inch Birch South 60 and 1/2 degrees West a distance of 10 links.

1976 Bureau of Land Management dependent resurvey reestablished this corner proportionally. A 2 and 1/2 inch by 28 inch aluminum pipe with an aluminum cap was set to mark the corner. The following bearing trees were marked: a 10 inch Aspen South 2 degrees West a distance of 21 links (13.86 feet); and a 5 inch Balsam North 43 degrees West a distance of 11 and 1/2 links (7.59 feet).

1979 Gary Stevenson & Associates, Inc., survey crew found the 1976 Bureau of Land Management monuments around Section 34, Township 143 North, Range 25 West. They were used to subdivide said section. 1983 Mr. Stevenson alerted the Bureau of Land Management to information from a 1900 U.S. Corps of Engineers survey which could affect the Bureau of Land Management's 1976 survey in the township.

1983 Bureau of Land Management performed a corrective dependent resurvey based on Mr. Stevenson's 1983 notification. They removed and destroyed the corner and accessories marked in the 1976 Bureau of Land Management survey. A new 2 and 1/2 inch by 28 inch aluminum pipe with stamped brass cap was set to mark the corner. The following bearing trees were marked: a 10 inch Aspen South 45 degrees East a distance of 24 links (15.84 feet); and a 6 inch Birch North 43 degrees West a distance of 62 links (40.92 feet). The corners whereby this corner was proportioned from (the north) were reset due to the U.S. Corps of Engineers information that led to the recovery of original corners to the north and east of this section. Therefore, this corner was reset at the proportional position using this new information.

1990 on October 26, a Landecker & Associates, Inc., survey crew found the 2 and 1/2 inch aluminum capped monument 8 inches above ground as set by the Bureau of Land Management in 1983. Bearing trees are marked as shown and a steel sign post was set as noted on front of this certificate.