

# CERTIFICATE OF LOCATION OF GOVERNMENT CORNER

North Quarter \_\_\_\_\_ Corner of Section 23, Township 143N, Range 26W, 5th P.M.

STATE OF MINNESOTA, County of Cass

At the corner location shown on the sketch:

- On \_\_\_\_\_ found a \_\_\_\_\_  
DATE
- left monument as found,  lowered monument,  removed monument (explain)
- On 7/11/90 placed a 2 inch x 24 inch Brass cap monument 12.5 feet South  
DATE  
of centerline County Road Number 65.

Monument marked

T143N, R26W  
S14  
1/4  
S23  
1990  
RLS 17767

### SKETCH OF REFERENCE TIES

Not to scale

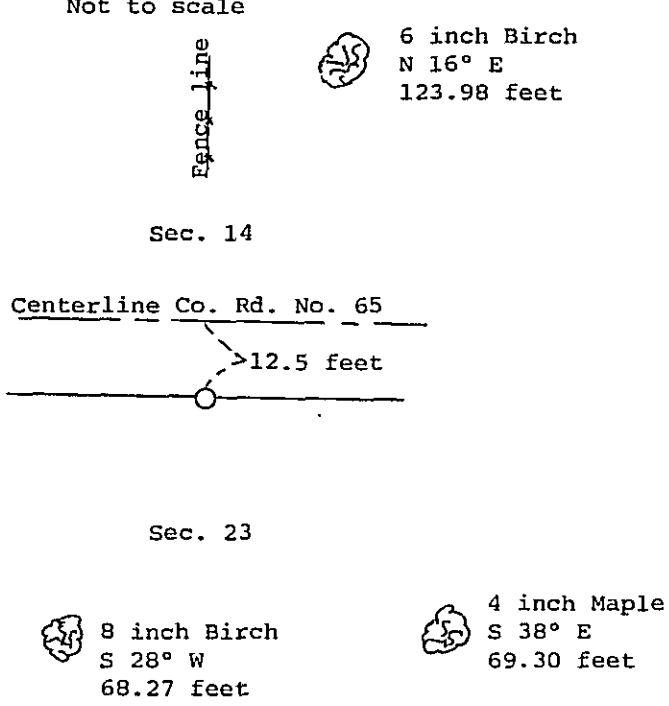

Sec. 14

Sec. 23

All bearings true

All trees are scribed, painted with a 30d spike in side, and USFS 54-3 tag.

Statement of evidence relative to this corner location is on back of page. 325141

I hereby certify that this survey, plan or report was prepared by me or under my direct supervision and that I am a duly Registered Land Surveyor under the laws of the State of Minnesota.

William C. Osborn  
Date 4/14/90 Registration No. 17767

OFFICE OF THE COUNTY RECORDER  
County of Cass

I hereby certify that this document was filed in the Co. Recorders office at 3:55 P..M. on the 21 day of November A.D., 19 90  
County Recorder Clondine Kayler  
By ms, Deputy  
DOCUMENT NO. 325141

Statement of Evidence:

N19 North quarter corner section 23

1/4 Cor. 14 and 23 (N 1/4 Cor. Sec. 23)

- 1872 U.S. General Land Office survey set wood post for corner and the following references were noted:  
Fir 12" N 15 degrees E, 10 Links ( 6.60 feet)  
Birch 8" S 78 degrees W, 20 Links (13.20 feet)
- 1915-1916 Geo. Ralph, Cass County Engineer, Survey Record No. 261, Book B, Page 98, states corner found, also the following witness:  
Birch 12" S 78 degrees W, 18.5 feet  
also lists following new witnesses:  
Spruce 8" N 16 degrees 30 minutes W, 59 feet  
Tamarack 8" S 4 degrees 30 minutes W, 51 feet
- 1962 circa Cass County Highway Department County Road #65 map shows assumed corner at southerly extension of fence line to the north.
- 1969 Curt Krause, USFS, searched area, no evidence of corner, or BT's found, new construction and power company clearing have taken all evidence.
- 5-13-1990 Personnel from Kovanen & Osufsen Inc. traverse to area and search, no evidence found, road construction has destroyed all evidence.
- 7-11-1990 Personnel from Kovanen & Osufsen Inc. and Rob Main, USFS set a 2" x 24" brass capped monument 12.5 feet south of centerline of County Road Number 65. The position was established latitudinally from the old centerline alignment as scaled from 1962 circa road plan of County Road Number 65 and longitudinally by the southerly extension of an old fence line to the north. They then established following witnesses:  
Birch 6" N 16 degrees E, 123.98 feet  
Maple 4" S 38 degrees E, 69.30 feet  
Birch 8" S 28 degrees W, 68.27 feet

This position is not traceable to the original GLO corner, but accepted as corner for lack of further evidence.