

CERTIFICATE OF LOCATION OF GOVERNMENT CORNER

East Quarter Corner of Section 18, Township 140, Range 29, 5th P.M.

STATE OF MINNESOTA, County of CASS

At the corner location shown on the sketch:

- On 8-25-81 found a 1 1/2" Iron Pipe (up 1.1') in the Water
DATE
- left monument as found, lowered monument, removed monument (explain)
- On _____ placed a _____
DATE

SKETCH OF REFERENCE TIES

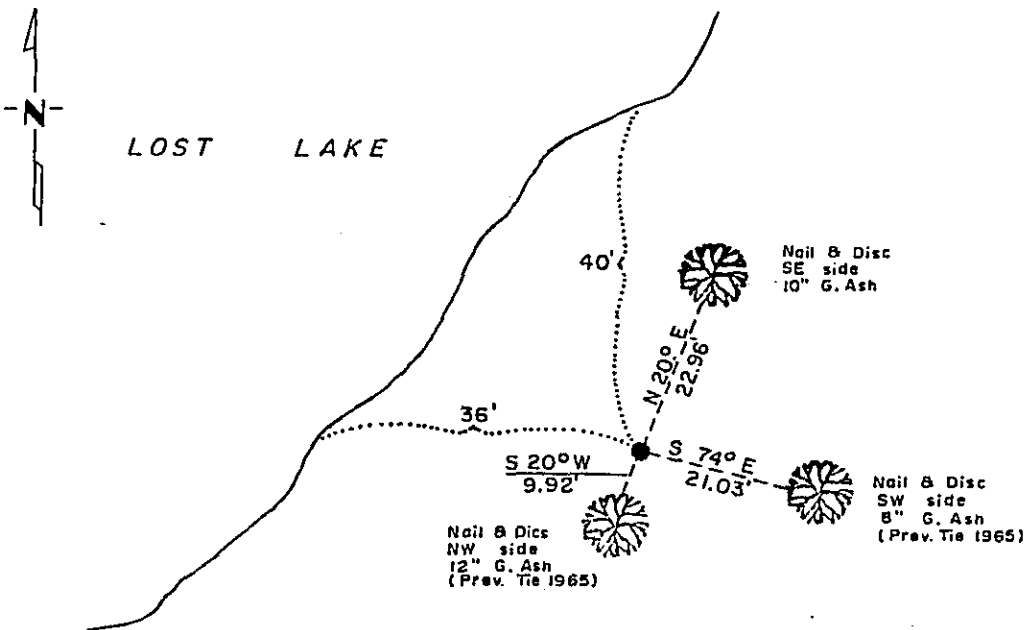

NOTE: Bearings observed with compass

Statement of evidence relative to this corner location is on back of page. FILE A-338 J.A.G.

I hereby certify that this document and the data contained herein was prepared by me or under my direct supervision.

John D. Walker 11-8-90
SIGNATURE DATE

Registration No. 16098

- Land Surveyor, Professional Engineer
- County Surveyor, County Engineer

OFFICE OF THE REGISTER OF DEEDS
County of Cass

I hereby certify that this document was filed in the Reg. of Deeds office at 1:50 P.M. on the 14 day of November A.D., 19 90

Register of Deeds B. Christine Keyler
By m, Deputy

DOCUMENT NO. 324961

East Quarter Corner of Section 18, Township 140 North, Range 29 West

The following offices were contacted for information on this corner:

Minnesota Secretary of State
Cass County Recorder
Cass County Surveyor

1870 The US General Land Office field notes state that they set a post and measured to two bearing trees.

In Book C on page 204, survey number 423 by E.B. Horst on an unknown date, presumed to be in the early 1900's, conducted a survey of the east-west quarter line of said section 18. Horst considered this corner to be obliterated and re-established the corner by intersecting two blazed lines which were run from this corner and bearing trees by Byron B. Bartleth, a presumed previous surveyor. Horst's notes do not state type of monument set. Horst gives a distance of 5584.4 feet for the east-west quarter line of said section 18.

Robert Schneider, County Surveyor, on an unknown date, conducted a survey in said section 18 and found a 2" iron pipe projecting 12". He accepted the pipe as the quarter corner and took ties.

1981 On August 25, the DNR Bureau of Engineering searched the area and found a 1 1/2" inside diameter iron pipe and two of Robert Schneider's tie trees. This iron pipe was accepted as the east quarter corner of said Section 18 and additional ties were measured as shown and described on this certificate.