

CERTIFICATE OF LOCATION OF GOVERNMENT CORNER

Northeast Corner of Section 16, Township 143N, Range 26W, 5th P.M.

STATE OF MINNESOTA, County of Cass

At the corner location shown on the sketch:

- On 1-15-1990 found a 2" X 36" Brass capped monument
DATE
- left monument as found, lowered monument, removed monument (explain)
- On _____ placed a _____
DATE

Monument Marked

SKETCH OF REFERENCE TIES
not to scale

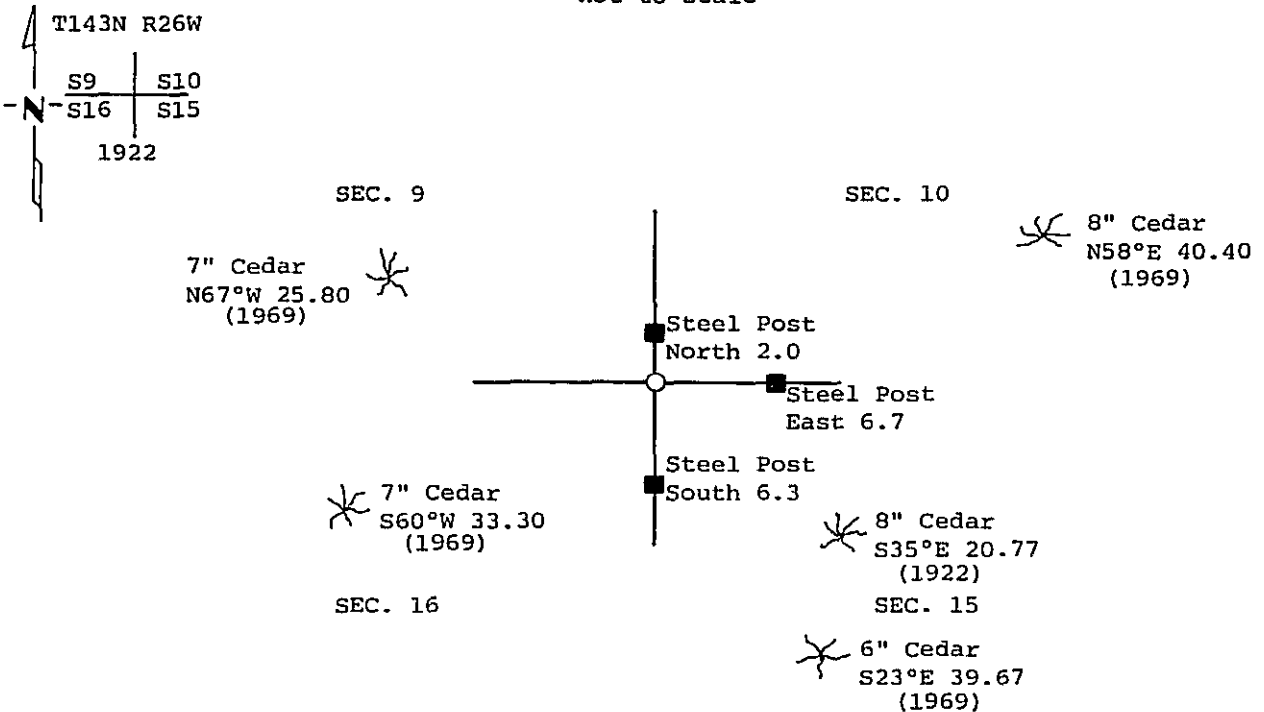

bearings are true All trees are scribed, painted with a 30d spike in side and USFS 54-3 tag.

Statement of evidence relative to this corner location is on back of page.

319612

I hereby certify that this survey, plan or report was prepared by me or under my direct supervision and that I am a duly Registered Land Surveyor under the laws of the State of Minnesota.

William C. Osipow

Date 3/20/90 Registration No. 17767

OFFICE OF THE COUNTY RECORDER

County of Cass

I hereby certify that this document was filed in the Co. Recorders office at 9:50 A. M. on the 12 day of April A.D., 19 90

County Recorder Claudine Kaylor

By mv, Deputy

DOCUMENT NO. 319612

Statement of Evidence:

J13 Northeast corner section 16

Cor. 9,10,15 and 16 (NE Cor. Sec. 16)

- 1872 U.S. General Land Office survey set wood post for corner and the following references were noted:
Tamarack 13" N 25 degrees E, 30 Links (19.90 feet)
Tamarack 10" N 9 degrees W, 25 Links (16.50 feet)
Tamarack 10" S 29 degrees E, 50 Links (33.00 feet)
Tamarack 8" S 17 degrees W, 32 Links (21.12 feet)
- 1900 U.S. Corps of Engineers map of the Pokegama Reservoir, indicates corner in place.
- 1922 General Land Office survey found no post, found references;
Tamarack(dead) 14" N 35 degrees E, 29 Links
Tamarack(stump) 16" S 18 degrees 30 minutes E, 50 Links
Tamarack(stump) 14" S 19 degrees W, 40 Links
Tamarack(stump) 12" N 29 degrees 30 minutes W, 25 Links
they set a 36" X 2" iron post with brass cap and the following references:
Cedar 6" N 31 degrees 30 minutes E, 27 Links (17.82)
Cedar 6" S 35 degrees 30 minutes E, 34 Links (22.44)
Cedar 7" S 11 degrees 30 minutes W, 28 Links (18.48)
Cedar 7" N 6 degrees 45 minutes W, 36 Links (23.76)
- 1969 U.S.F.S. found G.L.O. monument in good condition and 1922 BT's
Cedar 6" N 31 degrees 30 minutes E, 27 Links now 14"
Cedar 6" S 35 degrees 30 minutes E, 34 Links now 9"
Cedar 7" S 11 degrees 30 minutes W, 28 Links fallen
Cedar 7" N 6 degrees 45 minutes W, 36 Links fallen
they added the following references:
Cedar 8" N 58 degrees E, 40.40 feet
Cedar 6" N 67 degrees W, 25.80 feet
Cedar 7" S 60 degrees W, 33.30 feet
Cedar 5" S 23 degrees E, 39.35 feet
- 1-15-1990 Personnel from Kovanen & Osufsen Inc. found G.L.O. monument leaning northeast, and U.S.F.S. BT's;
Cedar 8" N 58 degrees E, 40.40 feet
Cedar 6" N 67 degrees W, 25.80 feet
Cedar 7" S 60 degrees W, 33.30 feet
Cedar 5" S 23 degrees E, 39.35 feet
Cedar 6" S 35 degrees E, 22.44 feet (1922 BT leans NW)
straighten monument, and added spike to following BT's:
Cedar 8" N 58 degrees E, 40.40 feet
Cedar 7" N 67 degrees W, 25.80 feet
Cedar 7" S 60 degrees W, 33.30 feet
Cedar 5" S 23 degrees E, 39.67 feet
Cedar 9" S 35 degrees E, 20.77 feet (1922 BT)
Set 8' long steel sign post with sign attached, South 6.3 feet
Set 8' long steel sign post with sign attached, East 6.7 feet

This position is a perpetuation of the GLO corner.