

CERTIFICATE OF LOCATION OF GOVERNMENT CORNER

Northeast Corner of Section 3, Township 143N, Range 26W, 5th P.M.

STATE OF MINNESOTA, County of Cass

At the corner location shown on the sketch:

On 10-26-1989 found a 2" x 36" brass capped monument
DATE

left monument as found, lowered monument, removed monument (explain)

On _____ placed a _____
DATE

Monument Marked

SKETCH OF REFERENCE TIES

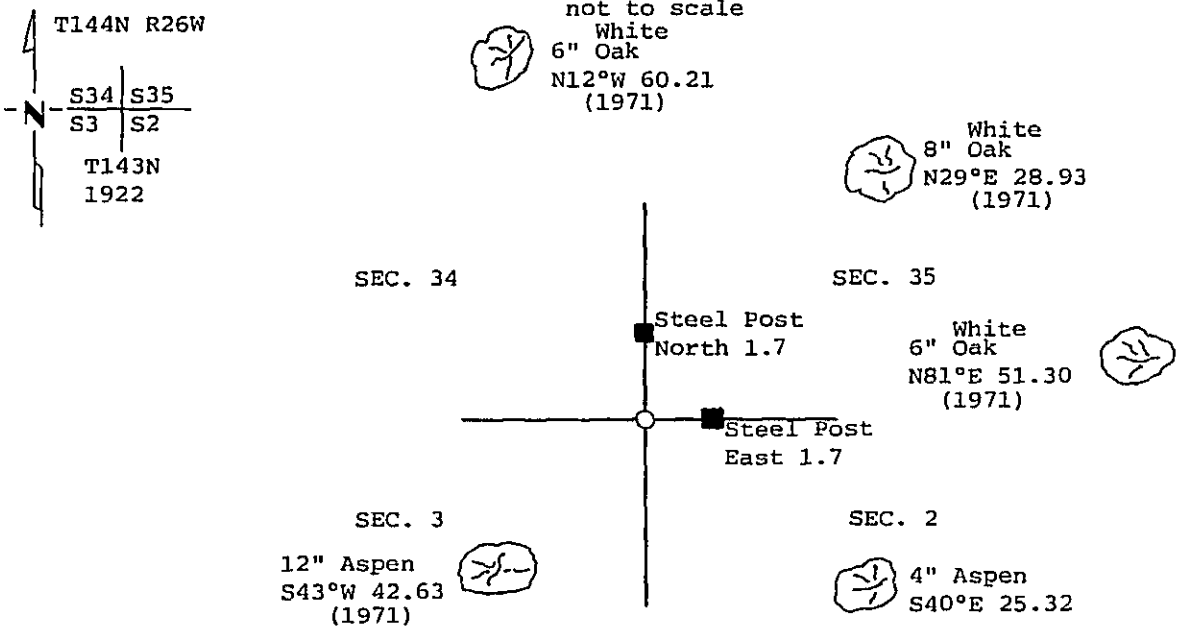

All trees are scribed, painted with a 30d spike in side and USFS 54-3 tag.

bearings are true

Statement of evidence relative to this corner location is on back of page. 319605

I hereby certify that this survey, plan or report was prepared by me or under my direct supervision and that I am a duly Registered Land Surveyor under the laws of the State of Minnesota.

William C. Osanpan

Date 3/20/90 Registration No. 17767

OFFICE OF THE COUNTY RECORDER

County of Cass

I hereby certify that this document was filed in the Co. Recorders office at 9:15 A. A.M. on the 12 day of April A.D., 1990

County Recorder Claudia Kayler

By M.S. Deputy

DOCUMENT NO. 319605

Statement of Evidence:

A17 Northeast corner of section 3

Cor. 2,3,34 and 35 (NE Cor. Sec. 3)

- 1872 U.S. General Land Office survey set wood post for corner, the following references were noted:
Spruce 14° S 47 degrees W, 20 Links (13.20 feet)
Spruce 5° S 45 degrees E, 14 Links (9.24 feet)
Spruce 6° N 66 degrees E, 5 Links (3.30 feet)
Spruce 8° N 8 degrees W, 25 Links (16.50 feet)
- 1900 U.S. Corps of Engineers map of the Pokegama Reservoir, indicates corner in place.
- 1919 James Flynn, Cass County Book C, Page 179, found following BT's:
Spruce stump 5° S 45 degrees E, 14 Links
Spruce stump 6° N 66 degrees E, 5 Links
Spruce stump 8° N 8 degrees W, 25 Links
He set corner post and witnessed as follows:
Balm of Gilead 17° N 42 degrees 30 minutes W, 47.5 feet
Balm of Gilead 14° S 81 degrees 30 minutes W, 26.8 feet
Cedar 9° N 44 degrees E, 47.8 feet
Cedar 10° S 24 degrees E, 30.5 feet
- 1922 GLO Resurvey, found cedar post and following BT's:
Spruce stump 6° S 46 degrees E, 14 Links
Spruce stump 9° N 66 degrees E, 6 Links
Spruce stump root N 4 degrees W, 27 Links
they set a 2"x 36" steel pipe with brass cap along side cedar post and witnessed as follows:
Maple 12° N 30 degrees 45 minutes E, 117 Links (77.22 feet)
Spruce 6° S 3 degrees E, 80 Links (52.80 feet)
Tamarack 8° S 55 degrees 45 minutes W, 74 Links (49.84 feet)
Basswood 14° N 43 degrees W, 90 Links (59.40 feet)
- 1971 USFS found 1922 BLM monument in good condition and established the following witnesses:
White Oak 5° N 14 degrees W, 60.10 feet
White Oak 5° N 28 degrees E, 28.80 feet
White Oak 5° N 79 degrees E, 51.50 feet
Aspen 3° S 43 degrees W, 42.60 feet
Steel sign post with sign attached, North 1.5 feet
Steel sign post with sign attached, East 2.0 feet
- 12-6-1979 A Certificate of location of Government corner was filed for record in the Cass County Recorders Office from the 1971 USFS information by Milo E. Stefan, RLS, as Doc. No. 246225.
- 10-26-1989 Personnel from Kovanen & Osufsen Inc. found 1922 GLO monument in good condition and USFS witnesses as follow:
White Oak 6° N 12 degrees W, 60.21 feet, spike in W. face
White Oak 8° N 29 degrees E, 28.93 feet, spike in W. face
White Oak 5° N 81 degrees E, 51.30 feet, spike in N. face
Aspen 12° S 43 degrees W, 42.63 feet, spike in SE face
Steel sign post with sign attached, North 1.7 feet
Steel sign post with sign attached, East 1.7 feet
we add witness as follow:
Aspen 4° S 40 degrees E, 25.32 feet

This position is traceable to the original GLO corner.