

CERTIFICATE OF LOCATION OF GOVERNMENT CORNER

Northeast Corner of Section 13, Township 141N., Range 27W., 5th P.M.

STATE OF MINNESOTA, County of Cass

At the corner location shown on the sketch:

- On 7/8/87 found a 6" diameter concrete post with a brass cap 4" below the water in a grass marsh.
DATE
 - left monument as found, lowered monument, removed monument (explain)
- On 12/22/87 ~~placed~~ raised monument now 1' above the surface
DATE

SKETCH OF REFERENCE TIES

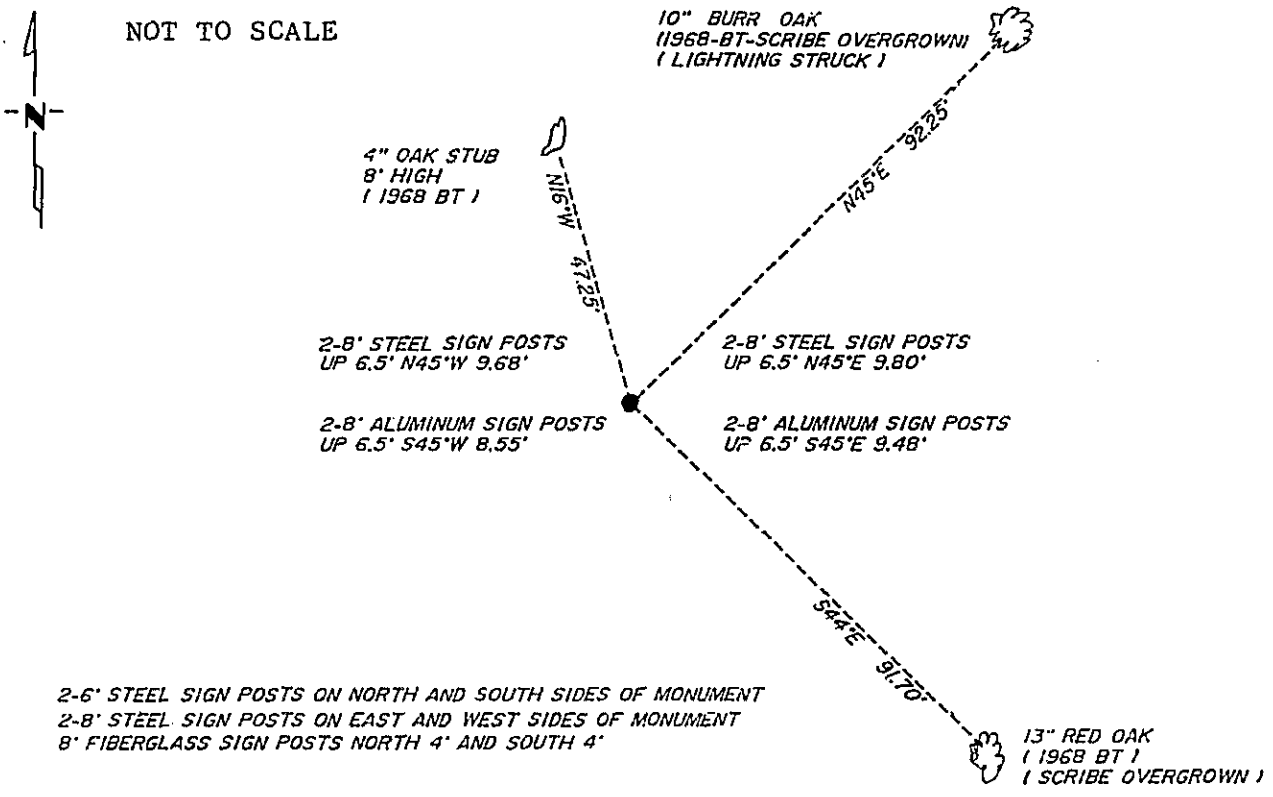

Statement of evidence relative to this corner location is on back of page. 318884

I hereby certify that this document and the data contained herein was prepared by me or under my direct supervision.

Walter E. Cass 2-28-90
SIGNATURE DATE

Registration No. 11395

Land Surveyor

County Surveyor

OFFICE OF THE COUNTY RECORDER

County of Cass

I hereby certify that this document was filed in the Co. Recorders office at 4:00 P.M. on the 6 day of March A.D., 19 90

County Recorder Clodine Kayser

By MJ, Deputy

DOCUMENT NO. 318884

Northeast Corner, Section 13, 141N., R.27W., 5th P.M.

- 1871 U.S. General Land Office survey set a wood post for this corner and marked the following bearing trees: a 16" Elm S5W 28 links, a 14" Birch N70E 51 links, and an 8" Fir N18W 32 links.
- 1936 C.C.C. notes by H. Adams show that he found a wood post in poor condition 26" high. The notes also mention an 18" Basswood S51W 66 with a Forest Service Location Poster. The corner was located in a small pot hole at the end of the road.
- 1967 U.S. Forest Service personnel found a burned off scribed post at ground level with a 1" iron pipe alongside and also found a scribed 20" Basswood "S51E 66.0'".
- 1968 William Okerman filed an affidavit as to the location of the government corner. He notes the evidence found in 1967 and set a 6" diameter by 5' long concrete cylinder with a 3" stamped brass tablet. The following bearings were marked: a 10" Oak S44E 91.9' scribed "S18 BT", a 7" White Oak S24W 72.45' scribed "S13 BT", a 9" White Oak N45E 92.3' scribed "S7 BT", and a 4" White Oak N16W 47.3' scribed "X BT".
- 1987 On July 8, Curt Krause a U.S. Forest Service Technician and Cass County Survey Technician found a 6" concrete monument 4" under the water in the grass marsh. They placed 2-6' steel sign posts alongside the monument to stabilize it. An 18" Basswood to the southeast is a tipout. The Oak to the southeast is now 13" and the Oak to the northeast is 10" and was struck by lightning. The Oak to the northwest is a 4" stub cut off 8' high and an Oak southwest is wind fallen and cut-off by beavers. The 1968 Oaks to the northeast and the southeast are the only good trees available. They placed doubled 8' steel posts to the northeast, northwest, southeast, and to the southwest with 6½' sticking out of the marsh. An 8' fiberglass sign posts was placed due north and an 8' fiberglass sign post was placed due south both at a distance of 4'.
- 1987 On December 22, Curt Krause and Terry Freeman raised monument and placed a wood stake underneath it so it is now 1' out of the marsh.