

CERTIFICATE OF LOCATION OF GOVERNMENT CORNER

Meander _____ Corner of Section 36, Township 141 N, Range 31 W, 5th P.M.

STATE OF MINNESOTA, County of Cass

At the corner location shown on the sketch: Latitude: 46° 59' 28.706"
 Longitude: 94° 32' 06.791"

On 10/18/88 found a 2 inch by 48 inch iron monument
DATE

left monument as found, lowered monument, removed monument (explain)

On 1/26/89 placed a 10' aluminum rod with stamped aluminum cap.
DATE
Placed found iron on East side of rod. (rod is 3/4" diameter)

Magnetic Decl: 5° East SKETCH OF REFERENCE TIES
 Not to Scale

All distances are horizontal to nail in side of tree.

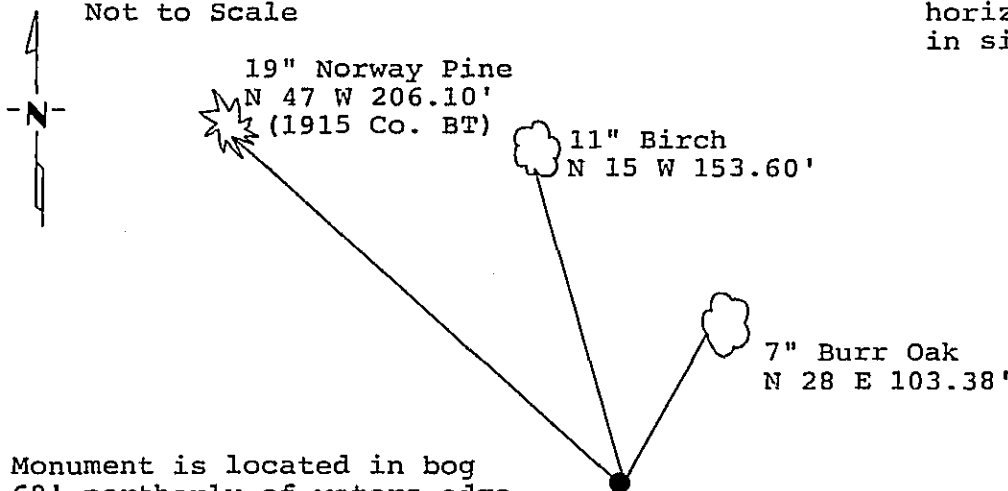

Monument is located in bog 68' northerly of waters edge of Ten Mile Lake.
 (2) 8' steel sign posts, bolted together, North 2.0' with sign 54-9.

Monument Stamped
 T141N
 R31W R30W
 S36 | S31
 MC
 1989
 RLS 17008

All trees are painted with red enamel and marked with a 54-3 (bearing tree) tag.

Statement of evidence relative to this corner location is on back of page.

I hereby certify that this survey, plan or report was prepared by me or under my direct supervision and that I am a duly Registered Land Surveyor under the laws of the State of Minnesota

David S. Landecker
 David S. Landecker

Date 9-15-89 Registration No. 17008

315247
 OFFICE OF THE COUNTY RECORDER
 County of Cass

I hereby certify that this document was filed in the Co. Recorders office at 1:20 P. M. on the 21 day of Sept A.D., 19 89

County Recorder Claudia Kayser

By _____, Deputy

DOCUMENT NO. 315247

Statement of Evidence:

Meander Corner Number 5, Section 36, Township 141 North, Range 31 West, Cass County, Minnesota

WX-25 141-31
Bk.5 Pg.66

1873 P.H. Conger, U.S. Deputy Surveyor, originally established this corner position while running the east line of Township 141 North, Range 31 West. The notes indicate a wood post was set to mark the corner position and the following witnesses: a 20 inch White Pine North 9 degrees 30 minutes West a distance of 120 links; and a 14 inch Aspen North 2 degrees 30 minutes East a distance of 177 links.

1915 County Surveyor's Record Book B pages 64-67 show survey by John Curo. He found the old Government bearing trees, Aspen stump and downed 20 inch White Pine, and set a 2 inch by 48 inch galvanized pipe with cap. He marked new ties: an 8 inch Poplar North 22 degrees 10 minutes East 85.3 feet; and a 12 inch Norway Pine North 47 degrees 07 minutes West 207.1 feet.

1963 John Stark, plats BIRCH ACRES, and uses the 1915 Curo monument.

1986 U.S. Forest Service crews set an aerial target over this corner position for determination of coordinate values through the use of GPS on the Chippewa South Boundary Project Cadastral Survey U.S. Project Number 53-6392-8-219. This target allowed for the search and location of this corner.

1988 on October 18 a Landecker-Stevenson & Associates crew visited the corner and found the following evidence: a 2 inch by 48 inch iron pipe monument and 1915 Norway Pine bearing tree now 19 inches at recorded bearing and distance.

1989 on January 26 a Landecker-Stevenson & Associates crew removed the 2 inch by 48 inch capped iron pipe and set a 10 foot length of aluminum rod with stamped aluminum cap. Set old monument on easterly side of aluminum rod. New bearing trees were marked as shown and steel sign posts set as noted on front of this certificate.

NOTE: This certificate is filed to correct the Section number as shown on the top line on the back side of that Certificate of Location of Government Corner filed on March 14, 1989 as Document Number 310881.