

CERTIFICATE OF LOCATION OF GOVERNMENT CORNER

Number 9 Meander Corner of Section 35, Township 141 N, Range 29 W, 5th P.M.

STATE OF MINNESOTA, County of Cass

At the corner location shown on the sketch: Latitude: 46° 58' 46.014"
 Longitude: 94° 19' 15.545"

On 10/25/88 found a both original Pine bearing tree stumps
DATE

left monument as found, lowered monument, removed monument (explain)

On 3/17/89 placed a 2 inch by 48 inch iron pipe with brass cap
and plastic base with magnet.
DATE

Magnetic Decl: 5° East SKETCH OF REFERENCE TIES
 Not to Scale

All distances are horizontal to nail in side of tree.

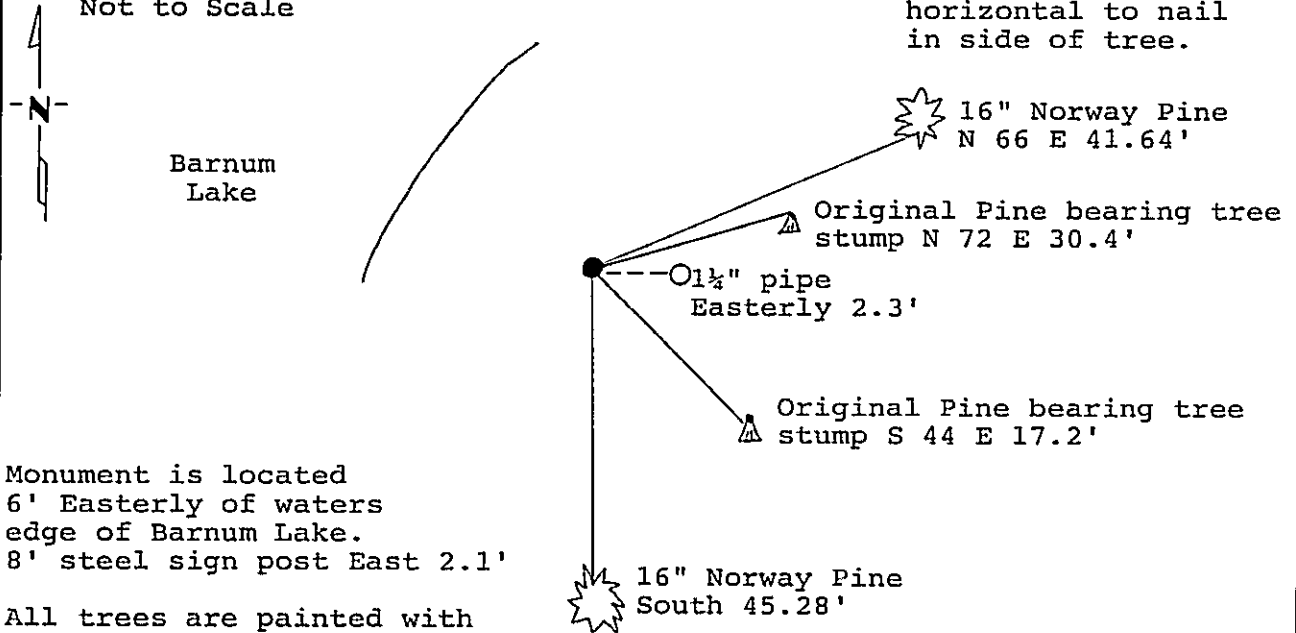

Monument is located
 6' Easterly of waters
 edge of Barnum Lake.
 8' steel sign post East 2.1'

All trees are painted with red enamel and marked with a 54-3 (bearing tree) tag.

Monument Stamped
 R29W
 MC $\begin{matrix} \text{S35} & \text{T141N} \\ \text{S3} & \text{T140N} \end{matrix}$
 1989
 RLS 17008

Statement of evidence relative to this corner location is on back of page.

311953

I hereby certify that this survey, plan or report was prepared by me or under my direct supervision and that I am a duly Registered Land Surveyor under the laws of the State of Minnesota.

David S. Landecker
 David S. Landecker

Date 5-1-89 Registration No. 17008

OFFICE OF THE COUNTY RECORDER

County of Cass

I hereby certify that this document was filed in the Co. Recorders office at 10:25 A.M. on the 9 day of May A.D., 1989

County Recorder Claudine Kayler

By M.S., Deputy

DOCUMENT NO. 311953

Statement of Evidence:

Meander Corner Number 9 Section 35, Township 141
North, Range 29 West, Cass County, Minnesota

Z17-18 141-29
Bk.6 Pg.34

1863 Johnson and Thornton, U.S. Deputy Surveyors, originally established this corner position while running the 10th Standard Parallel. The notes indicate a wood post was set to mark the corner position and the following witnesses: a 14 inch Yellow Pine North 72 degrees East a distance of 46 links; and a 15 inch Yellow Pine South 44 degrees East a distance of 26 links.

1915 County Surveyor's Record Book C page 235 show survey by Frank Donner. He found both Government bearing tree stumps; set a 4 by 4 by 36 inch Birch post.

1986 U.S. Forest Service records show the following: Forest Service technicians and County survey technician find both original bearing tree stumps, Northeast has blazing and scribing.

1988 a Landecker-Stevenson & Associates crew visited the corner and found the following evidence: both 1863 bearing tree stumps, Northeast has blaze and scribing, set rebar at original bearing and distance from which a 1 and 1/4 inch iron pipe is Easterly 2.3 feet.

1989 on March 17 a Landecker-Stevenson & Associates crew set a 2 inch by 48 inch iron pipe with brass cap, plastic base and magnet from the stumps of both original bearing trees. New bearing trees were marked as shown and a steel sign post was set as noted on front of this certificate.