

**CERTIFICATE OF LOCATION OF GOVERNMENT CORNER**

Standard

South Quarter Corner of Section 33, Township 141 N, Range 30 W, 5th P.M.STATE OF MINNESOTA, County of Cass

At the corner location shown on the sketch:

Latitude: 46° 58' 48.301"Longitude: 94° 28' 51.509"

On 8/29/88 found a 2 inch iron pipe  
DATE  
 (replaced below)

left monument as found,  lowered monument,  removed monument (explain)

On 9/28/88 placed a 2 inch by 24 inch iron pipe with brass cap.  
DATE

Magnetic Decl: 5° East  
Not to Scale

SKETCH OF REFERENCE TIES

All distances are horizontal to nail in side of tree.

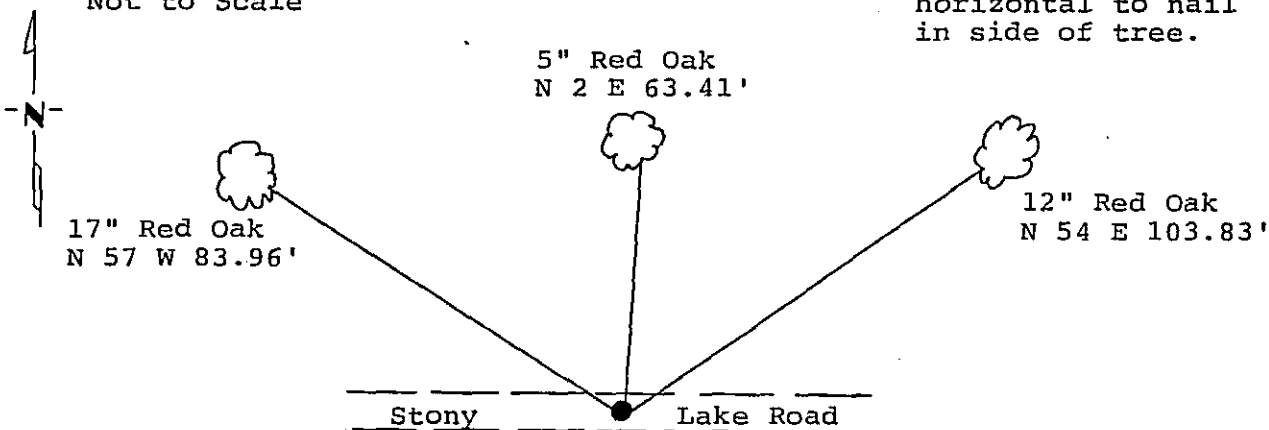

Monument is located  
 in centerline of  
 Stony Lake Road  
 8' Sign post North 25.0'  
 8' Sign post North-  
 Northeasterly 25.0'

Monument Stamped  
 R 30 W  
 SC  
 1/4 S 33 T141N  
 T140N  
 1988  
 RLS 17008

All trees are painted with red enamel and  
 marked with a 54-3 (bearing tree) tag.

Statement of evidence relative to this corner location is on back of page.

I hereby certify that this survey, plan or  
 report was prepared by me or under my  
 direct supervision and that I am a duly  
 Registered Land Surveyor under the laws  
 of the State of Minnesota.

David S. Landecker  
 David S. Landecker  
 Date 3/31/89 Registration No. 17008

311187  
 OFFICE OF THE COUNTY RECORDER  
 County of Cass

I hereby certify that this document was filed in  
 the Co. Recorders office at 1:25 P. .M. on the  
3rd day of April A.D., 1989

County Recorder Claudine Kayler  
 By AK, Deputy

DOCUMENT NO. 311187

Statement of Evidence:

Standard South Quarter Corner Section 33,  
Township 141 North, Range 30 West, Cass County,  
Minnesota

Z-11 141-30  
Bk.9 Pg.3

1863 Johnson and Thornton, U.S. Deputy Surveyors, originally established this corner position while running the 10th Standard Parallel. The notes indicate a wood post was set to mark the corner position and the following witnesses: a 10 inch Aspen North 55 degrees West a distance of 36 links; and a 11 inch Aspen North 20 degrees East a distance of 33 links.

1938 Civilian Conservation Corps show corner in place presumed to be that as set by the County because of the type of monument found. Their notes show measurements East along standard parallel from Southeast corner said Section 33, and along the South line of Section 34 said township. No records of a County survey can be found.

1964 U.S. Forest Service records show the following: technician Ekstrom chained from the Southwest Corner of 33 and found no evidence.

1986 U.S. Forest Service crews set an aerial target in the vicinity of this corner for the search and establishment of the true corner position. The target having coordinate values through the use of GPS on the Chippewa South Boundary Project Cadastral Survey U.S. Project Number 53-6392-8-219. This target allowed for the search and location of this corner.

1988 on August 29 and September 13 a Landecker-Stevenson & Associates crew searched for the corner. The following information was found and noted: a 2 inch iron pipe with top slightly bent East. Monument appears to be same type as used by County in the era noted by the CCC survey. No evidence of original bearing trees. Iron pipe was located in order to make comparisons to other corners.

1988 on September 28 a Landecker-Stevenson & Associates crew set a 2 inch by 24 inch iron pipe with brass cap, plastic base and magnet in place of found 2 inch iron pipe. Monument is in centerline of East-West road, down 12 inches below surface. This position agrees with the measurements as noted in the CCC notes along the South line of Section 33 and 34 said township accepted as a perpetuation of the original corner. New bearing trees were marked as shown and two steel sign posts set as noted on front of this certificate.