

# CERTIFICATE OF LOCATION OF GOVERNMENT CORNER

Meander \_\_\_\_\_ Corner of Sections 27/34, Township 141 N, Range 30 W, 5th P.M.

STATE OF MINNESOTA, County of Cass

At the corner location shown on the sketch:

Latitude: 46° 59' 38.794"  
 Longitude: 94° 27' 08.631"

On \_\_\_\_\_ found a \_\_\_\_\_  
DATE

left monument as found,  lowered monument,  removed monument (explain)

On 1/9/89 placed a 2 inch by 54 inch iron pipe with brass cap,  
DATE  
plastic base and magnet.

Magnetic Decl: 5° East SKETCH OF REFERENCE TIES  
 Not to Scale

All distances are horizontal to nail in side of tree

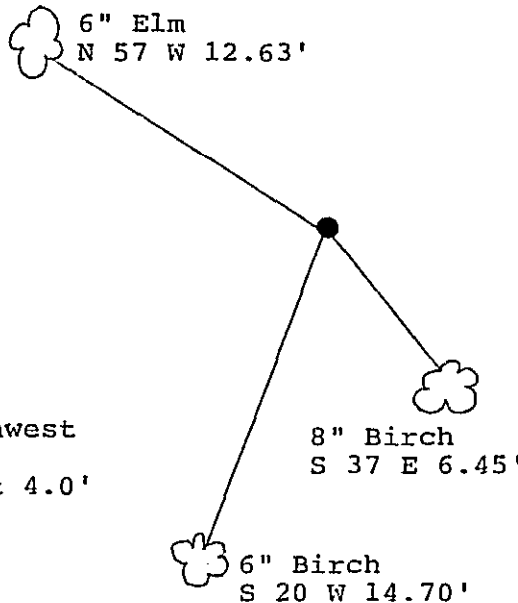
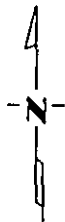

Monument is located at base of slope 25' Southwest of waters edge.  
 8' steel sign post West 4.0'

Diamond Lake

Monument Stamped  
 T 141 N R 30 W  
~~S27~~ MC  
 S34  
 1989  
 RLS 17008

All trees are painted with red enamel and marked with a 54-3 (bearing tree) tag.

Statement of evidence relative to this corner location is on back of page. 310880

I hereby certify that this survey, plan or report was prepared by me or under my direct supervision and that I am a duly Registered Land Surveyor under the laws of the State of Minnesota.

David S. Landecker  
 David S. Landecker

Date 3/10/89 Registration No. 17008

OFFICE OF THE COUNTY RECORDER

County of Cass

I hereby certify that this document was filed in the Co. Recorders office at 3:40 P. .M. on the 14 day of March A.D., 1989

County Recorder Clondine Kayler

By ms, Deputy

DOCUMENT NO. 310880

Statement of Evidence:

Meander Corner Number 10, Section 34, Township  
141 North, Range 30 West, Cass County,  
Minnesota

V16-17 141-30  
Bk.5 Pg.65

1873 P. H. Conger, U.S. Deputy Surveyor, originally established this corner position while subdividing Township 141 North, Range 30 West. The notes indicate a wood post was set to mark the corner position and the following witnesses: a 24 inch White Pine North 72 degrees West a distance of 123 links; and a 24 inch Yellow Pine South 24 degrees East a distance of 38 links.

1964 U.S. Forest Service technician Ekstrom searched for the corner but found no evidence.

1986 U.S. Forest Service crews set an aerial target in the vicinity of this corner for the search and establishment of the true corner position. The target having coordinate values through the use of GPS on the Chippewa South Boundary Project Cadastral Survey U.S. Project Number 53-6392-8-219. This target allowed for the search and location of this corner.

1988 on September 23 a Landecker-Stevenson & Associates crew searched for the corner. The following information was found and noted: two Pine stumps that are too small and do not fit with the original notes, no original evidence found, corner determined lost.

1989 on January 16 a Landecker-Stevenson & Associates crew set a 2 inch by 54 inch iron pipe with brass cap, plastic base and magnet at the lost single proportion position between the Northwest and Northeast Corners of Section 34. New bearing trees were marked as shown and 8 foot steel sign post set as noted on front of this certificate.