

# CERTIFICATE OF LOCATION OF GOVERNMENT CORNER

NORTHEAST Corner of Section 25, Township 141N, Range 30W, 5th P.M.

STATE OF MINNESOTA, County of CASS

At the corner location shown on the sketch:

Latitude: 47° 00' 31.007"  
 Longitude: 94° 24' 24.665"

On 5-18-88 found a 2" iron monument with brass cap and squared wooden stake.

left monument as found,  lowered monument,  removed monument (explain)

On \_\_\_\_\_ placed a \_\_\_\_\_  
DATE

Magnetic Decl: 5° East SKETCH OF REFERENCE TIES  
 Not to Scale

All distances are horizontal to nail in side of tree.

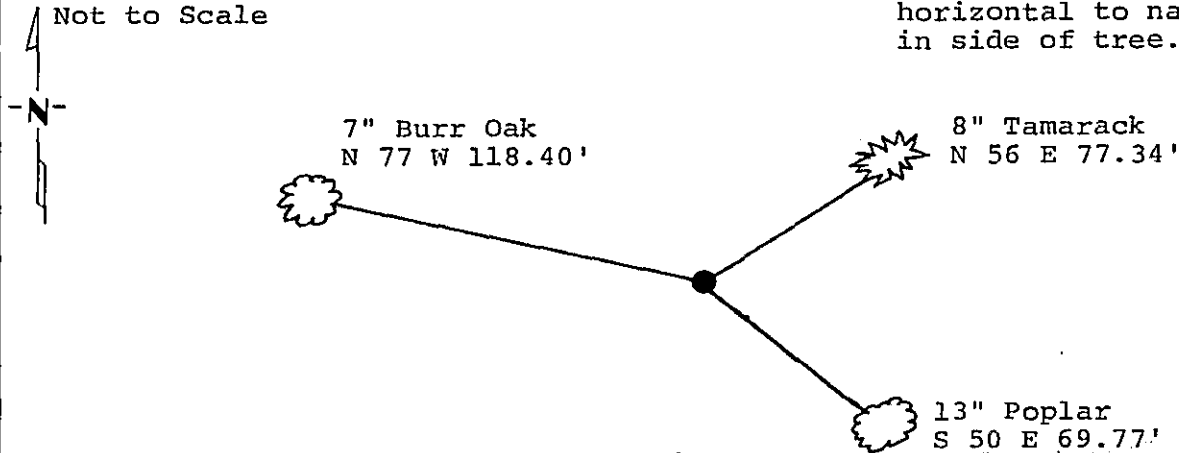

Monument is located in swamp northerly of north edge of Tepee Lake  
 6' signpost S 64 W 5.5'  
 6' signpost North 8.6'  
 8' signpost West 5.0'

Monument Stamped

T 141 N  
 R 30 W R 29 W  
 S 24 S 19  
 S 25 S 30  
 1965  
 R.L.S. No. 6807

All trees are painted with red enamel and marked with a 54-3 (Bearing Tree) tag.

Statement of evidence relative to this corner location is on back of page. 310868

I hereby certify that this survey, plan or report was prepared by me or under my direct supervision and that I am a duly Registered Land Surveyor under the laws of the State of Minnesota.

David S. Landecker  
 David S. Landecker

Date \_\_\_\_\_ Registration No. 17008

OFFICE OF THE COUNTY RECORDER  
 County of Cass

I hereby certify that this document was filed in the Co. Recorders office at 2:15 P. M. on the 14 day of March A.D., 1989

County Recorder Claudine Kuylen  
 By MS, Deputy

DOCUMENT NO. 310868

Statement of Evidence:

Northeast Corner Section 25, Township 141  
North, Range 30 West, Cass County, Minnesota

R-25 141-30  
Bk.4 Pg.4

1873 P. H. Conger, U.S. Deputy Surveyor, originally established this corner position while running the east line of Township 141 North, Range 29 West. The notes indicate a wood post was set to mark the corner position and the following witnesses: a 7 inch Tamarack North 42 and 1/2 degrees East a distance of 9 links; a 6 inch Tamarack North 19 degrees West a distance of 67 links; a 5 inch Tamarack North 53 degrees West a distance of 66 links; a 7 inch Tamarack North 61 degrees East a distance of 14 links.

1915 County Surveyor's Record Book C page 464 show survey by John Curo. He found old stake and evidence of the Northeast and Southeast bearing trees. He set a new stake.

1964 U.S. Forest Service records show the following: found decayed stumps of the Northeast and Northwest bearing trees and very old squared stake. Set a 2 inch by 60 inch iron pipe with a marked brass cap to mark this corner and marked the following witnesses: an 8 inch Aspen South 47 degrees East a distance of 70.0 feet; a 7 inch Aspen North 74 degrees West a distance of 78.0 feet; and a 7 inch Tamarack North 60 degrees east a distance of 77.3 feet.

1969 U.S. Forest Service Surveyor Bill Okerman filed corner certificate using 1964 information.

1986 U.S. Forest Service crews set an aerial target over this corner position for determination of coordinate values through the use of GPS on the Chippewa South Boundary Project Cadastral Survey U.S. Project Number 53-6392-8-219. This target allowed for the search and location of this corner.

1988 on May 18 a Landecker-Stevenson & Associates crew visited the corner and found the following evidence: 1965 Northeast and Southeast bearing trees; 2 inch Forest Service brass cap. New bearings trees were marked and steel sign posts found and set as noted on front of this certificate.