

CERTIFICATE OF LOCATION OF GOVERNMENT CORNER

NORTH QUARTER Corner of Section 25, Township 141 N, Range 29 W, 5th P.M.

STATE OF MINNESOTA, County of CASS

At the corner location shown on the sketch: Latitude: 47° 00' 32.732"
 Longitude: 94° 17' 39.557"

On 6/15/88 found a 1" iron monument with a brass cap
DATE

left monument as found, lowered monument, removed monument (explain)

On _____ placed a _____
DATE

Magnetic Decl: 5° East
 Not to Scale

SKETCH OF REFERENCE TIES

All distances are horizontal to nail in side of tree

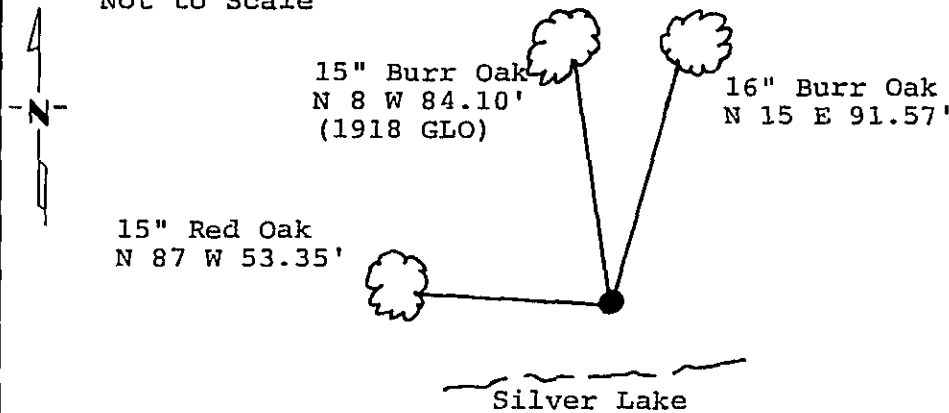

Monument Stamped

$\frac{1}{2}$ S 24
S 25
 1918

Monument is located
 30' more or less northerly
 of north shore of Silver
 Lake
 8' steel sign post West 5.0'

All trees are painted with red enamel and marked with a 54-3 (Bearing Tree) tag.

Statement of evidence relative to this corner location is on back of page. 310673

I hereby certify that this survey, plan or report was prepared by me or under my direct supervision and that I am a duly Registered Land Surveyor under the laws of the State of Minnesota.

David S. Landecker
 David S. Landecker
 Date 2/28/89 Registration No. 17008

OFFICE OF THE COUNTY RECORDER

County of Cass

I hereby certify that this document was filed in the Co. Recorders office at 2:55 P. M. on the 1 day of March A.D., 19 89

County Recorder Clouline Kayler
 By MS, Deputy

DOCUMENT NO. 310673

Statement of Evidence:

North Quarter Corner Section 25, Township 141
North, Range 29 West, Cass County, Minnesota

R-23 141-29
Bk. 4 Pg. 22

1873 P. H. Conger, U.S. Deputy Surveyor, originally established this corner position while subdividing Township 141 North, Range 29 West. The notes indicate a wood post was set to mark the corner position and the following witnesses: a 7 inch Norway Pine North 20 degrees West a distance of 19 links; and a 10 inch White Pine South 70 degrees East a distance of 30 links.

1918 U.S. General Land Office dependant resurvey reestablished this corner proportionally between the Northwest and Northeast corners of said Section 25 . An iron pipe with a marked brass cap was set to mark the corner. The following bearing trees were marked: a 7 inch Red Oak South 61 degrees West a distance of 129 links; and a 10 inch White Oak North 8 and 1/4 degrees West a distance of 128 links.

1975 U.S. Forest Service records show the following: Leo Withoff placed Forest Service Location Poster's on the following trees: a 9 inch Birch North 50 degrees West a distance of 4 feet; and a 9 inch Ash South 28 degrees West a distance of 15.2 feet.

1986 U.S. Forest Service records show the following: found General Land Office iron pipe with brass cap, place rocks around corner; found 1918 bearing trees: a 16 inch White Oak North 8 degrees West a distance of 84.5 feet; and a 12 inch Red Oak tipout South 61 degrees West a distance of 85.14 feet.

1986 U.S. Forest Service crews set an aerial target over this corner position for determination of coordinate values through the use of GPS on the Chippewa South Boundary Project Cadastral Survey U.S. Project Number 53-6392-8-219. This target allowed for the search and location of this corner.

1988 on June 15 a Landecker-Stevenson & Associates crew visited the corner and found the following evidence: GLO brass cap in good condition with rock around corner; 1918 General Land Office bearing tree South 61 degrees West a distance of 85 feet, is a tipout; 1918 General Land Office bearing tree now a 15 inch Burr Oak North 8 degrees West a distance of 84.10 feet. 2 new bearing trees were marked and steel sign post set as shown on front. of this certificate.