

CERTIFICATE OF LOCATION OF GOVERNMENT CORNER

East Quarter Corner of Section 18, Township 141 N, Range 30 W, 5th P.M.

STATE OF MINNESOTA, County of Cass

At the corner location shown on the sketch: Latitude: 47° 01' 51.26086"
 Longitude: 94° 30' 48.23882"

- On 7/19/88 found a 1 inch by 36 inch Iron Monument with Brass
DATE Cap. Replaced monument when it broke off checking for stabilization
 left monument as found, lowered monument, removed monument (explain)
- On 7/19/88 placed a 2 inch by 48 inch Iron Monument with a Brass
DATE Cap in place of broken monument.

Magnetic Decl: 5° East SKETCH OF REFERENCE TIES
 Not to Scale

All distances are horizontal to nail in side of tree.

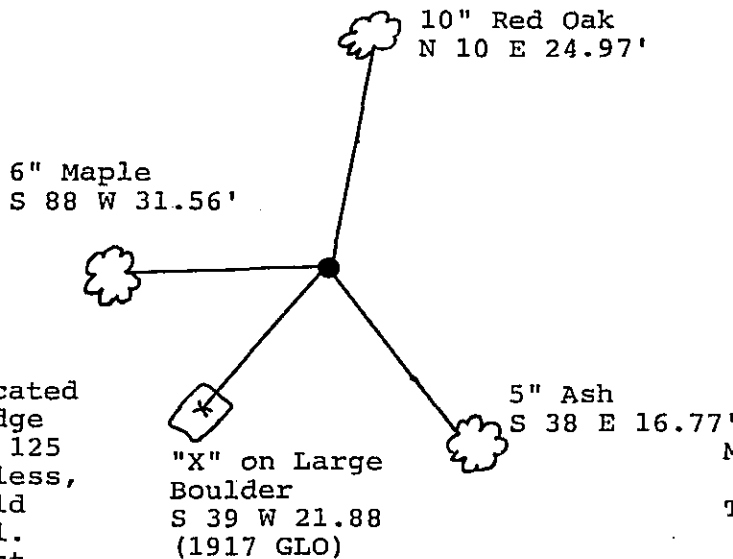
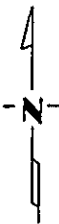

Monument is located at Northerly edge of small swamp 125 feet, more or less, Northerly of old East-West Trail. 8 foot sign post South 5.0 feet.

All trees are painted with red enamel and marked with a 54-3 (Bearing Tree) tag.

Monument Stamped

T 141 N R 30 W
 S 18 ¹/₂ S 17
 1988

RLS No. 17008

Statement of evidence relative to this corner location is on back of page. 309838

I hereby certify that this survey, plan or report was prepared by me or under my direct supervision and that I am a duly Registered Land Surveyor under the laws of the State of Minnesota.

David S. Landecker
 David S. Landecker
 Date 12-15-88 Registration No. 17008

OFFICE OF THE COUNTY RECORDER
 County of Cass

I hereby certify that this document was filed in the Co. Recorder's office at 10:05 A. M. on the 12 day of January A.D., 19 89

County Recorder Phyllis Kayler
 By Ms, Deputy

DOCUMENT NO. 309838

Statement of Evidence:

East Quarter Corner Section 18, Township 141
North, Range 30 West, Cass County, Minnesota

L-5 141-30
Bk.5 Pg.15

1873 P. H. Conger, U.S. Deputy Surveyor, originally established this corner position while subdividing Township 141 North, Range 30 West. The notes indicate a wood post was set to mark the corner position and the following witnesses: a 10 inch Red Oak North 87 degrees East a distance of 12 links; and a 6 inch Red Oak South 86 degrees West a distance of 18 links.

1917 U.S. General Land Office dependent resurvey established this corner proportionally between the Northeast and the Southeast Corners of said Section 18. A 1 inch by 36 inch iron pipe with a marked brass cap was set to mark this corner. Placed a mound of stone with a 2 foot base, 1 and 1/2 feet high west of corner; "x" on rock 6 feet by 6 feet by 4 feet South 36 and 3/4 degrees West a distance of 33 links.

1986 U.S. Forest Service crews set an aerial target in the vicinity of this corner for the search and establishment of the true corner position. The target having coordinate values through the use of GPS on the Chippewa South Boundary Project Cadastral Survey U.S. Project Number 53-6392-8-219. This target allowed for the search and location of this corner.

1988 on July 19 a Landecker-Stevenson & Associates crew searched from target Number 24. The following information was found: a brass cap monument up 16 inches, rusted. Top broke off when wiggled. Set a 2 inch by 48 inch iron pipe with brass cap and plastic base. Corner on Northerly edge of small swamp; 125 feet, more or less, Northerly of old East-West trail; 1918 "x" on rock South 39 degrees West a distance of 21.88 feet. Set a 8 foot signpost South 5.0 feet, with sign 54-9; a 5 inch Ash South 38 degrees East a distance of 16.77 feet; a 6 inch Maple South 88 degrees West a distance of 31.56 feet; and a 10 inch Red Oak North 10 degrees East a distance of 24.97 feet.

1988 on July 26 a Landecker-Stevenson & Associates crew visited the corner. They did a solar observation and tied corner to target. (Book 3, Page 43)