

CERTIFICATE OF LOCATION OF GOVERNMENT CORNER

NORTHEAST Corner of Section 21, Township 143 N, Range 26 W, 5th P.M.

STATE OF MINNESOTA, County of CASS

At the corner location shown on the sketch:

On _____ found a _____

left monument as found, lowered monument, removed monument (explain)

On 11/3/87 placed a 1 1/4" x 1 1/4" x 20" PERFORATED STEEL TUBE WITH ALUMINUM CAP STAMPED "DNR SURVEY MARKER", DOWN 0.2'

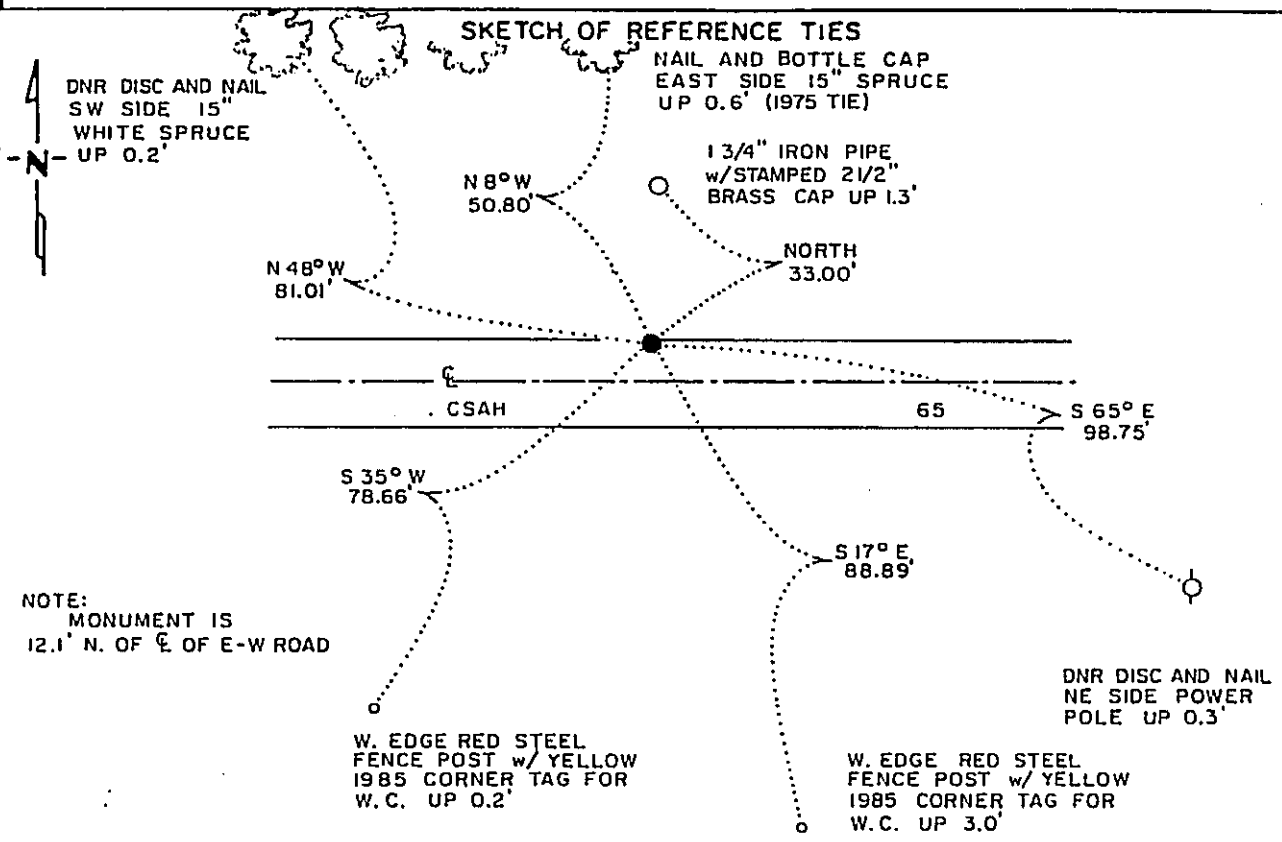

NOTE:
MONUMENT IS
12.1' N. OF $\frac{1}{2}$ OF E-W ROAD

BEARINGS OBSERVED WITH COMPASS

Statement of evidence relative to this corner location is on back of page. J.A.G. 11/13/87
FILE NO. G-321

I hereby certify that this document and the data contained herein was prepared by me or under my direct supervision.

John D. Walker 2-1-88
SIGNATURE DATE

Registration No. 16098

Land Surveyor, Professional Engineer
 County Surveyor, County Engineer

303529
OFFICE OF THE COUNTY RECORDER
County of Cass

I hereby certify that this document was filed in the Co. Recorders office at 3:50 P.M. on the 4 day of April A.D., 1988

County Recorder Claudine Kaylor
By ms, Deputy

DOCUMENT NO. 303529

Northeast Corner Section 21, Township 143 North, Range 26 West

- 1872 The U.S. General Land Office set a post and recorded four bearing trees.
- 1900 The U.S. Corp of Engineers describes this corner as known.
- 1922 The U.S. General Land Office notes state that the true corner falls in the middle of a road. A squared cedar post set as a witness corner by a local surveyor was found 33 feet north of the road centerline. The General Land Office recorded two bearing trees to the witness corner and replaced the cedar post with a 2"x36" iron pipe with a stamped brass cap.
- 1925 A Cass County Land Corner Record Sheet discloses that the County Highway Department used the corner and measured the following ties:
telephone pole, SE, 31.5 feet
USGLO W.C., N., 33.0 feet
- 1935 The U.S. Forest Service describes the corner as an iron pipe inplace.
- 1940 The U.S. Forest Service describes the corner as a brass pipe inplace.
- 1959 The DNR found the brass capped witness corner 33 feet north of the road centerline. Set a spike for the section corner 33 feet south of the witness corner.
- Circa A County Road No. 65 R/W map identifies the corner as an iron pipe inplace
1962 47.3 feet north of a spike inplace in the road centerline.
- 1975 The DNR set a spike 33 feet south of a capped 2" iron pipe marked witness corner.
- 1987 The DNR placed a standard DNR Monument as shown and described on this certificate. The corner was set using one 1922 tie and one 1975 tie.

Traverse information is available from the DNR Bureau of Engineering.