

# CERTIFICATE OF LOCATION OF GOVERNMENT CORNER

WEST SIXTEENTH Corner of Section 26&35, Township 144, Range 30, 5th P.M.

STATE OF MINNESOTA, County of CASS

At the corner location shown on the sketch:

On 12-28-87 found a GLO brass cap monument  
DATE

left monument as found,  lowered monument,  removed monument (explain)

On \_\_\_\_\_ placed a \_\_\_\_\_  
DATE

### SKETCH OF REFERENCE TIES

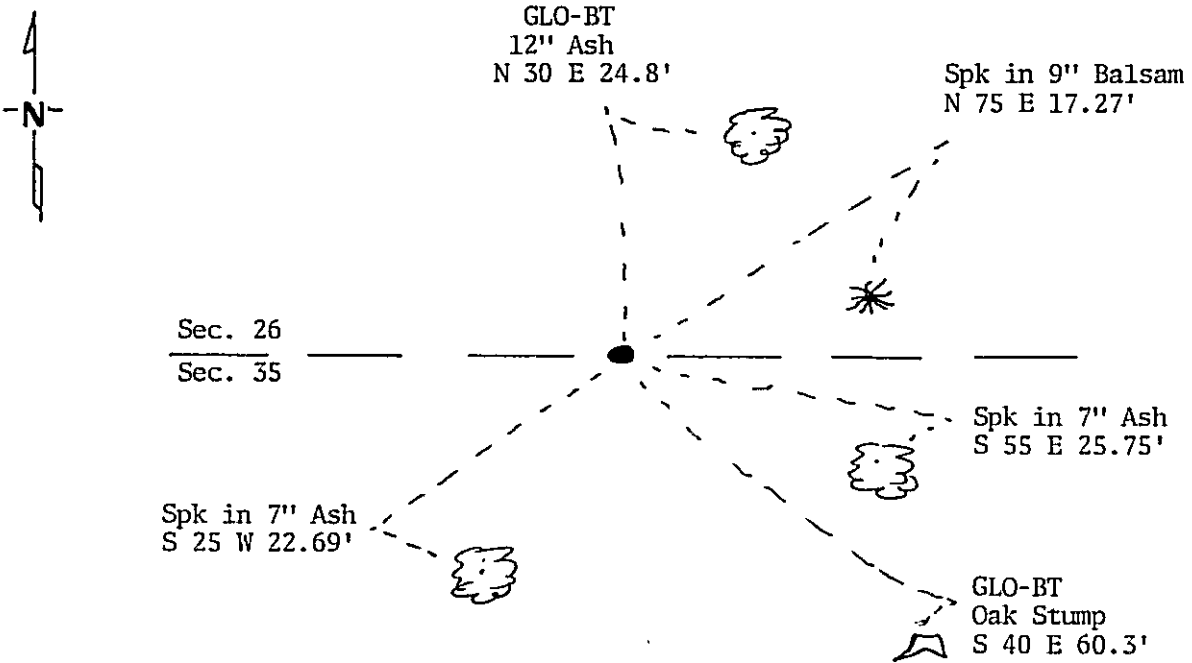

BEARINGS ARE APPROXIMATE

Statement of evidence relative to this corner location is on back of page. 303286

I hereby certify that this document and the data contained herein was prepared by me or under my direct supervision.

Ray H. Stevan 3/1/88  
SIGNATURE DATE

Registration No. 12684

Land Surveyor,  Professional Engineer

County Surveyor,  County Engineer

OFFICE OF THE REGISTER OF DEEDS

County of Cass

I hereby certify that this document was filed in the Reg. of Deeds office at 2:30 P. M. on the 22 day of March A.D., 1988

Register of Deeds Clouline Kaylon

By: M.S. Deputy

DOCUMENT NO. 303286

Statement of Evidence:

- 1930 U.S. General Land Office dependent resurvey established this corner and an iron pipe with a marked brass cap was set to mark the corner. The following bearing trees were marked: 4" Ash N 37½ E 37 links and 12" W. Oak S 44 E 91 links.
- 1987 County Surveyor's Records in the Recorder's Office were checked and no resurvey information was found on this corner.
- 1987 U.S. Forest Service office in Cass Lake was contacted for information and no resurvey information was found on this corner.
- 1987 Found GLO brass cap in good condition. 12" Ash was found fitting the call for the bearing tree to the NE and remains of an oak stump was found fitting the call for the bearing tree to the SE. Measured west to northwest corner of Sec. 35 and east to MC No. 5. Distances checked very well with the 1930 survey and monument was within a foot of being on line. Accepted monument as the government corner and took ties as shown on this certificate.