

CERTIFICATE OF LOCATION OF GOVERNMENT CORNER

Meander No. 27 Corner of Section 1, Township 140, Range 29, 5th P.M.

STATE OF MINNESOTA, County of Cass

At the corner location shown on the sketch:

- On 10/20/87 found a 1 1/2" iron pipe
DATE
- left monument as found, lowered monument, removed monument (explain)
- On 12/11/87 placed a 2" x 2" x 36" steel post with a 3" x 3" aluminum cap.
DATE

SKETCH OF REFERENCE TIES

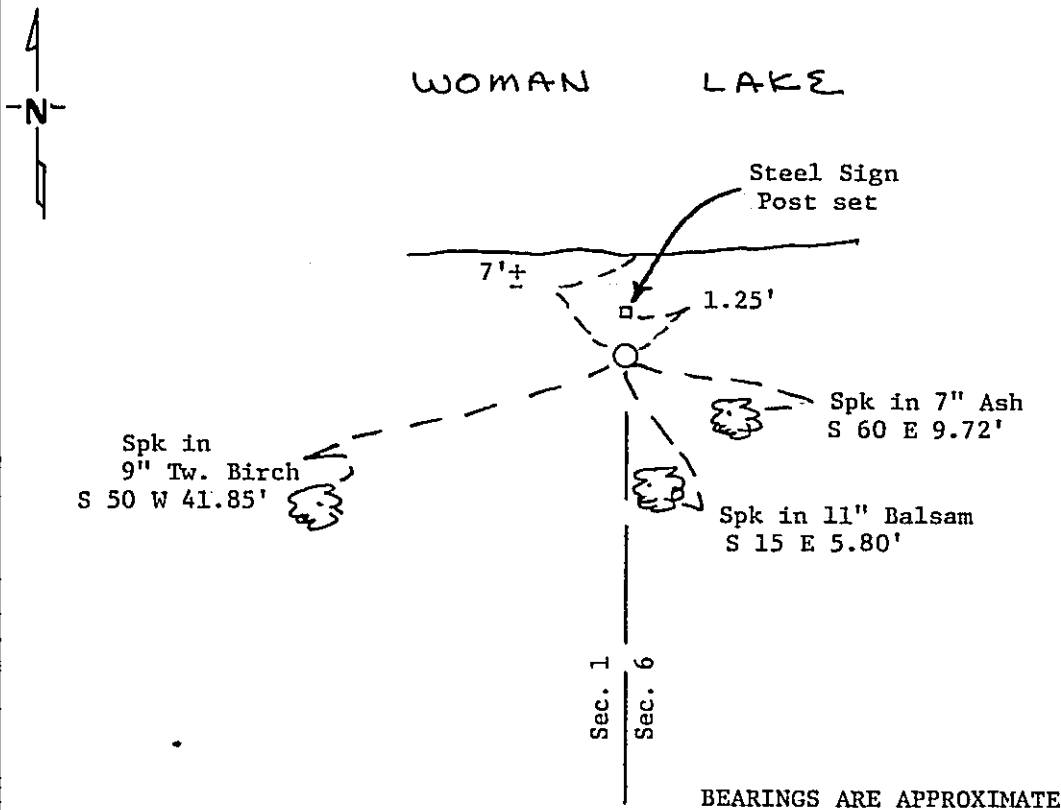

Statement of evidence relative to this corner location is on back of page. 302547

I hereby certify that this document and the data contained herein was prepared by me or under my direct supervision.

Wayne H. Ataman 1/18/88
SIGNATURE DATE

Registration No. 12684

- Land Surveyor, Professional Engineer
- County Surveyor, County Engineer

OFFICE OF THE REGISTER OF DEEDS
 County of Cass

I hereby certify that this document was filed in the Reg. of Deeds office at 9:00 A.M. on the 3 day of February A.D., 19 88

Register of Deeds Clonidine Kayler

By MS, Deputy

DOCUMENT NO. 302547

Statement of Evidence:

- 1864 U.S. General Land Office survey set wood post for this corner and marked the following bearing trees: 6" Willow S 17 E 22 links and 8" Cedar S 53 W 40 links.
- 1987 County Surveyor's Records in the Recorder's Office were checked and no re-survey information was found on this corner.
- 1969 Survey notes of Robert F. Schneider, RLS No. 5740, show 1½" iron pipe found on shore of Woman Lake. Schneider's records contained a survey by Harold Curo, RLS No. 3417, dated March 8, 1961 which showed an iron monument at this location. Mr. Schneider accepted iron as marking the meander corner position and based metes and bounds surveys in Gov't Lot 10, Sec. 6, 140-28 on the found iron. In 1971, Mr. Schneider conducted additional surveys in Sec. 6 involving the subdivision of Sec. 6.
- Curo's survey also shows iron at N 1/16th corner of Sec. 1 and Sec. 6. Mr. Schneider extended these irons north to intersect the 10th Standard Parallel and found this computed position to fit very well with the GLO distances. SW corner of Sec. 31, 141-28 east to intersection was found to be 757.75' compared to GLO distance of 759.0'. Intersection to iron found at MC#27 was found to be 858.61' compared to GLO distance of 858.0'.
- 1987 1½" iron pipe was found as called for in Schneider's notes and position verified by tying to Schneider's traverse points. No evidence was found of the GLO bearing trees. I accepted the iron pipe as the best available evidence of the meander corner position. A Cass County monument was set over the found pipe and ties taken as shown on this Certificate.