

# CERTIFICATE OF LOCATION OF GOVERNMENT CORNER

NORTHQUARTER Corner of Section 32, Township 140 N, Range 29 W, 5th P.M.

STATE OF MINNESOTA, County of CASS

At the corner location shown on the sketch:

On DEC. 31, 1987 found a 1 1/4" IRON 24" ABOVE GROUND  
DATE

left monument as found,  lowered monument,  removed monument (explain)

On \_\_\_\_\_ placed a \_\_\_\_\_  
DATE

NO SCALE

### SKETCH OF REFERENCE TIES

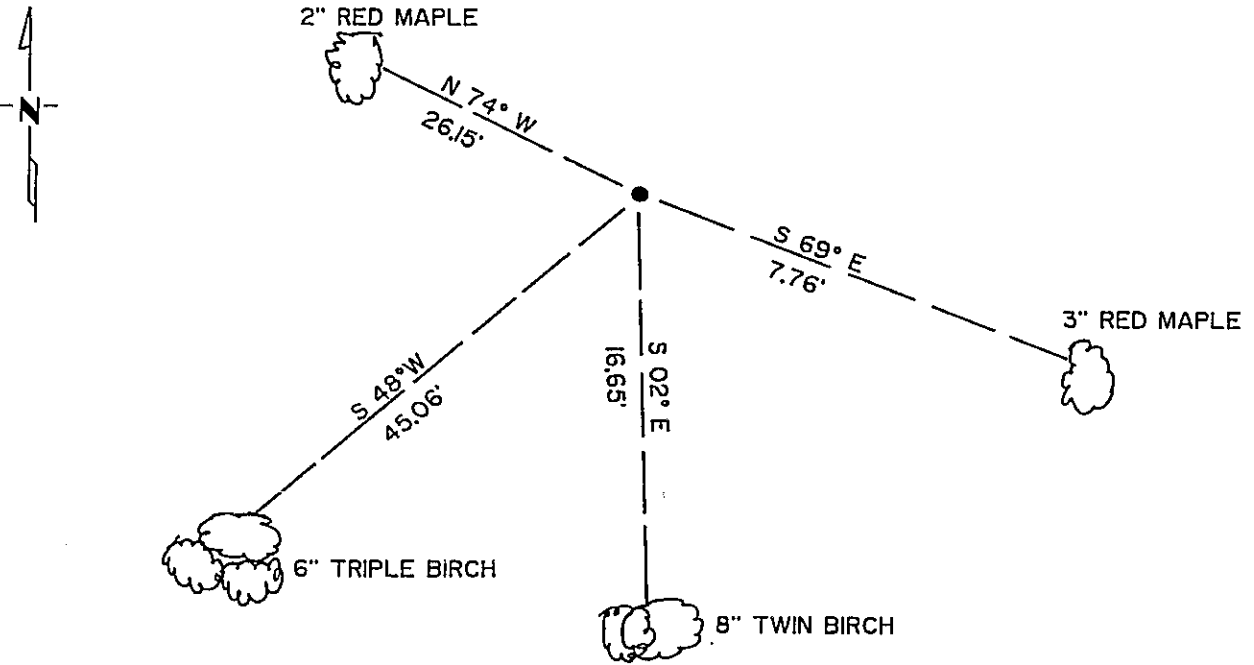

NOTE: BEARINGS TO TREES ARE MAGNETIC.  
 DISTANCES ARE TO DUPLEX NAILS IN SIDE OF TREES.  
 ALL TREES ARE MARKED WITH DOUBLE BLAZES.

Statement of evidence relative to this corner location is on back of page. 302277

I hereby certify that this document and the data contained herein was prepared by me or under my direct supervision

David A. Sanderson 1/4/88  
SIGNATURE DATE

Registration No. 17008

- Land Surveyor
- County Surveyor

OFFICE OF THE COUNTY RECORDER

County of Cass

I hereby certify that this document was filed in the Co. Recorders office at 3:53 P. M. on the 13 day of January A.D., 19 88

County Recorder Claudine Keylor

By MS, Deputy

DOCUMENT NO. 302277

Statement of Evidence:

V-7 190

North Quarter Corner, Section 32, Township 140 North, Range 29 West, Cass County, Minnesota.

In 1870 the original government survey was done by Orville Smith. A wood post was set to mark the corner.

Two bearing trees witnessing said corner were marked, noted as follows:  
7" black oak North 25 degrees East, 16 links  
5" white birch South 33 degrees West, 18 links.

Around the middle 1940's W. J. Spain, Jr., RLS #2003, used this monument in the subdivision of Government Lot 5, 6, 7, 8 and the Northeast Quarter of the Southeast Quarter for then land owner Foss. Current owner of Government Lot 8, Albert Foss (son), testified also of this fact and described Spain's services, as the Foss's helped Spain through the process of the survey.

In 1987 David Landecker, RLS #17008, surveyor with the firm of Landecker & Associates, Inc., found iron pipe monument used by Spain in the Foss survey and accepts this monument as the corner.

Landecker File #87107