

# CERTIFICATE OF LOCATION OF GOVERNMENT CORNER

NORTHEAST Corner of Section 21, Township 139, Range 29, 5th P.M.  
STATE OF MINNESOTA, County of CASS

At the corner location shown on the sketch:

- On 4-13-87 found a 3/8" iron rod with cap marked RLS 17008  
DATE
- left monument as found,  lowered monument,  removed monument (explain)
- On \_\_\_\_\_ placed a \_\_\_\_\_  
DATE

### SKETCH OF REFERENCE TIES

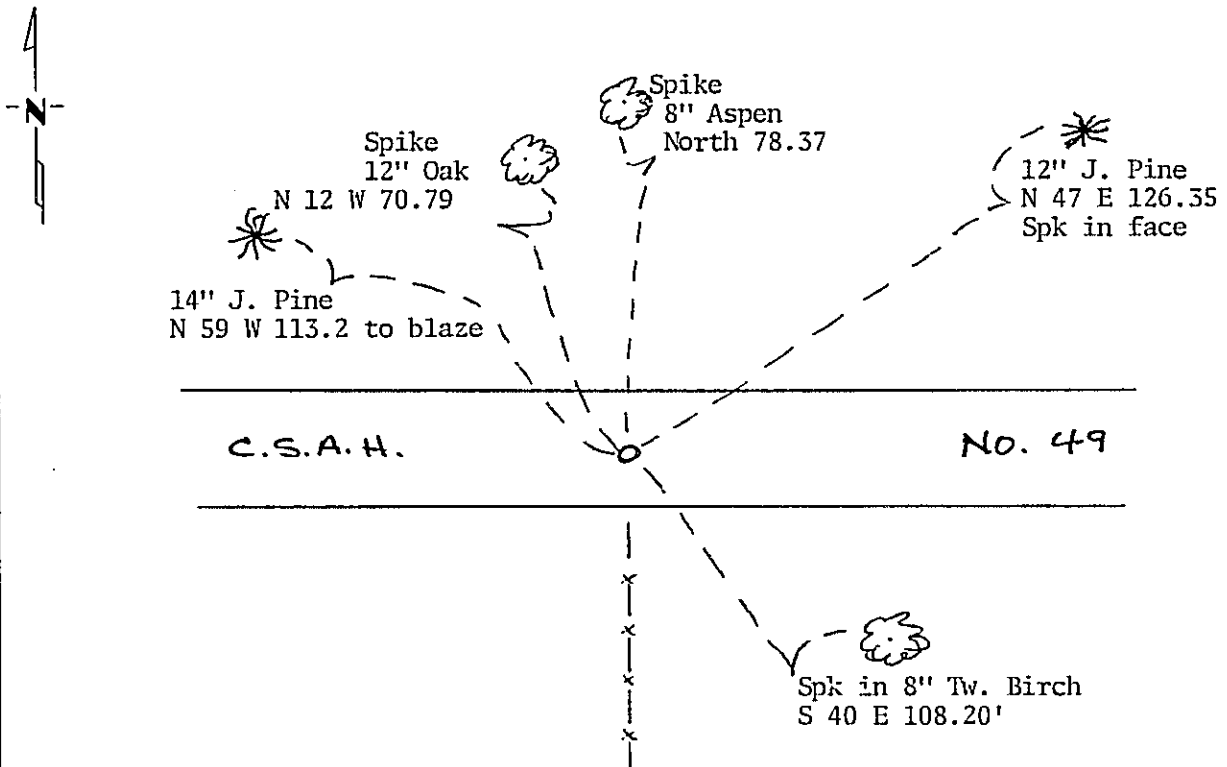

BEARINGS ARE APPROXIMATE

Statement of evidence relative to this corner location is on back of page. 300479

I hereby certify that this document and the data contained herein was prepared by me or under my direct supervision.

Mary H. Stearns 7/11/87  
SIGNATURE DATE

Registration No. 12684  
 Land Surveyor,  Professional Engineer  
 County Surveyor,  County Engineer

OFFICE OF THE COUNTY RECORDER  
County of Cass

I hereby certify that this document was filed in the Co. Recorders office at 3:47 P.M. on the 20 day of Oct. A.D., 19 87

County Recorder Claudia Kayler  
By MS, Deputy  
DOCUMENT NO. 300479

Statement of Evidence:

- 1865 U.S. General Land Office survey set wood post for this corner and marked the following bearing trees: 22" N. Pine S 18 E 18 links, 18" N. Pine N 47 E 150 links, 25" N. Pine N 89 W 136 links, 10" B. Pine S 75 W 58 links.
- 1908 County Surveyor notes in Book 95 on page 37 show John Curo found true section corner set by N.W. Hicks 2 years before.
- 1966 R.F. Schneider found a Railroad Spike in the center line of east-west road and took the following ties: 6" J. Pine S 42 W 31.4', PK in fence corner post South 32.55', and steel fence post north 33.0'. Railroad spike was found and used as corner again in 1969 & 1972.
- 1970 Donald Coulter set a 1½ x 3' iron pipe over RR spike found from R.F. Schneider's ties. New ties: 12" Poplar N 24 E 69.5', 10" Oak N 11-45 W 70.3', 12" J. Pine N 55-45 W 113.20, 12" Poplar S 3415W 54.6', and 12" Oak S 53 W 100.10.
- 1972 Notes from RCM, Inc. show corner used.
- 1975 R.F. Schneider found a 1½" iron pipe in place where RR spike had been. New ties taken: 15" J. Pine N 14 W 130.91' and 12" J. Pine N 50 E 126.25'. Corner in center of road and in line with fence south.
- 1975 Cass County Highway Department notes show iron pipe in place with ties: 6" Oak NW 70.7', 6" Poplar North 78.4' and 12" Poplar NE 81.0'.
- 1980 I found iron pipe tipped over from road construction and set spike from ties.
- 1987 We found a 3/8" iron rod with RLS No. 17008 at corner and took ties which checked with previous ties. Checked with Dave Landecker, RLS No. 17008 and he said iron was set over an iron. His notes show corner had been used and accepted by: John Curo, E.B. Horst, R.F. Schneider, Cass County Highway Dept., Cass County Surveyor's Office, Walt Curo, and myself. Distance west of 2643.49 feet checks good with GLO distance of 40.05 chains (2643.3') and John Curo's of 2644.5 feet to the N¼ corner of Sec. 21.