

# CERTIFICATE OF LOCATION OF GOVERNMENT CORNER

NORTH QUARTER Corner of Section 21, Township 140 N, Range 26 W, 5th P.M.

STATE OF MINNESOTA, County of CASS

At the corner location shown on the sketch:

- On \_\_\_\_\_ found a \_\_\_\_\_  
DATE
- left monument as found,  lowered monument,  removed monument (explain)
- On 8-13-85 placed a 1 1/4" x 1 1/4" x 20" PERFORATED STEEL TUBE WITH AN ALUMINUM CAP STAMPED "DNR SURVEY MARKER", DOWN 0.2' FOR REFERENCE.  
DATE

### SKETCH OF REFERENCE TIES

NOTE: CORNER FALLS IN AN OPEN SWAMP

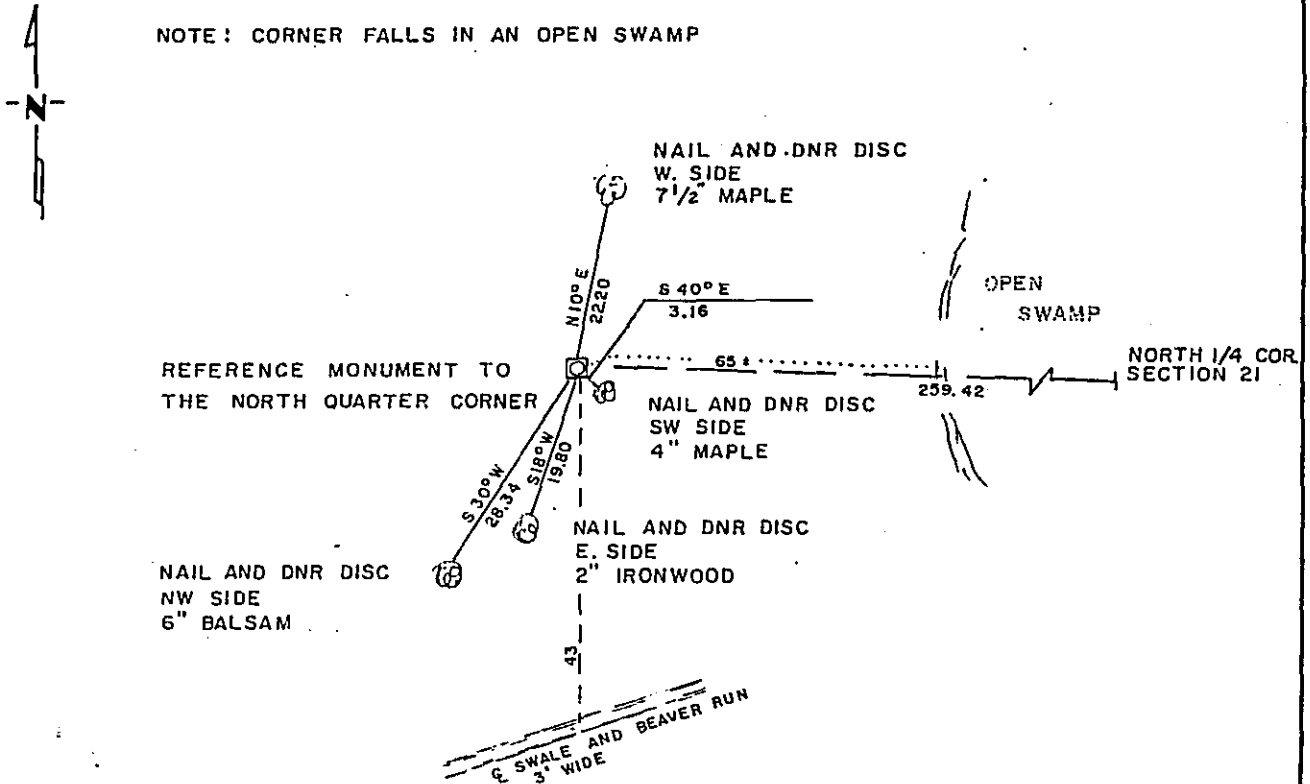

BEARINGS OBSERVED WITH COMPASS

Statement of evidence relative to this corner location is on back of page.

JAW. 10-21-85  
A-414

I hereby certify that this document and the data contained herein was prepared by me or under my direct supervision.

Bert R. Evendick 11-25-86  
SIGNATURE DATE

Registration No. 10514

- Land Surveyor,  Professional Engineer
- County Surveyor,  County Engineer

OFFICE OF THE COUNTY RECORDER

County of Cass

I hereby certify that this document was filed in the Co. Recorders office at 2:20 A.M. on the 22 day of June A.D., 1987

County Recorder Clairine Kayler

By ms, Deputy

DOCUMENT NO. 297687

North Quarter Corner Section 21, Township 140 North, Range 26 West

This corner was originally established by the U.S. General Land Office survey in 1871. The government notes show corner marked with a wood post with the following bearing trees marked:

- 10" Spruce, South, 4 links (2.64 feet)
- 6" Spruce, N. 8° E., 22 links (14.52 feet)

In November 1981, the DNR Bureau of Engineering contacted the following for corner information:

Cass County Offices of the Recorder and Surveyor  
Gary H. Stevenson and Associates, Inc. of Walker  
Wallace F. Buckler of Crosby  
Landecker and Associates, Inc. of Pequot Lakes  
Washburn Lake DNR Forestry Office

The following information was obtained from the Washburn Lake DNR Forestry Office:

Civilian Conservation Corps Field Book 5 on Page 27 dated December 1937, shows that the area 2640 feet west of the northeast corner of Section 21 was searched for evidence of the corner but nothing was found.

Civilian Conservation Corps Field Book 20 on Pages 45 and 46 dated February 1938, show that a traverse was run along the north line of Section 21. Survey does not indicate if the quarter corner was searched for.

In November 1981, the DNR Bureau of Engineering traversed to the area of the corner and searched for but found no evidence of a monument or the GLO bearing trees.

The lost position for corner was computed using the northeast and northwest corners of Section 21. This position was found to be:

- in an open swamp
- 2633.05 feet from adjoining section corners

Accept the lost position as the location of the corner.

On August 13, 1985, a DNR Survey Marker was set on the north line of Section 21, 259.42 feet westerly of the corner as a reference monument.

Traverse information is available from the DNR Bureau of Engineering.