

CERTIFICATE OF LOCATION OF GOVERNMENT CORNER

Northeast Corner of Section 1, Township 134 N., Range 32 W., 5th P.M.

STATE OF MINNESOTA, County of CASS

At the corner location shown on the sketch:

- On _____ found a _____
DATE
- left monument as found, lowered monument, removed monument (explain)
- On 8/26/86 placed a cast iron monument down 0.05', 3.2'E. of centerline
DATE State Hwy # 64, from State Hwy. Dept. information.

SKETCH OF REFERENCE TIES

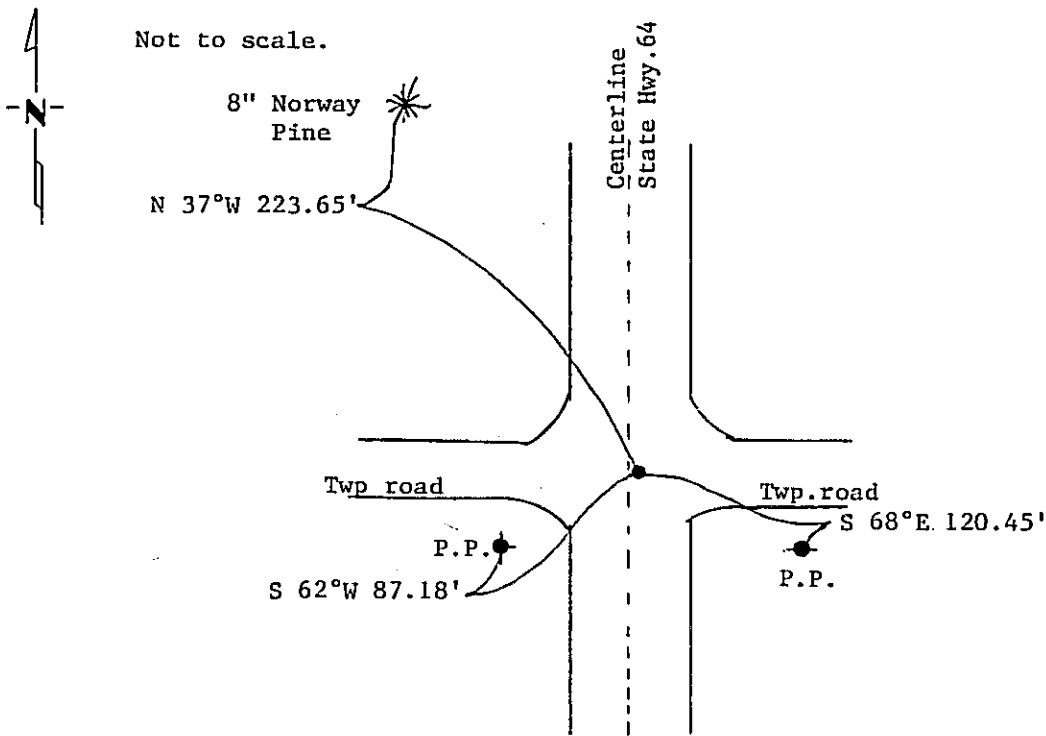

Measurements are to nail in side of object.
Bearings are assumed using 5° declination.

Statement of evidence relative to this corner location is on back of page.

297521

I hereby certify that this document and the data contained herein was prepared by me or under my direct supervision.

Walter E. Cunn 1-23-87
SIGNATURE DATE

Registration No. 11395

- Land Surveyor, Professional Engineer
- County Surveyor, County Engineer

OFFICE OF THE COUNTY RECORDER

County of Cass

I hereby certify that this document was filed in the Co. Recorders office at 11:15 A. ..M. on the 12 day of June A.D., 19 87

County Recorder Claudine Kayle

By Ms, Deputy

DOCUMENT NO. 297521

Statement of Evidence: Northeast Corner Section 1, T.134 N., R.32 W., 5th P.M.

- 1858 U.S. General Land Office survey set a wood post for this corner and marked the following bearing trees: 8" Tam. N 30°E 26 lks., 8" Tam.S 18 3/4°E 48 lks., 6' Tam.S 9 1/2°W 18 lks., 6" Tam.N 70°W 13 lks.
- 1941 Minnesota Department of Transportation assumed the corner at intersection of roads. Assumed corner is 3.2' E. of new N-S centerline.
- 1986 On August 26, Terry Freeman, Cass County Survey Technician and Jim Cripps set a cast iron monument 3.2' E. of centerline of State Hwy # 64 from State Hwy. Dept. information.