

CERTIFICATE OF LOCATION OF GOVERNMENT CORNER

Northeast Corner of Section 4, Township 134 N., Range 32 W., 5th P.M.

STATE OF MINNESOTA, County of CASS

At the corner location shown on the sketch:

- On _____ found a _____
DATE
- left monument as found, lowered monument, removed monument (explain)
- On 8/25/86 placed a cast iron monument down 1.3' at proportional position
DATE
between the N 1/2 Corner Section 4 and the Northeast Corner Section 3

SKETCH OF REFERENCE TIES

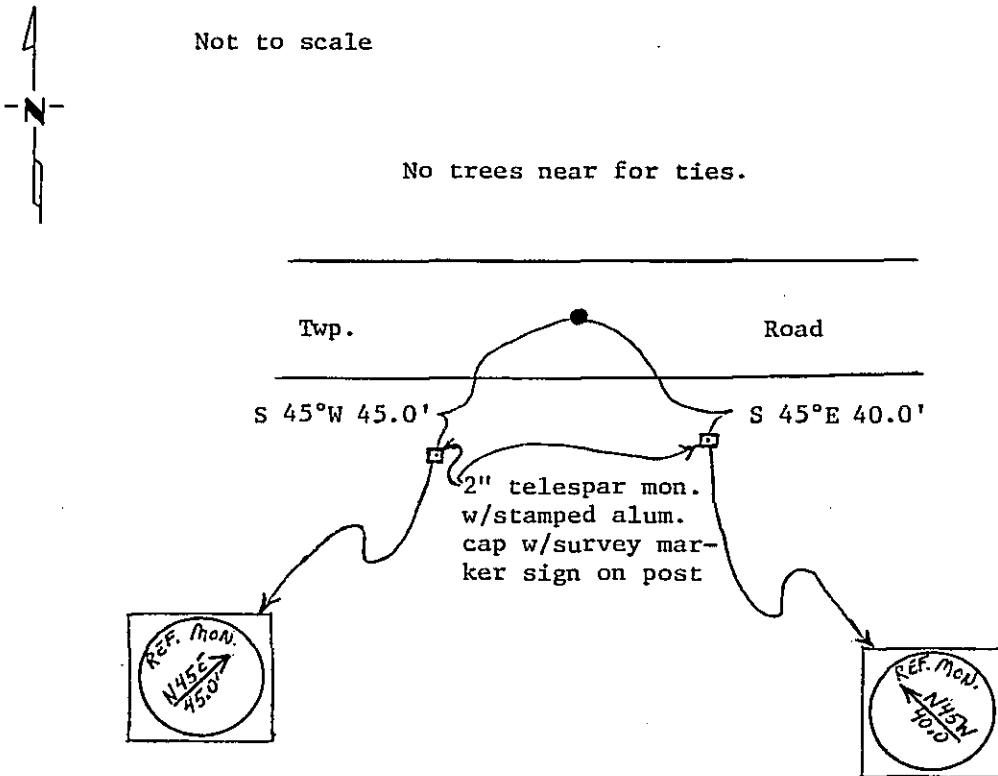

Statement of evidence relative to this corner location is on back of page. 297515

I hereby certify that this document and the data contained herein was prepared by me or under my direct supervision.

Walter E. Lewis 1-23-87
SIGNATURE DATE

Registration No. 11395

- Land Surveyor, Professional Engineer
- County Surveyor, County Engineer

OFFICE OF THE COUNTY RECORDER

County of Cass

I hereby certify that this document was filed in the Co. Recorders office at 10:45 A.M. on the 12 day of June A.D., 1987

County Recorder Clairine Kayle
By MS Deputy

DOCUMENT NO. 297515

Statement of Evidence: Northeast Corner Section 4, T.134 N., R.32 W., 5th P.M.

- 1858 U.S. General Land Office survey set a wood post for this corner but there were no trees available for ties.
- 1985 On Sept. 19, Terry Freeman, Cass County Survey Technician and Ken Meyer, backhoe operator dug in search area provided by Comstock & Davis. Dug 10' E-W x 8' N-S x 2.5' deep. 6" top, 2' of fill to layer of cordoroy. Found nothing.
- 1986 On August 25, Terry Freeman and Jim Cripps set a cast iron monument at proportional position E-W in centerline of road. (Proportional measurement by Comstock & Davis)