

# CERTIFICATE OF LOCATION OF GOVERNMENT CORNER

Northeast Corner of Section 6, Township 134 N., Range 32 W., 5th P.M.  
 STATE OF MINNESOTA, County of CASS

At the corner location shown on the sketch:

- On 8/25/86 found a 1½" x 16" car spring, 12.1' N. of centerline road W.,  
DATE  
inline with centerline road N.  
 left monument as found,  lowered monument,  removed monument (explain)
- On 8/25/86 placed a cast iron monument down 6", with found car spring on  
DATE  
N. side of monument.

### SKETCH OF REFERENCE TIES

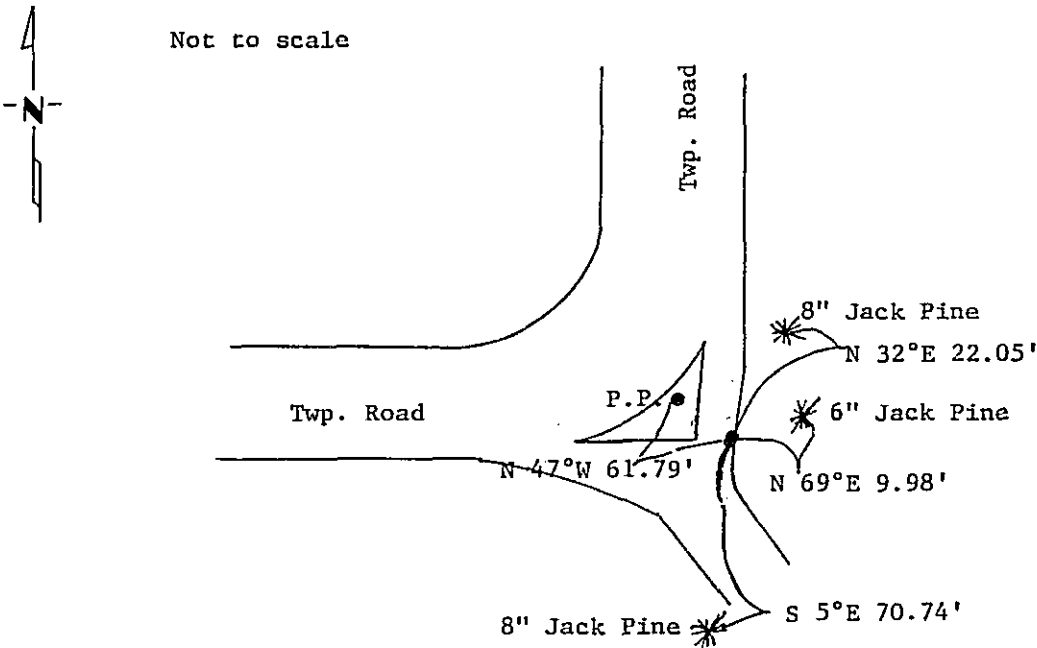

Measurements are to nail in side of object.  
 Bearings are assumed using 5° declination.

Statement of evidence relative to this corner location is on back of page. 297513

I hereby certify that this document and the data contained herein was prepared by me or under my direct supervision.

Walter E. Cass 1-23-87  
SIGNATURE DATE

Registration No. 11395

- Land Surveyor,  Professional Engineer
- County Surveyor,  County Engineer

OFFICE OF THE COUNTY RECORDER  
 County of Cass

I hereby certify that this document was filed in the Co. Recorders office at 10:35 A.M. on the 12 day of June A.D., 19 87

County Recorder Clairine Kaye  
 By ms, Deputy

DOCUMENT NO. 297513

Statement of Evidence: Northeast Corner Section 6, T.134 N., R.32 W., 5th P.M.

1858 U.S. General Land Office survey set a wood post for this corner and marked the following bearing trees: 8" Sp. Pine S 47°E 10 lks., 8" Sp. Pine S 26°W 12 lks., 10" Sp. Pine N 79°W 28 lks., 9" Sp. Pine N 44°E 45 lks.

1986 On August 25, Terry Freeman, Cass County Survey Technician and Jim Cripps found a 1½" x 16" car spring down 0.3'. Replaced with cast iron monument down 6" and placed car spring on N. side of cast iron. Marked new ties as shown on front of this certificate.

Although there is no record of the found iron, the Cass County Surveyors Office accepts it as a perpetuation of the original government corner.