

CERTIFICATE OF LOCATION OF GOVERNMENT CORNER

Northeast Corner of Section 14, Township 135 N., Range 32 W., 5th P.M.
STATE OF MINNESOTA, County of CASS

At the corner location shown on the sketch:

- On 9/26/85 found a 1 1/2" x 8" I.P. down 0.3' .4' S. of centerline of road
DATE
 (lines up with centerline E & W) in line with fence S. and trail N.
 left monument as found, lowered monument, removed monument (explain)
- On 8/13/86 placed a cast iron monument down 0.6', placed found iron on
DATE
W. side of monument.

SKETCH OF REFERENCE TIES

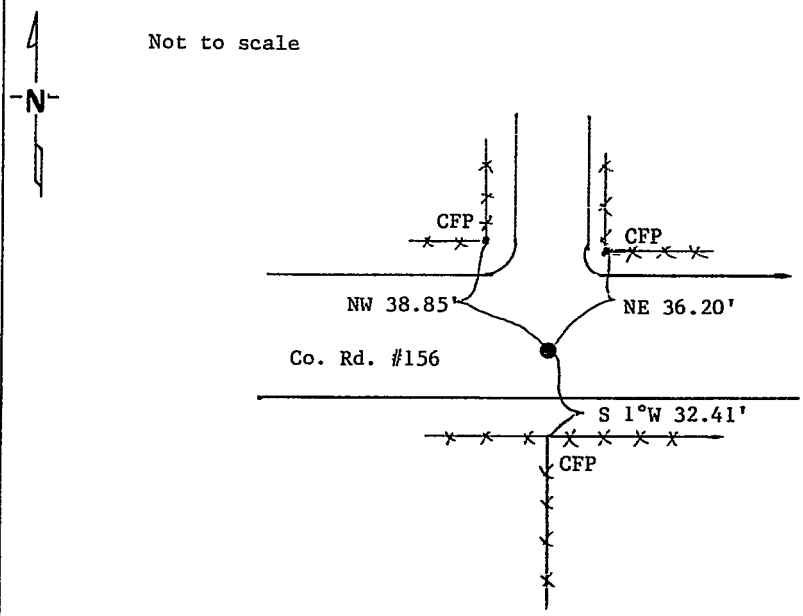

Measurements are to nails in side of object.
Bearings are assumed using 5° declination.

297497

Statement of evidence relative to this corner location is on back of page.

I hereby certify that this document and the data contained herein was prepared by me or under my direct supervision.

William E. Cass 12287
SIGNATURE DATE

Registration No. 11395

- Land Surveyor, Professional Engineer
- County Surveyor, County Engineer

OFFICE OF THE REGISTER OF DEEDS
County of Cass

I hereby certify that this document was filed in the Reg. of Deeds office at 9:10 A.M. on the 12 day of June A.D., 1987

Register of Deeds Claudia Kayler
By m.s. Deputy

DOCUMENT NO. 297497

STATEMENT OF EVIDENCE Northeast Corner Section 14, T.135 N., R.32 W., 5th P.M.

- 1866 U.S. General Land Office survey set a wood post for this corner and marked the following bearing trees: 10" Maple N $1\frac{1}{2}^{\circ}$ E 13 lks., 10" W. Oak N 56° E 58 lks., 14" W. Oak N 21° W 65 lks.
- 1916 County Survey Record Book "C", page 51, shows a survey by E.B. Horst. He found the stump hole of a W. Oak N 21° W and roots of a maple NE and set a $1\frac{1}{2}$ " x 48" I.M. 5" Poplar N $48\frac{1}{2}^{\circ}$ E 90.6', 6" Poplar S $53\frac{1}{2}^{\circ}$ E 99.6'
- 1985 On August 26, Terry Freeman, Cass County Survey Technician, found a $1\frac{1}{2}$ " x 8" I.P. down 0.3', in line with fence S and trail N.
- 1986 On August 13, Terry Freeman and Wade Moser, pulled found I.P. and set a cast iron monument down 0.6'. Placed 8" piece of iron on W. side of monument.