

# CERTIFICATE OF LOCATION OF GOVERNMENT CORNER

Northeast Corner of Section 8, Township 135 N, Range 32 W, 5th P.M.

STATE OF MINNESOTA, County of CASS

At the corner location shown on the sketch:

On 8/30/85 found a 1 1/2" I.P. Flush, at intersection of roads N-S-E  
DATE

left monument as found,  lowered monument,  removed monument (explain)

On \_\_\_\_\_ placed a \_\_\_\_\_  
DATE

Not to scale

### SKETCH OF REFERENCE TIES

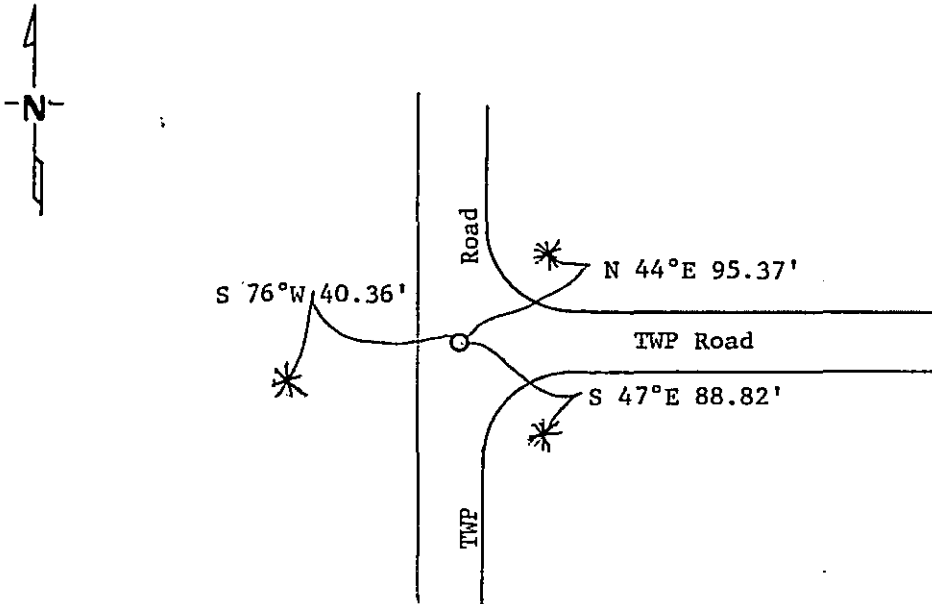

Distances to nail in side of tree  
 Bearings assumed using 5° declination

Statement of evidence relative to this corner location is on back of page. 297166

I hereby certify that this document and the data contained herein was prepared by me or under my direct supervision.

Walter E. Carr 1-22-87  
SIGNATURE DATE

Registration No. 11395

Land Surveyor,  Professional Engineer

County Surveyor,  County Engineer

#### OFFICE OF THE REGISTER OF DEEDS

County of Cass

I hereby certify that this document was filed in the Reg. of Deeds office at 9:35 A.M. on the 1 day of June A.D., 1987

Register of Deeds Clouline Kayler

By MS, Deputy

DOCUMENT NO. 297166

STATEMENT OF EVIDENCE Northeast Corner Section 8, T.135 N., R.32 W., 5th P.M.

- 1866 U.S. General Land Office survey set a wood post for this corner and marked the following bearing trees: 12" Bl. Pine S  $68\frac{1}{2}^{\circ}$ E 17 lks., 14" Bl. Pine N  $27\frac{1}{2}^{\circ}$ E 21 lks., 5" Bl. Pine N  $23^{\circ}$ W 39 lks., 5" Bl. Pine S  $29\frac{1}{2}^{\circ}$ W 21 lks.
- 1985 On August 30, Terry Freeman, Cass County Survey Technician, and Dan Marcum, County Forester, found a  $1\frac{1}{2}$ " I.P., flush, at intersection of roads N-S-E, and marked the following bearings:  
7" Jack Pine S  $47^{\circ}$ E 88.82'  
6" Jack Pine S  $76^{\circ}$ W 40.36'  
5" Jack Pine N  $44^{\circ}$ E 95.37'
- 1986 On July 29, Terry Freeman and Dan Gordon, lowered monument 8", 1985 bearings remain in good condition.

Although there is not a record of the I.P. being set, the Cass County Surveyors Office feels that the found iron is a perpetuation of the original corner position and accepts it as such.