

# CERTIFICATE OF LOCATION OF GOVERNMENT CORNER

North Quarter Corner of Section 2, Township 135 N., Range 32 W., 5th P.M.  
 STATE OF MINNESOTA, County of CASS

At the corner location shown on the sketch:

- On \_\_\_\_\_ found a \_\_\_\_\_  
DATE
- left monument as found,  lowered monument,  removed monument (explain)
- On 8/26/86 placed a cast iron monument in centerline of E-W road, fences  
DATE  
N & S, from State Highway Dept. information.

### SKETCH OF REFERENCE TIES

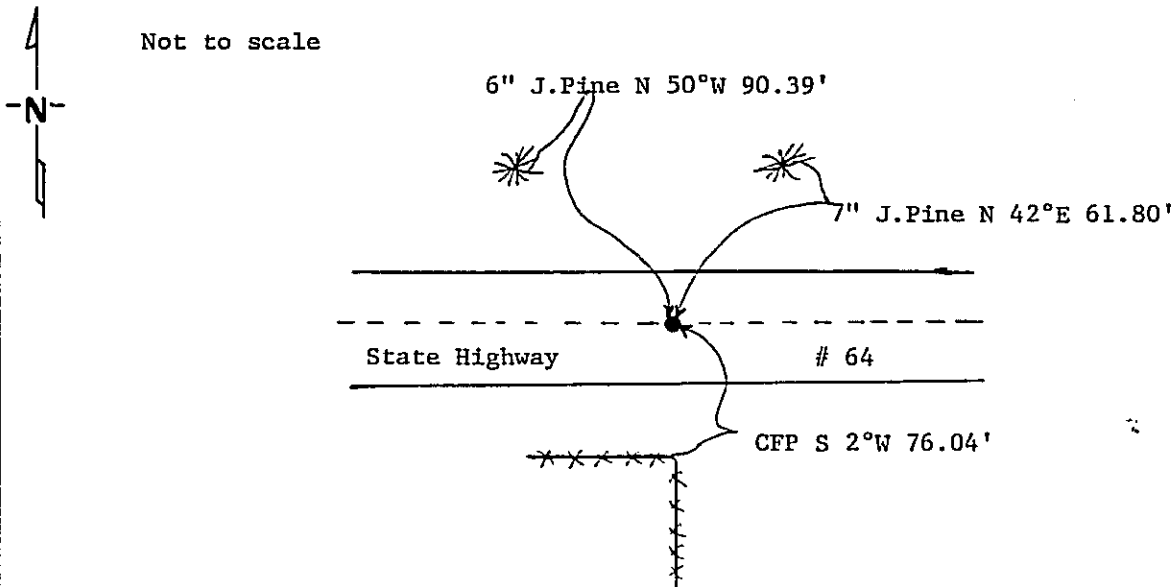

All measurements are to nail in side of tree.  
 Bearings are assumed using 5° declination.

Statement of evidence relative to this corner location is on back of page. 297164

I hereby certify that this document and the data contained herein was prepared by me or under my direct supervision.

Walter E. Carr 1-22-87  
SIGNATURE DATE

Registration No. 11395

- Land Surveyor,  Professional Engineer
- County Surveyor,  County Engineer

OFFICE OF THE REGISTER OF DEEDS  
 County of Cass

I hereby certify that this document was filed in the Reg. of Deeds office at 9:25 A...M. on the 1 day of June A.D., 19 87

Register of Deeds Cloudiva Kayler  
 By ms, Deputy

DOCUMENT NO. 297164

STATEMENT OF EVIDENCE North Quarter Corner Section 2, T.135 N., R.32W., 5th P.M.

- 1858 U.S. General Land Office survey set a wood post for this corner and marked the following bearing trees: 5" Tam N 53°W 5 lks., 30" W. Pine N 18°E 58 lks.
- 1957 Minnesota Dept. of Transportation assumed corner at centerline of E-W road and fences N & S. They set a R.R. spike and marked the following bearings: N & D in CFP South 34.9', N & D in PP SW 83.0', N & D in Fence post NW 92.4'
- 1985 On August 26, Terry Freeman, Cass County Survey Technician, searched for R.R. spike with metal locator, found nothing.
- 1986 On August 26, Terry Freeman and Jim Cripps set a cast iron monument in centerline of State Hwy #64 from State Hwy Dept. information. Fences north and south, monument down 0.1'.