

CERTIFICATE OF LOCATION OF GOVERNMENT CORNER

East Quarter Corner of Section 24, Township 145 N., Range 29 W., 5th P.M.

STATE OF MINNESOTA, County of CASS

At the corner location shown on the sketch:

- On 8-13-86 found a Cast Iron monument set by David Claypool
DATE
- left monument as found, lowered monument, removed monument (explain)
- On 9-4-86 placed a 2" x 60" galv. iron pipe with brass cap and plastic base with embedded magnet.
DATE

SKETCH OF REFERENCE TIES

Not to Scale

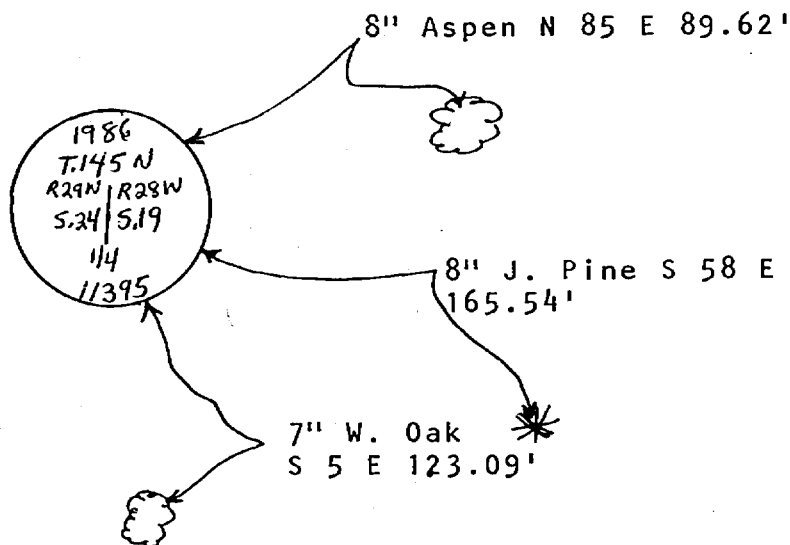
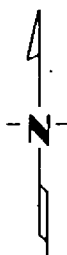

All measurements are to spks. in side of tree, trees are double blazed, scribed and painted red, with USFS 54-3 bearing tree tags attached.

Statement of evidence relative to this corner location is on back of page.

291633

I hereby certify that this document and the data contained herein was prepared by me or under my direct supervision.

Walter E. Kero 9-10-86
SIGNATURE DATE

Registration No. 11395

- Land Surveyor, Professional Engineer
- County Surveyor, County Engineer

OFFICE OF THE COUNTY RECORDER

County of Cass

I hereby certify that this document was filed in the Co. Recorders office at 9:50 A.M. on the 15 day of Sept. A.D., 19 86

County Recorder Claudine Kayler
By ms, Deputy

DOCUMENT NO. 291633

Statement of Evidence: East Quarter Corner Section 24, T. 145 N., R. 29 W.
5th P.M.

- 1873 U.S. Genral Land Office survey set a wood post for this corner and marked the following bearing trees: 7" J. Pine N 13½ E 24 lks., 24" Norway Pine S 74 W 73lks.
- 1968 Bill Okerman, USFS Surveyor, set corner propertionally between the NE and SE Corners of Section 24. He set a 2" x 60" iron pipe with 3" bronze cap and marked new bearing trees: 12" J. Pine N 8 E 45.53', 11" J. Pine N 88W 66.08', 9" Norway Pine S 17 E 92.87'.
- 1979 MN Dept. of Natural Resources survey crew found 2" iron pipe with 3" cap stamped RLS 6807, 1968. They also found an old E-W fence 335' South.
- 1980 David Claypool, RLS, determined that the corner should be set obliterated. Hreset a cast iron monument at a fence corner at corner of old clearing. DNR surveyors and Gary Stevenson, Cass County Surveyor at the time, meet and agree that Claypools position is best.
- 1986 On August 13, Walter E. Curo, finds the cast iron monument set by Claypool and also agrees that this postion is best. Replaced cast iron monument with 2" x 60" galv. iron pipe with brass cap and plastic base with embedded magnet. Mark new bearings: 8" Aspen N 85 E 89.62', 8" J. Pine S 58 E 165.54', 7" White Oak S 5 E 123.09'.