

CERTIFICATE OF LOCATION OF GOVERNMENT CORNER

Northeast Corner of Section 28, Township 144N., Range 25W., 5th P.M.

STATE OF MINNESOTA, County of Cass

At the corner location shown on the sketch:

- On _____ found a _____
DATE
- left monument as found, lowered monument, removed monument (explain)
- On 1-23-1985 placed a 2 1/2" by 5 feet long Galvanized Iron Pipe with 3" Brass Cap
DATE stamped as shown, up 1.50 feet.

5° EAST Declination

SKETCH OF REFERENCE TIES
NOT TO SCALE

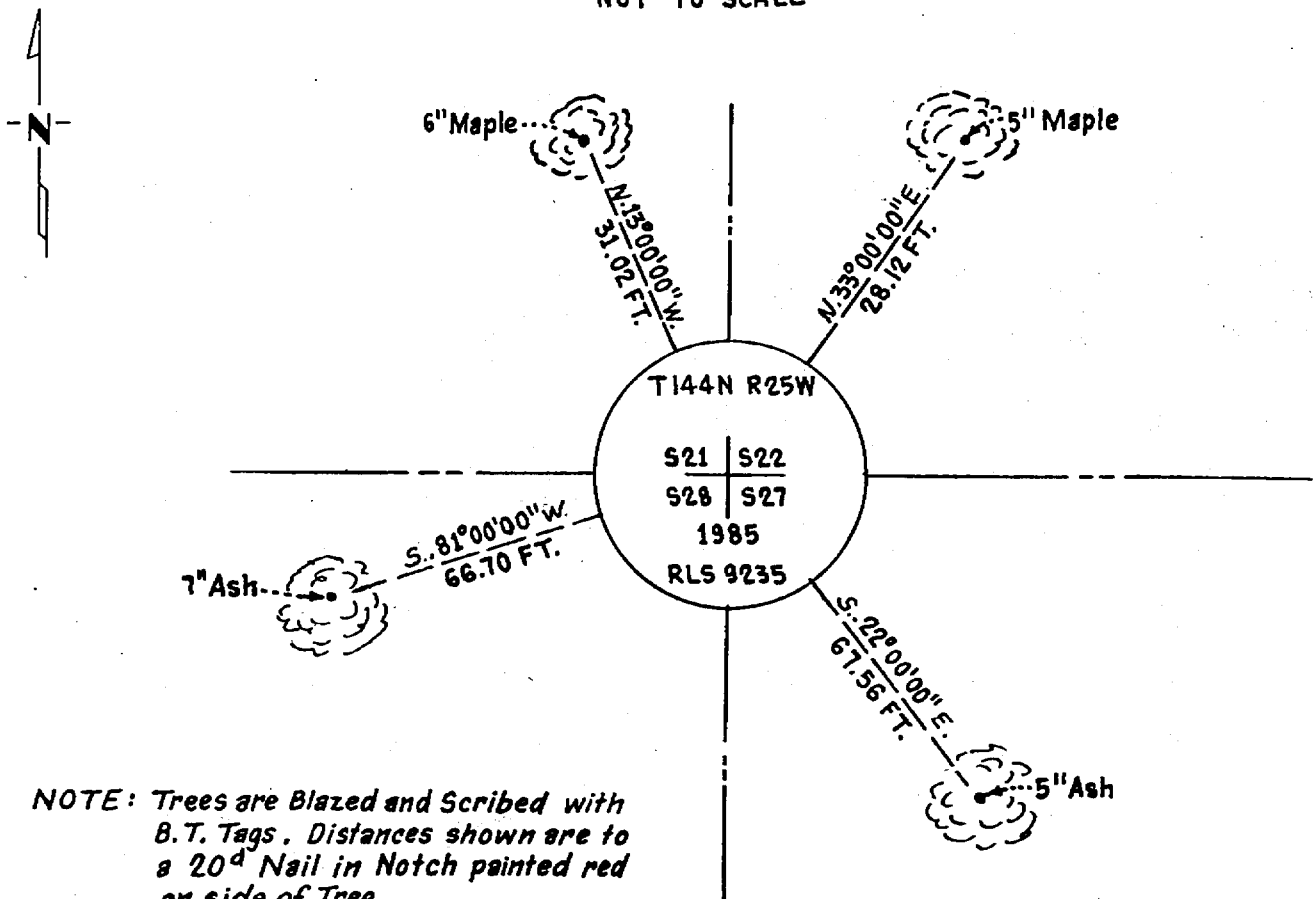

NOTE: Trees are Blazed and Scribed with B.T. Tags. Distances shown are to a 20^d Nail in Notch painted red on side of Tree.

Statement of evidence relative to this corner location is on back of page.

I hereby certify that this document and the data contained herein was prepared by me or under my direct supervision.

James H. Parker 3/29/85
SIGNATURE DATE

Registration No. 9235
 Land Surveyor, Professional Engineer
 County Surveyor, County Engineer

281960
OFFICE OF THE COUNTY RECORDER
County of Cass

I hereby certify that this document was filed in the Co. Recorders office at 10:15 A.M. on the 15 day of May A.D., 1985

County Recorder Claudia Kayler
By MS, Deputy

DOCUMENT NO. 281960

Statement of Evidence:

R13

This corner was originally established in April, 1876, by B.C. Baldwin, Deputy Surveyor. The field notes of that survey are filed in the office of the Secretary of State, St. Paul, Minnesota. Mr. Baldwin's notes state that a post was set to mark the corner and referenced by the following:

- A 7" Aspen that bears N62°E a distance of 23 links [15.18 feet]
- A 6" Ash that bears S51°E a distance of 46 links [30.36 feet]
- A 8" Aspen that bears S64°W a distance of 4 links [2.64 feet]
- A 4" Maple that bears N21°W a distance of 12 links [7.92 feet]

On July 1, 1984, personnel from Advance Surveying & Engineering Co. made a thorough search for this corner and the above mentioned references but to no avail.

On January 23, 1984, an additional search was made by Advance prior to reestablishing this corner by Double proportionate methods between the Northeast corner of Section 21 and the Southeast corner of Section 28 and between the Northwest corner of Section 28 and the North Quarter corner of Section 26.