

# CERTIFICATE OF LOCATION OF GOVERNMENT CORNER

Northeast Corner of Section 23, Township 144 N., Range 25 W., 5th P.M.

STATE OF MINNESOTA, County of Cass

At the corner location shown on the sketch:

- On \_\_\_\_\_ found a \_\_\_\_\_  
DATE
- left monument as found,  lowered monument,  removed monument (explain)
- On 1-24-1985 placed a 5/8" by 5 feet long Aluminum Rod with 3" Aluminum Cap  
DATE  
stamped as shown, up 0.70 feet.

5° East Declination

SKETCH OF REFERENCE TIES  
NOT TO SCALE

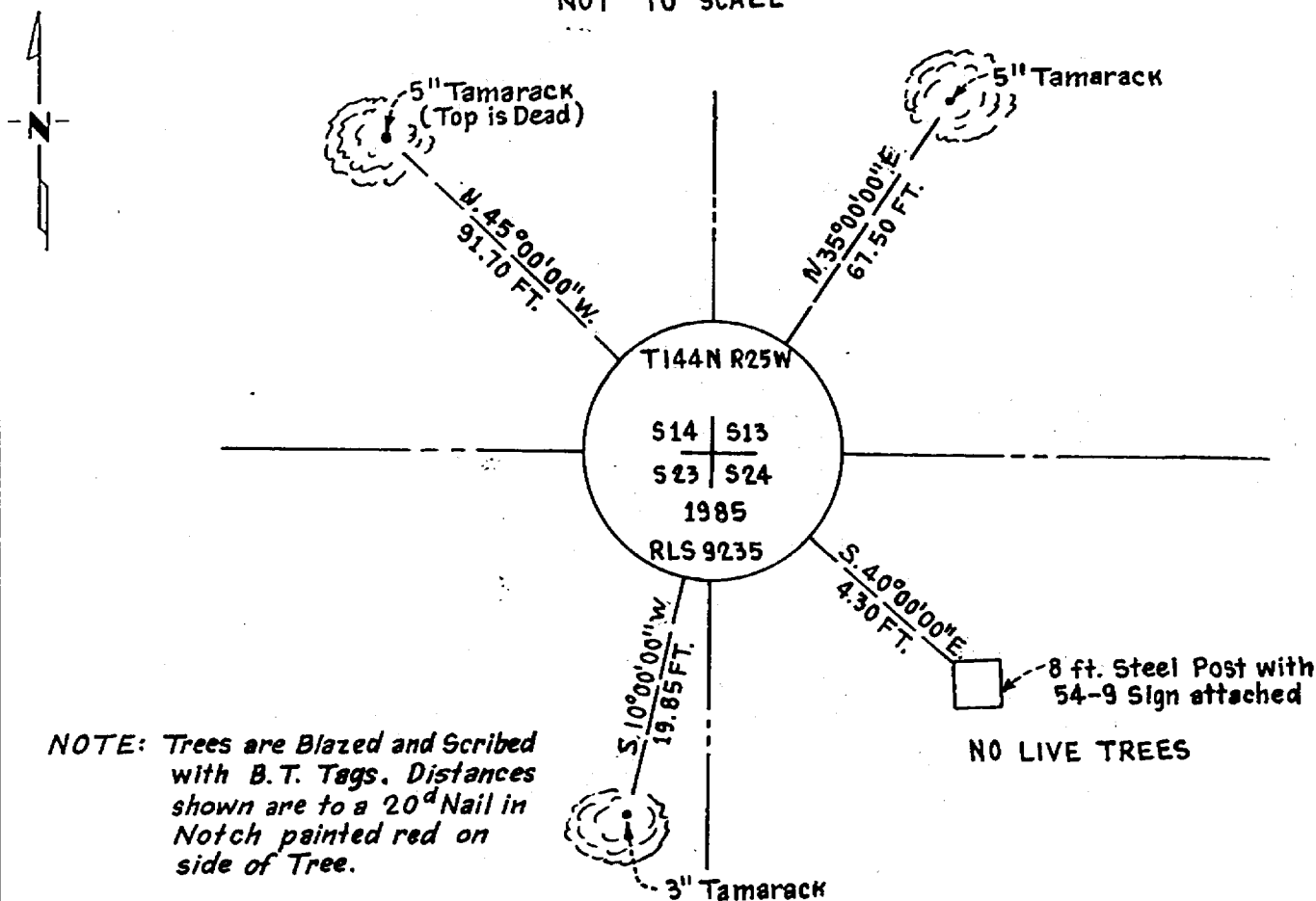

Statement of evidence relative to this corner location is on back of page.

I hereby certify that this document and the data contained herein was prepared by me or under my direct supervision.

James H. Parker 3/29/85  
SIGNATURE DATE

Registration No. 9235  
 Land Surveyor,  Professional Engineer  
 County Surveyor,  County Engineer

281946  
 OFFICE OF THE COUNTY RECORDER  
 County of Cass

I hereby certify that this document was filed in the Co. Recorders office at 2:05 A .M. on the 15 day of May A.D., 1985  
 County Recorder Candice Kaylor  
 By MS, Deputy

DOCUMENT NO. 281946

Statement of Evidence:

N21

This corner was originally established in April, 1876, by B.C. Baldwin, Deputy Surveyor. The field notes of that survey are filed in the office of the Secretary of State, St. Paul, Minnesota. Mr. Baldwin's notes state that a post was set to mark the corner and referenced by the following:

- A 5" Tamarack that bears N19°E a distance of 13 links [8.54 feet]
- A 5" Tamarack that bears S2°E a distance of 22 links [14.54 feet]
- A 5" Tamarack that bears S64°W a distance of 13 links [8.54 feet]
- A 5" Tamarack that bears N55°W a distance of 13 links [8.54 feet]

In 1900, A Map of survey by the Corps of Engineers shows that they found the corner.

On August 31, 1984, personnel from Advance Surveying & Engineering Co. made a thorough search for this corner and the above mentioned references but to no avail. This area is all Tamarack swamp, with trees approximately 2" to 3" diameter.

On January 24, 1985, an additional search was made by Advance prior to reestablishing this corner by Obliterated methods by using coordinate position determined from Corps of Engineers Survey done in 1900.