

CERTIFICATE OF LOCATION OF GOVERNMENT CORNER

Northeast Corner of Section 21, Township 144 N., Range 25 W., 5th P.M.

STATE OF MINNESOTA, County of Cass

At the corner location shown on the sketch:

- On _____ found a _____
DATE
- left monument as found, lowered monument, removed monument (explain)
- On 12-20-1984 placed a 5/8" by 5 feet long Aluminum Rod with 3" Aluminum Cap
DATE
stamped as shown.

5° EAST Declination

SKETCH OF REFERENCE TIES
NOT TO SCALE

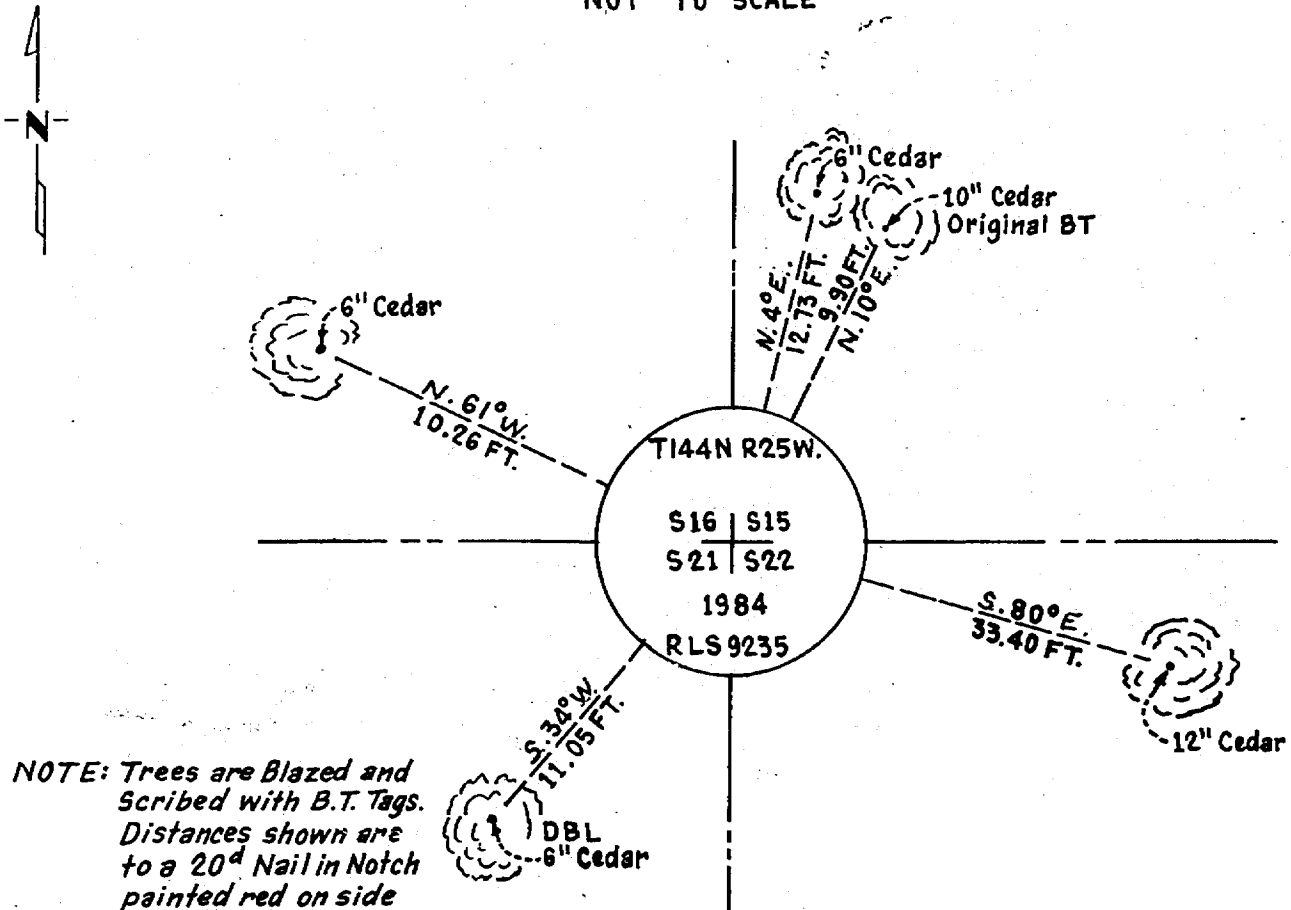

NOTE: Trees are Blazed and Scribed with B.T. Tags. Distances shown are to a 20^d Nail in Notch painted red on side of Tree.

Statement of evidence relative to this corner location is on back of page.

I hereby certify that this document and the data contained herein was prepared by me or under my direct supervision

James H. Parker 3/29/85
SIGNATURE DATE

Registration No. 9235

- Land Surveyor, Professional Engineer
- County Surveyor, County Engineer

281807
OFFICE OF THE COUNTY RECORDER
County of Cass

I hereby certify that this document was filed in the Co. Recorders office at 3:00 P.M. on the 8 day of May A.D., 1985

County Recorder Claudia Kayler
By MS, Deputy

DOCUMENT NO. 281807

Statement of Evidence:

N13

This corner was originally established in April, 1876, by B.C. Baldwin, Deputy Surveyor. The field notes of that survey are filed in the office of the Secretary of State, St. Paul, Minnesota. Mr. Baldwin's notes state that a post was set to mark the corner and referenced by the following:

- A 5" Cedar that bears N10°E a distance of 15 links [9.90 feet]
- A 6" Tamarack that bears S89°E a distance of 22 links [14.52 feet]
- A 6" Cedar that bears S38°W a distance of 36 links [23.76 feet]
- A 6" Tamarack that bears N65°W a distance of 9 links [5.94 feet]

On March 15, 1984, personnel from Advance Surveying & Engineering Co. made a thorough search for this corner and the above mentioned references. We find an original Bearing Tree. The upper blaze is open and scribing visible. No trace of other Bearing Trees.

On December 20, 1984, an additional search was made by Advance prior to reestablishing this corner from the found Bearing Tree. The Bearing Tree used bears N10°E a distance of 9.90 feet from the corner, as shown on the sketch.