

# CERTIFICATE OF LOCATION OF GOVERNMENT CORNER

North Quarter Corner of Section 14, Township 144 N., Range 25 W., 5th P.M.

STATE OF MINNESOTA, County of Cass

At the corner location shown on the sketch:

- On \_\_\_\_\_ found a \_\_\_\_\_  
DATE
- left monument as found,  lowered monument,  removed monument (explain)
- On 1-12-1985 placed a 5/8" by 10 feet long Aluminum Rod with 3" Aluminum Cap  
DATE  
stamped as shown up 1.5 feet.

5° EAST Declination

SKETCH OF REFERENCE TIES  
 NOT TO SCALE

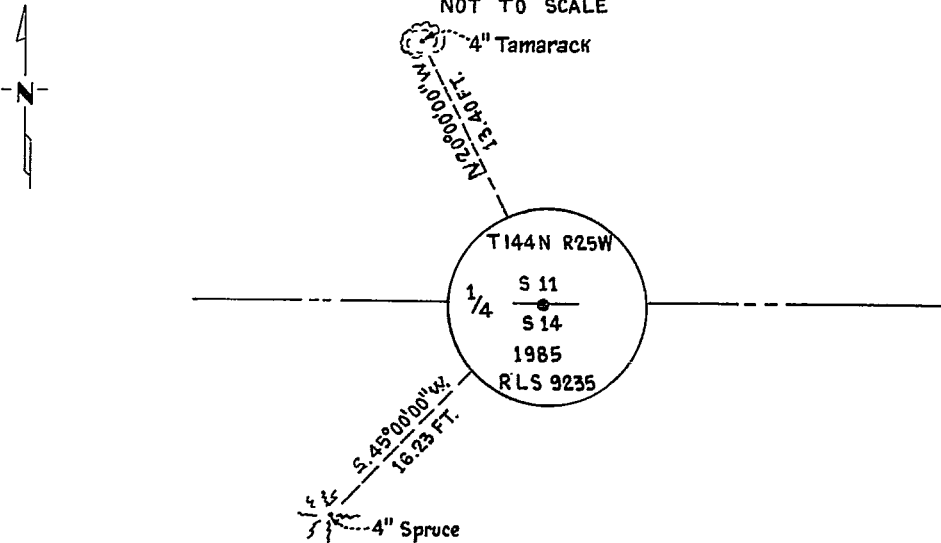

NOTE: Trees are blazed and scribed with B. T. Tags. Distances shown are to a 20<sup>d</sup> Nail in notch on side of tree.

Statement of evidence relative to this corner location is on back of page.

I hereby certify that this document and the data contained herein was prepared by me or under my direct supervision.

James H. Parker 3/20/85  
SIGNATURE DATE

- Registration No. 9235
- Land Surveyor,  Professional Engineer
- County Surveyor,  County Engineer

281712  
 OFFICE OF THE COUNTY RECORDER  
 County of Cass

I hereby certify that this document was filed in the Co. Recorders office at 2:40 P. M. on the 3 day of May A.D., 1985

County Recorder Chandler Kayler  
 By MS, Deputy

DOCUMENT NO. 281712

Statement of Evidence:

J19.

This corner was originally established in April, 1876, by B.C. Baldwin, Deputy Surveyor. The field notes of that survey are filed in the office of the Secretary of State, St. Paul, Minnesota. Mr. Baldwin's notes state that a post was set to mark the corner and referenced by the following:

A 5" Tamarack that bears N28°E a distance of 32 links [21.12 feet]  
A 5" Tamarack that bears S30°E a distance of 38 links [25.08 feet]

In 1900, A Map of survey by the Corps of Engineers shows that they found the corner.

On August 3, 1984, personnel from Advance Surveying & Engineering Co. made a thorough search for this corner and the above mentioned references but to no avail. This area is all Tamarack swamp.

On January 12, 1985, an additional search was made by Advance prior to reestablishing this corner position as determined from Corps of Engineers Survey done in 1900. ( by obliterated method )