

# CERTIFICATE OF LOCATION OF GOVERNMENT CORNER

West Quarter \_\_\_\_\_ Corner of Section 12, Township 144 N., Range 25 W., 5th P.M.

STATE OF MINNESOTA, County of Cass

At the corner location shown on the sketch:

- On \_\_\_\_\_ found a \_\_\_\_\_  
DATE
- left monument as found,  lowered monument,  removed monument (explain)
- On 1-23-1985 placed a 5/8" by 8 feet long Aluminum Rod with 3" Aluminum Cap  
DATE  
stamped as shown up 1.0 foot.

5° EAST Declination

SKETCH OF REFERENCE TIES  
NOT TO SCALE

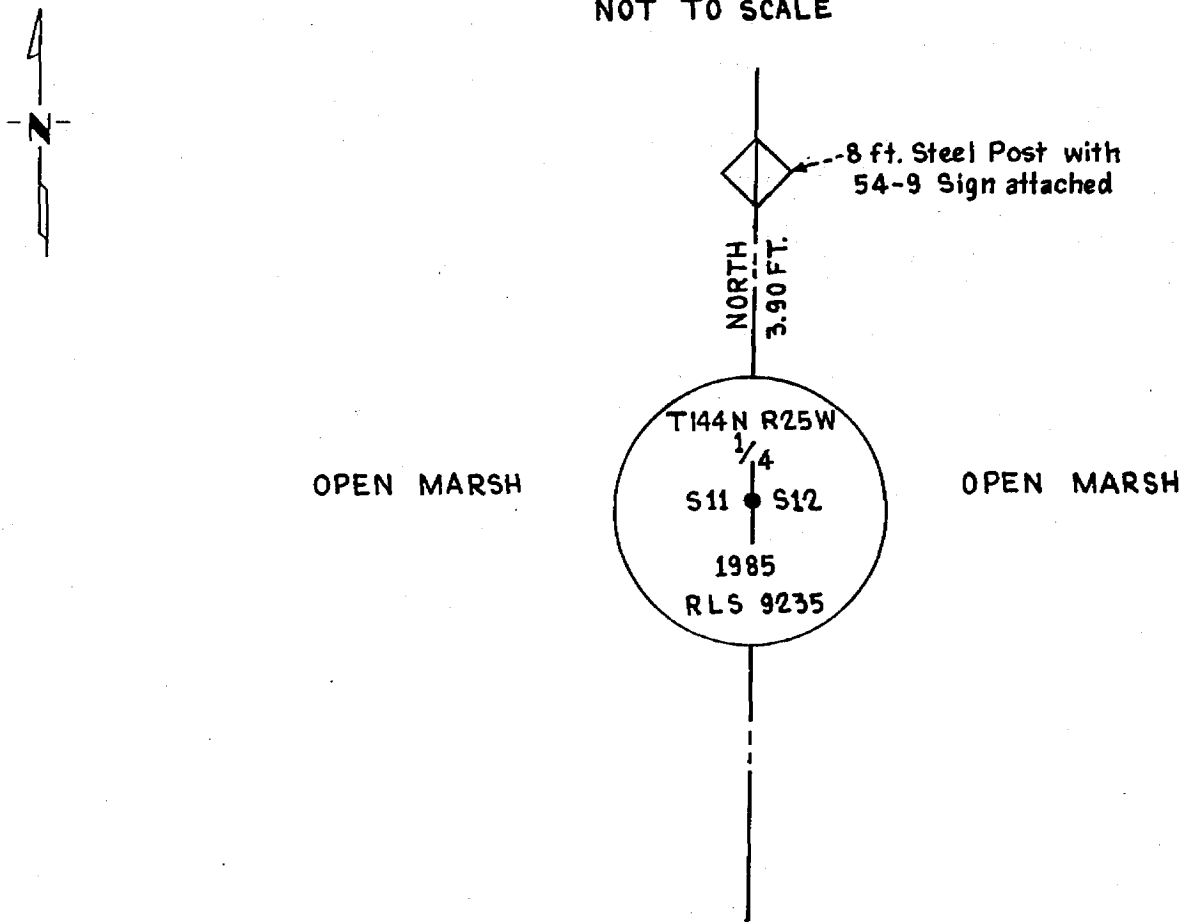

Statement of evidence relative to this corner location is on back of page.

I hereby certify that this document and the data contained herein was prepared by me or under my direct supervision.

James H. Parker 3/29/85  
SIGNATURE DATE

Registration No. 9235  
 Land Surveyor,  Professional Engineer  
 County Surveyor,  County Engineer

281677  
 OFFICE OF THE COUNTY RECORDER  
 County of Cass

I hereby certify that this document was filed in the Co. Recorders office at 4:20 P. M. on the 2 day of May A.D., 1985

County Recorder Claudia Kaylor  
 By MS, Deputy

DOCUMENT NO. 281677

Statement of Evidence:

G21

This corner was originally established in April, 1876, by B.C. Baldwin, Deputy Surveyor. The field notes of that survey are filed in the office of the Secretary of State, St. Paul, Minnesota. Mr. Baldwin's notes state that a post was set to mark the corner and no trees for reference.

On August 6, 1984, personnel from Advance Surveying & Engineering Co. made a thorough search for this corner but to no avail. This search area is now an open Marsh.

On January 23, 1985, an additional search was made by Advance prior to reestablishing this corner at its "lost" position on line between adjacent section corners and the distance is prorated between the Northeast corner of Section 2 and the Southeast corner of Section 11.