

# CERTIFICATE OF LOCATION OF GOVERNMENT CORNER

EAST QUARTER Corner of Section 31, Township 141 N, Range 31 W, 5th P.M.

STATE OF MINNESOTA, County of Cass

At the corner location shown on the sketch:

- On 10/13/84 found a 2½ inch by 5 foot long galvanized pipe with a 3 inch brass cap, stamped as shown, up 18 inches.  
DATE
- left monument as found,  lowered monument,  removed monument (explain)
- On \_\_\_\_\_ placed a \_\_\_\_\_  
DATE

5¼° East declination

### SKETCH OF REFERENCE TIES

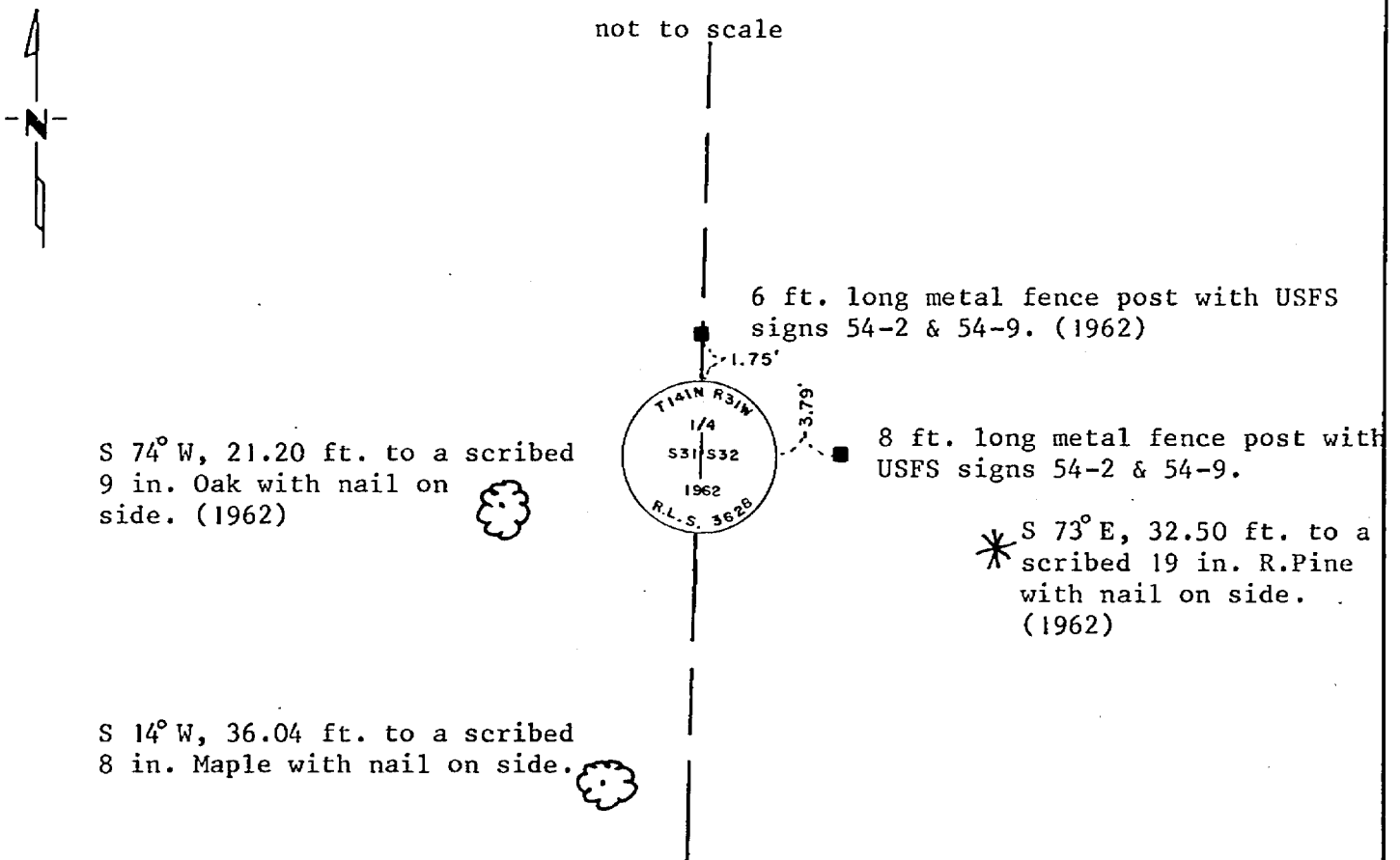

Statement of evidence relative to this corner location is on back of page.

I hereby certify that this document and the data contained herein was prepared by me or under my direct supervision.

Anthony E. Kerich 12/12/84  
SIGNATURE DATE

Registration No. 12266

Land Surveyor,  Professional Engineer

County Surveyor,  County Engineer

280494  
 OFFICE OF THE REGISTER OF DEEDS  
 County of Cass

I hereby certify that this document was filed in the Reg. of Deeds office at 9:55 A.M. on the 25 day of February A.D., 19 85

Register of Deeds Claudine Kayler  
 By MS Deputy

DOCUMENT NO. 280494

Statement of Evidence:

EAST QUARTER CORNER OF SECTION 31, TOWNSHIP 141 NORTH,  
RANGE 31 WEST OF THE 5th PRINCIPAL MERIDIAN.

1873 - The original Public Land Survey was run by P.H. Conger. A wood post was set to mark the corner and two bearing trees were recorded as accessories:

5" Soft Maple N 70°E 15 links ( 9.90' )  
6" Lynn S 16°W 19 links (12.54' )

1921 - Elmer B. Horst Deputy Cass County Surveyor subdivided Section 31. He found a Birch stump blazed by unknown surveyor to  $\frac{1}{4}$  corner. Appeared to coincide with  $\frac{1}{4}$  corner according to his Survey. Set iron pipe to mark corner Record Book C, page 453.

1962 - Peter J. Meyer R.L.S. found the iron pipe set by Horst in 1921. replaced iron with 2" x 5' galvanized pipe with 3" stamped brass capped monument and recorded new corner accessories: Certificate filed 12/10/62 Document # 84, in book of Corner Certificates in Cass County Recorder's office.

19" R. Pine S 73°E 32.5 ft.  
9" Oak S 74°W 21.2 ft.  
72" metal fence post North 1.75 ft.

1984 - Kerick Surveying, Inc., Bemidji, MN. found 3 inch stamped brass capped monument set by Peter J. Meyer in 1962. Subdivided Section 31 for the U.S. Forest Service we accepted this monument as found for lack of any other information. Also found his corner accessories ok. and set new accessories that appear on this certificate.