

CERTIFICATE OF LOCATION OF GOVERNMENT CORNER

NORTH QUARTER Corner of Section 31, Township 141 N, Range 31 W, 5th P.M.

STATE OF MINNESOTA, County of Cass

At the corner location shown on the sketch:

On 10/25/84 found a 2½ inch by 5 foot galvanized pipe with a 3 inch brass cap, stamped as shown, up 26 inches.

left monument as found, lowered monument, removed monument (explain)

On _____ placed a _____
DATE

5¼° East declination

SKETCH OF REFERENCE TIES

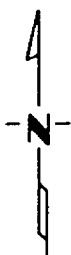

N 46°W, 109.9 ft to _____ not to scale
a 10 in. ash (1959) scribed, now laying dead.

N 53°W, 45.15 ft. to a scribed
* 7 in. Tamarac with nail on side.

N 70°E, 46.65 ft. to a scribed 7 in. Ash (1959) now a 12 in. with nail on side.

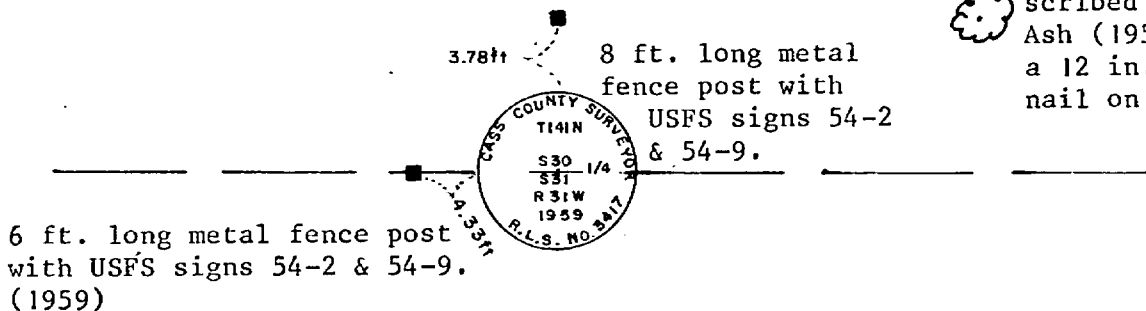

Statement of evidence relative to this corner location is on back of page.

I hereby certify that this document and the data contained herein was prepared by me or under my direct supervision.

Anthony E. Kerich 12/10/84
SIGNATURE DATE

Registration No. 12266

Land Surveyor, Professional Engineer

County Surveyor, County Engineer

280489

OFFICE OF THE REGISTER OF DEEDS
County of Cass

I hereby certify that this document was filed in the Reg. of Deeds office at 9:30 A.M. on the 25 day of February A.D., 19 85

Register of Deeds Claudine Kayler
By MS Deputy

DOCUMENT NO. 280489

Statement of Evidence:

NORTH QUARTER CORNER OF SECTION 31, TOWNSHIP 141 NORTH,
RANGE 31 WEST OF THE 5th PRINCIPAL MERIDIAN.

1873 - The original Public Land Survey was run by P.H. Conger. A wood post was set to mark the corner and two bearing trees were recorded as accessories:

5" Birch N 07°E 19 links (12.54')
7" Oak S 19°W 23 links (15.18')

1921 - Elmer B. Horst Deputy Cass County Surveyor subdivided Sections 30 and 31. He found no evidence of the original corner or its accessories. Set a 2" X 48" iron at lost proportioned distance. Record Book C, page 452.

1959 - Harold Curo Cass County Surveyor found the 2" x 48" iron set by Horst in 1921. He replaced 2 inch iron with a stamped 3 inch brass capped monument and recorded three new accessories: Certificate filed 3/22/60 Document # 31,

in book of Corner Certificates in Cass County Recorder's office.

7" Ash	N 69°30' E	46.65 ft.
10" Ash	N 46°11' W	109.90 ft.
4" Tamarack	S 31°18' E	70.35 ft.

1984 - Kerick Surveying, Inc., Bemidji, MN. found the 3 inch stamped brass capped monument set by Curo in 1959. Used this monument as found in subdividing Sections 30 and 31 for the U.S. Forest Service. Also found the accessories marked by Curo. The NW bearing tree was lying dead remarked his bearing trees and set one new bearing tree and metal fence post that appear on this certificate.