

# CERTIFICATE OF LOCATION OF GOVERNMENT CORNER

Northwest Corner of Section 30, Township 141 N., Range 31 W., 5th P.M.

STATE OF MINNESOTA, County of Cass

At the corner location shown on the sketch:

- On 8/27/84 found a 1 1/2" iron pipe up 8"  
DATE
- left monument as found,  lowered monument,  removed monument (explain)
- On 12/5/84 placed a 2 1/2 inch by 30" galvanized pipe with a 3 inch brass cap  
DATE  
stamped as shown, flush with ground.

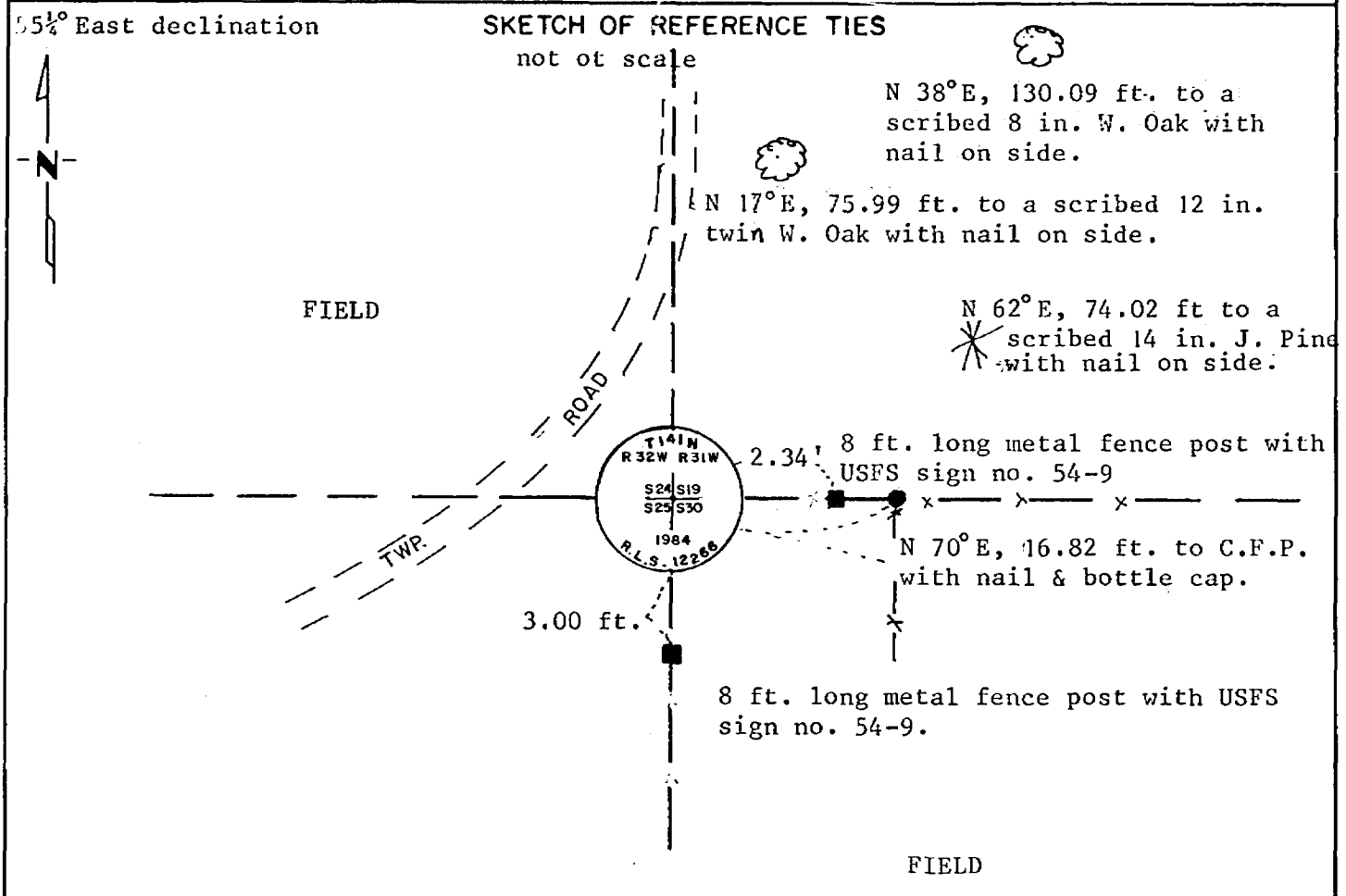

Statement of evidence relative to this corner location is on back of page.

I hereby certify that this document and the data contained herein was prepared by me or under my direct supervision.

Anthony E. Kerich 12/10/84  
SIGNATURE DATE

Registration No. 12266

- Land Surveyor,  Professional Engineer
- County Surveyor,  County Engineer

280483  
OFFICE OF THE REGISTER OF DEEDS  
County of Cass

I hereby certify that this document was filed in the Reg. of Deeds office at 9:10 A.M. on the 25 day of February A.D., 1985

Register of Deeds Claudia Kayler  
By MS Deputy

DOCUMENT NO. 280483

Statement of Evidence:

NORTHWEST CORNER SECTION 30, TOWNSHIP 141 NORTH,  
RANGE 31 WEST OF THE 5th PRINCIPAL MERIDIAN.

1871 - The original Public Land Survey was run by G. R. Stuntz. A wood post was set to mark the corner and 4 bearing trees were recorded as accessories:

9" Aspen N 80°E 13 links (8.58')  
9" Aspen S 65°E 16 links (10.56')  
6" W. Pine S 43°W 19 links (12.54')  
6" W. Pine N 70°W 10 links (6.60')

1921 - Elmer B. Horst Deputy Cass County Surveyor resurveyed Section 30 he found a 2½" x 48" capped iron monument set by Hubbard County Surveyor's from the original bearing trees. See Cass County Record Book C, page 445.

1967 - D.N.R. Engineering found  
1967 - D.N.R. Engineering found a iron monument in place set 2 bearing trees.

7" Oak N-NE 52.45 ft. nail and bottle cap  
Corner Fence Post East 16.52 ft. nail and Bottle cap

1984 - Kerick Surveying, Inc. Bemidji, MN, found 1½ inch iron pipe up 8 inches, no trace of 2½ in. capped monument as referred to in 1921 survey. Found the two remaining corner accessories from 1967 search, ties check but are in poor condition. After a subdivision of Section 30 there was no doubt that this corner was in the location that the Hubbard County Surveyor perpetuated in 1921. Replaced 1½ in. iron pipe with U.S.F.S. monument and recorded three new accessories that appear on this certificate.