

# CERTIFICATE OF LOCATION OF GOVERNMENT CORNER

NORTHEAST Corner of Section 18, Township 140 N., Range 27 W., 5<sup>th</sup> P.M.

STATE OF MINNESOTA, County of CASS

At the corner location shown on the sketch:

- On 10-9-84 found a 1 1/2" OUTSIDE DIAMETER WELL POINT WITH 2" CAP,  
UP 1.0'  
 left monument as found,  lowered monument,  removed monument (explain)
- On \_\_\_\_\_ placed a \_\_\_\_\_  
DATE

### SKETCH OF REFERENCE TIES

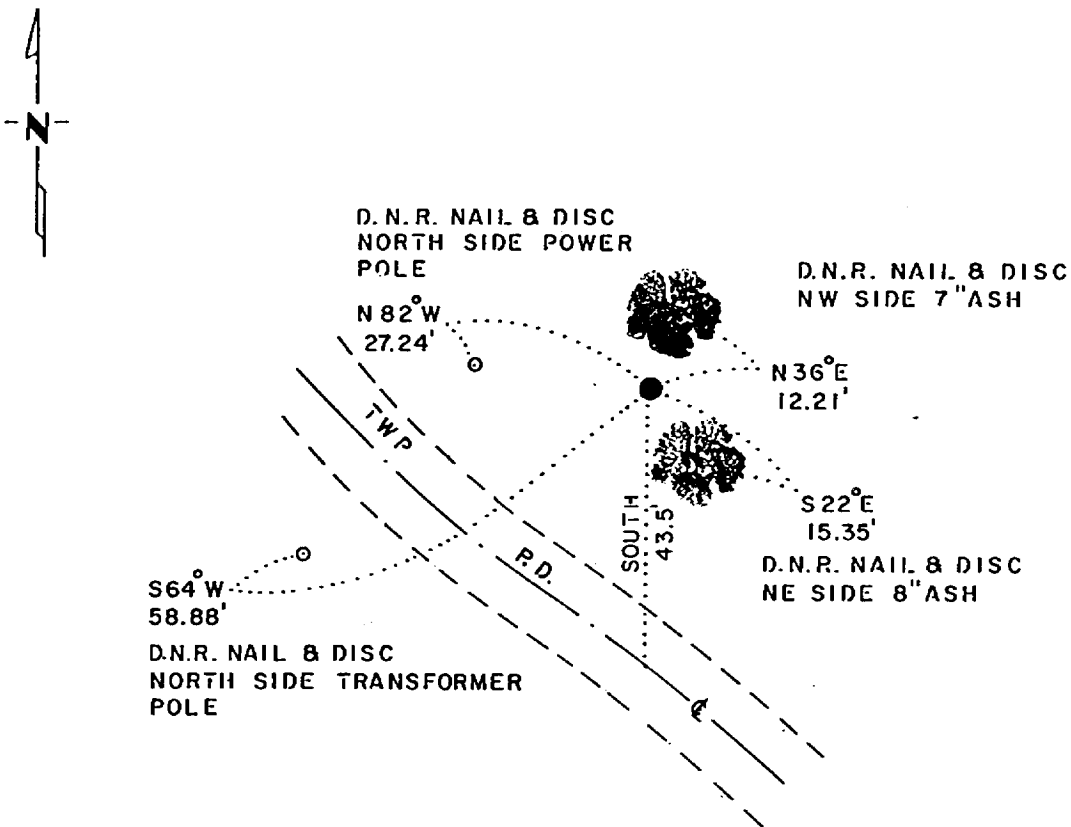

#### BEARINGS OBSERVED WITH COMPASS

Statement of evidence relative to this corner location is on back of page.

J. B. M. 12-6-84  
A-1117

I hereby certify that this document and the data contained herein was prepared by me or under my direct supervision.

Bert R. Eucland 1-16-85  
SIGNATURE DATE

Registration No. 10516

- Land Surveyor,  Professional Engineer
- County Surveyor,  County Engineer

280020  
OFFICE OF THE COUNTY RECORDER

County of Cass

I hereby certify that this document was filed in the Co. Recorders office at 10:00 A.M. on the 18 day of January A.D., 1985

County Recorder Clonine Kaylor

By MS, Deputy

DOCUMENT NO. 280020

Northeast Corner Section 18, Township 140 North, Range 27 West

This corner was originally established by the U. S. General Land Office in 1873. The government notes show corner marked with a wood post with the following bearing trees marked:

- 7" Basswood, South 15° 30' East, 13 links (8.58 feet)
- 10" Ironwood, North 17° 30' East, 17 links (11.22 feet)
- 12" Basswood, South 45° 30' East, 45 links (29.70 feet)
- 9" Ironwood, North 40° 00' West, 37 links (24.42 feet)

In August 1984, the DNR Bureau of Engineering contacted the Cass County Offices of the Surveyor and Assessor for corner information.

The following information was obtained from the County Surveyor's Office:

County Survey Book B, Pages 132 through 134 contain a survey made by John W. Curo, County Surveyor, in 1906. Survey shows that the northeast GLO bearing tree was found and a section corner stake was set from it.

County Survey Book A, Pages 504 and 505 contain a survey made by John. W. Curo, County Surveyor, in 1912. Survey shows that three GLO bearing trees were found and a 3 inch by 3 inch by 36 inch Ash stake was set from them. The following tie trees were marked "New B.T.":

- 12" Basswood, North 30° West, 28.95 feet
- 14" Basswood, North 51° East, 1.65 feet
- 8" Basswood, South 11° East, 7.85 feet
- 12" Elm, South 87° West, 13.60 feet

A Cass County Land Corner Record Card obtained from the County Surveyor's Office shows the following:

Field Book 6, Page 62 of Civilian Conservation Corps notes obtained from Washburn Lake Forestry Headquarters shows that in 1938 a 3 inch square post with scribing was found at corner.

Microfilm Roll Number 15 obtained from the County Surveyor's Office shows the following:

Field Book 243, Pages 88 through 95 contain a survey made by Harold Curo in 1949. Survey shows corner but does not indicate what was found or set. Corner is shown:

- 2586.02 feet from the north quarter corner of Section 17
- 5173.74 feet from the northeast corner of Section 17

The following information was obtained from the County Surveyor's Office:

A survey for a roadway easement in the northwest quarter of the northwest quarter of Section 17 done by Roger A. Mustonen, RLS #11946, in 1982, shows that an iron monument was found at corner.

In October 1984, the DNR Bureau of Engineering traversed to the area of the corner and found a 1½ inch outside diameter well point with a 2 inch cap on top. Searched for but did not find the GLO bearing trees or the 1912 tie trees. The well point was found to be:

- 2585.34 feet from the north quarter corner of Section 17
- 5171.59 feet from the northeast corner of Section 17

Accept the well point as the location of the original government corner.

Traverse information is available from the DNR Bureau of Engineering.