

CERTIFICATE OF LOCATION OF GOVERNMENT CORNER

CENTER QUARTER Corner of Section 19, Township 141, Range 27, 5th P.M.

STATE OF MINNESOTA, County of CASS

At the corner location shown on the sketch:

- On 10/14/80 found a GLO brass cap monument as set in 1919.
DATE
- left monument as found, lowered monument, removed monument (explain)
- On _____ placed a _____
DATE

SKETCH OF REFERENCE TIES

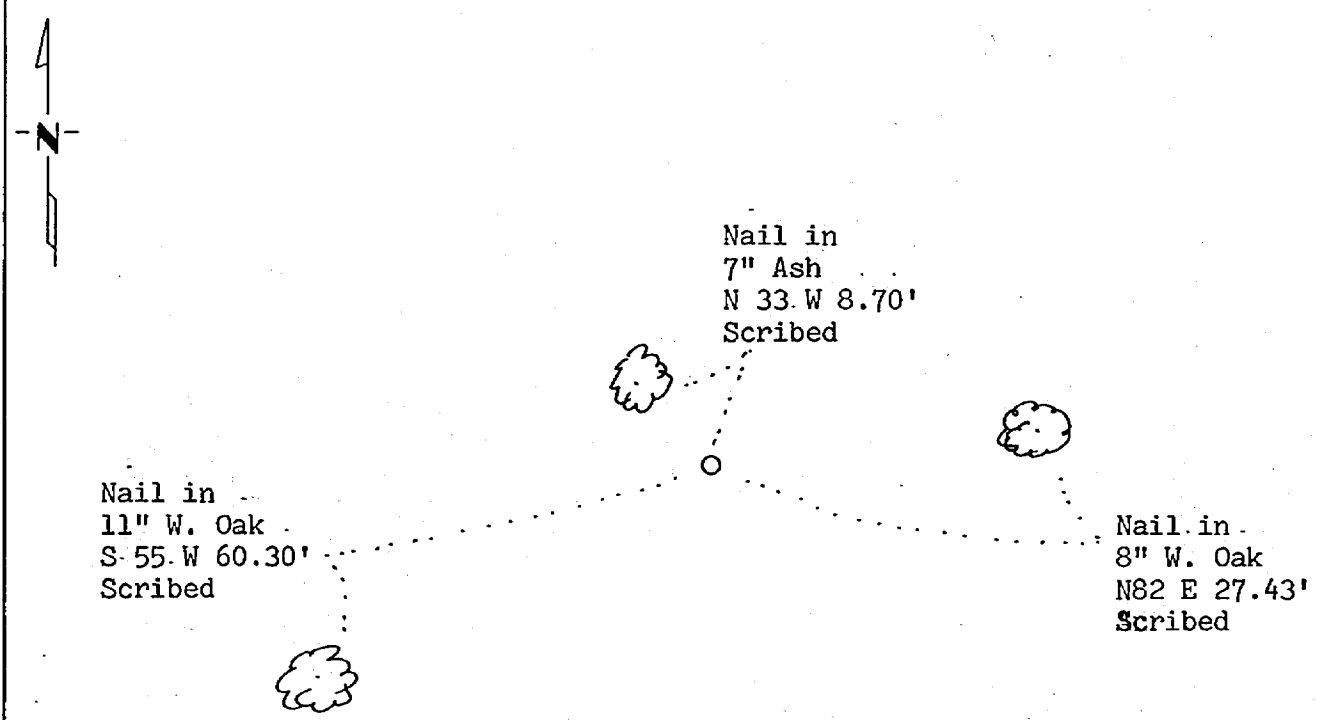

BEARINGS ARE APPROXIMATE

Statement of evidence relative to this corner location is on back of page.

I hereby certify that this document and the data contained herein was prepared by me or under my direct supervision.

Mary H. Stevenson 9-15-82
SIGNATURE DATE

Registration No. 12684

Land Surveyor, Professional Engineer

County Surveyor, County Engineer

279335
OFFICE OF THE COUNTY RECORDER
County of Cass

I hereby certify that this document was filed in the Co. Recorders office at 2:15 A .M. on the 10 day of Dec. A.D., 19 84

County Recorder Claudia Kaylor
By MS, Deputy

DOCUMENT NO. 229335

Statement of Evidence:

- 1919 U.S. General Land Office dependent resurvey established this corner and an iron pipe with a marked brass cap was set to mark the corner. The following bearing trees were marked: 8" Basswood N 40-30 E 34 links and 10" Ash S 27 W 52 links.
- 1922 County Surveyor's Record Book D page 75 show survey by J.H. Flynn. Notes show government iron found.
- 1980 U.S. Forest Service technician C. Krause found the corner monumented with a GLO brass cap monument in good condition up 12". The following bearing trees were found: 27" Ash N 43 W 34.3' with overgrown scar and old Basswood stump with four sprouts N 41 E 22.4'. Three new bearing trees were marked and are shown on this certificate.
- 1982 Analysis of the above data indicates that the location of this Government corner has been perpetuated. I accepted the monument as marking the corner location as when set in 1919 by the GLO resurvey based on bearing tree evidence.