

# CERTIFICATE OF LOCATION OF GOVERNMENT CORNER

Northeast Corner of Section 11, Township 140, Range 25, 5th P.M.  
STATE OF MINNESOTA, County of CASS

At the corner location shown on the sketch:

- On \_\_\_\_\_ found a \_\_\_\_\_  
DATE
- left monument as found,  lowered monument,  removed monument (explain)
- On 5-8-84 placed a 2" x 2" x 36" steel post with aluminum cap in hole  
DATE  
of old corner fence post.

## SKETCH OF REFERENCE TIES

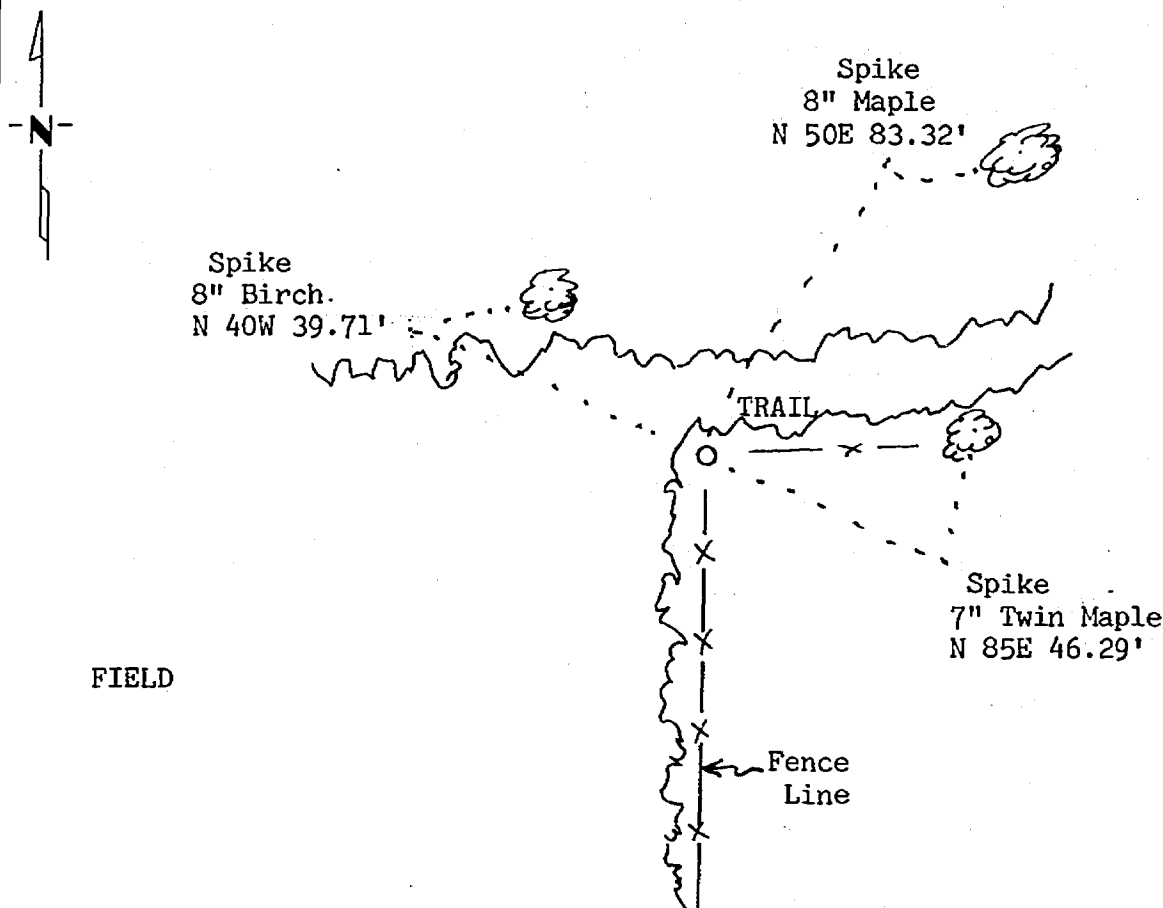

Magnetic Bearings are approximate

Statement of evidence relative to this corner location is on back of page.

I hereby certify that this document and the data contained herein was prepared by me or under my direct supervision.

Mary A. Stevenson 6-6-84  
SIGNATURE DATE

Registration No. 12684

- Land Surveyor,  Professional Engineer
- County Surveyor,  County Engineer

275705  
OFFICE OF THE COUNTY RECORDER  
County of Cass

I hereby certify that this document was filed in the Co. Recorders office at 3:00 P.M. on the 7 day of June A.D., 1984

County Recorder Claudia Kaylor  
By MS, Deputy

DOCUMENT NO. 275705

Statement of Evidence:

- 1867 U.S. General Land Office survey set wood post for this corner and marked the following bearing trees: 10" Aspen N 33 $\frac{1}{2}$ W 40 links, 10" Aspen S 48W 20 links, 10" Birch S 49 $\frac{1}{2}$ E 14 links, and 6" Birch N 61 $\frac{1}{2}$ E 35 links.
- 1912 County Surveyor's Record Book A pages 552 to 555 show survey by Harry S. Todd, Deputy County Surveyor. Survey notes show he found only the southwest GLO Aspen plainly marked. The other bearing trees were gone. He set a stake for the corner from the one bearing tree. Two new bearing trees were marked: 12" Birch N 69-15E 9.85' and 14" Poplar N 18-06W 33.00'.
- 1983 Corner area was searched and no evidence was found of a corner marker or of the bearing trees. A fence line runs from the area of the East Quarter corner of Section 11 north to this corner area. An old corner fence post was found at the end of this fence that had rotted off. The distances from the East Quarter corner to the fence corner was found to be 2635 feet. This fence corner was accepted as the obliterated corner position, based on the fence corner being the best possible evidence of the original corner position. A 2" x 2" x 36" steel post with an aluminum cap was set for the corner and ties taken as shown on this certificate.