

CERTIFICATE OF LOCATION OF GOVERNMENT CORNER

SE Corner of Section 13, Township 143, Range 31, 5th P.M.

STATE OF MINNESOTA, County of Cass

At the corner location shown on the sketch:

- On _____ found a _____
DATE
- left monument as found, lowered monument, removed monument (explain)
- On 2-27-1983 placed a 6"x6"x2' sq. concrete monument with brass cap
DATE from bt's set flush with ground on shoulder of road

SKETCH OF REFERENCE TIES

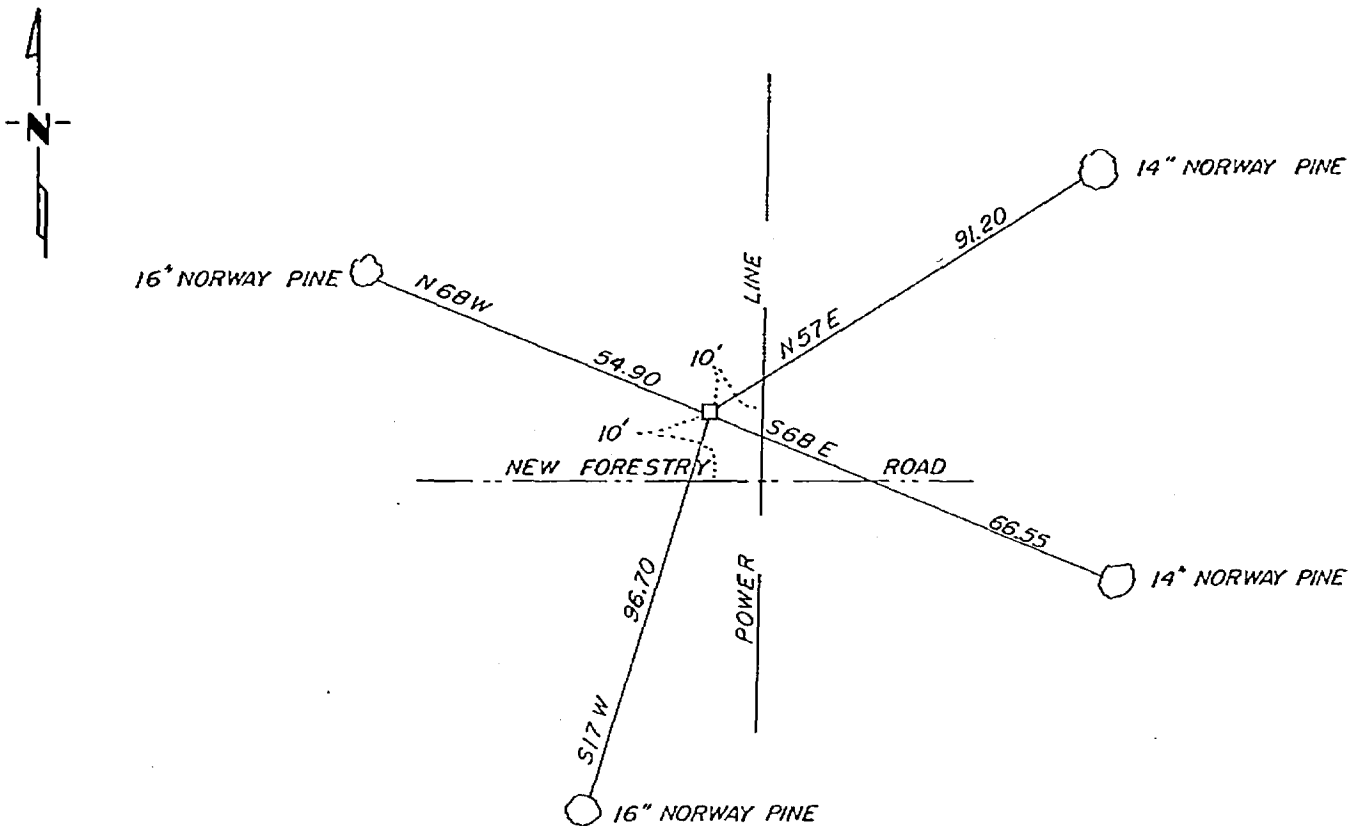

Statement of evidence relative to this corner location is on back of page 268843

I hereby certify that this document and the data contained herein was prepared by me or under my direct supervision.

Walter E. Curo 3-18-83
SIGNATURE DATE

Registration No. 11395

- Land Surveyor, Professional Engineer
- County Surveyor, County Engineer

OFFICE OF THE REGISTER OF DEEDS

County of Cass

I hereby certify that this document was filed in the Reg. of Deeds office at 3:00 P. M. on the 18 day of May A.D., 19 83

Register of Deeds Cloudine Kayler

By MS, Deputy

DOCUMENT NO. 268843

Statement of Evidence:

On 2-27-1983, Walter E. Curo, a registered land surveyor and Ken Metcalf found the concrete monument lying by a tree north of the new road just constructed in the fall of 1982. We reset the concrete monument from the bt's made by Curt Krause and the original bt. stump N 83 W 39 links. As these bt's are in good condition, we do not make any new one's.