

CERTIFICATE OF LOCATION OF GOVERNMENT CORNER

North Quarter Corner of Section 31, Township 140N, Range 30W, 5th P.M.

STATE OF MINNESOTA, County of Cass

At the corner location shown on the sketch:

- On _____ found a _____
DATE
- left monument as found, lowered monument, removed monument (explain)
- On 01/05/83 placed a Minn. Department of Transportation Cast Iron Monument.
DATE

SKETCH OF REFERENCE TIES

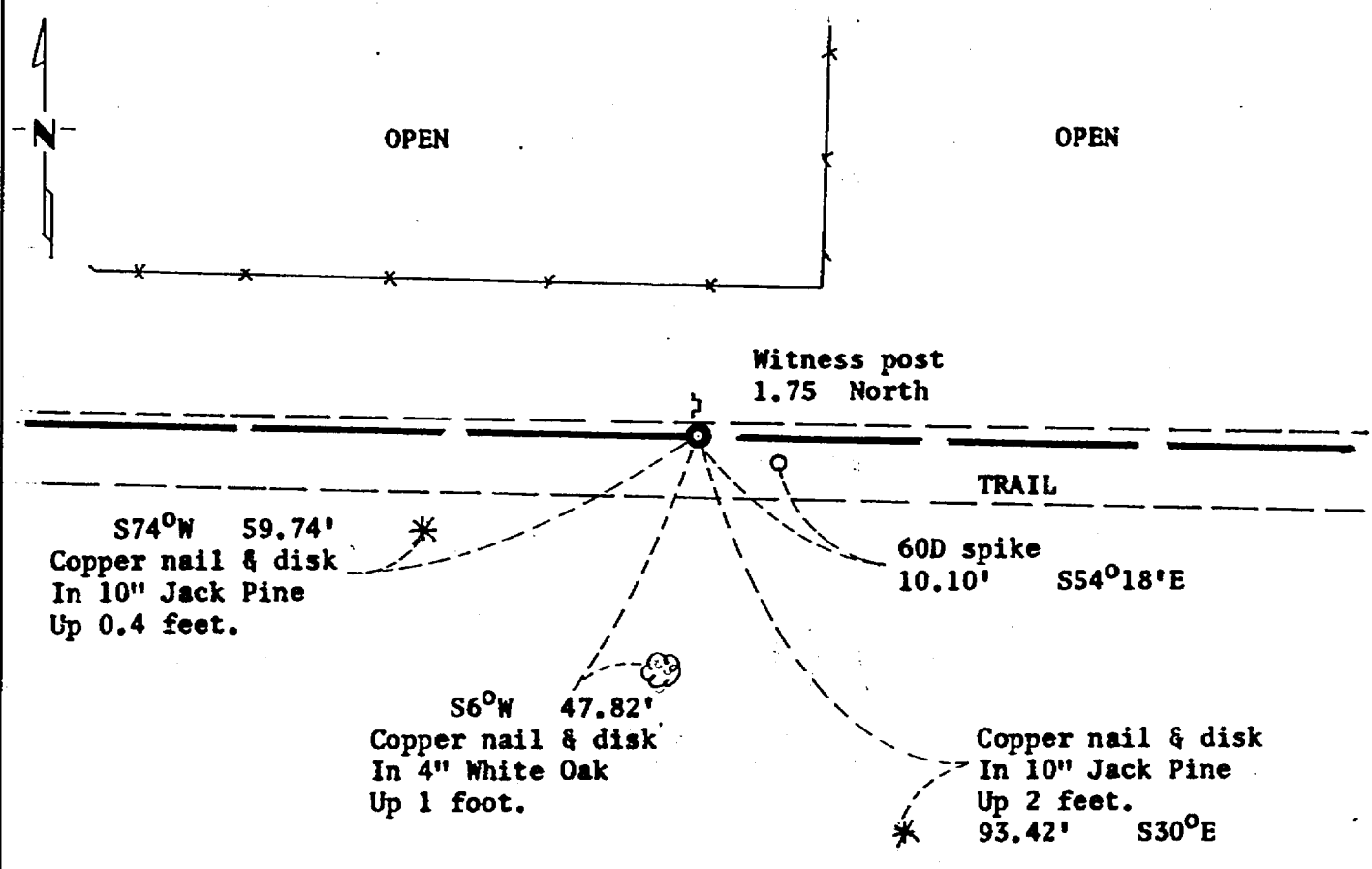

Monument is 5' north of Centerline Trail & 14' west of Fenceline.

Statement of evidence relative to this corner location is on back of page. 267933

I hereby certify that this document and the data contained herein was prepared by me or under my direct supervision.

James W. Nielsen 3/4/83
SIGNATURE DATE

Registration No. 11865

Land Surveyor, Professional Engineer
 County Surveyor, County Engineer

OFFICE OF THE COUNTY RECORDER
County of Cass

I hereby certify that this document was filed in the Co. Recorders office at 10:35 A.M. on the 4 day of April, 1983 A.D.

County Recorder Clouline Kayler
By MS, Deputy

DOCUMENT NO. 267933

Statement of Evidence:

North Quarter Corner of Section 31, Township 140 North,
Range 30 West, 5th Principal Meridian.

The Original Public Land Survey was run in 1865 and a wood post was set to mark the corner.

In 1928 the Minnesota State Highway Department found a railroad spike buried in the old road bed.

In 1983 the Minnesota Department of Transportation recovered a 60D spike in the center of the old road and Government distance from the Southwest Corner of Section 30. The 1928 railroad spike was not found. We set the corner at a lost location on line and government porportion between the Southwest Corner and Southeast Corner of Section 30. This location is 5 feet north of the centerline of the old road and 14 feet west of a fenceline to the north.

For details and survey analysis contact the Minnesota Department of Transportation District Surveys Office in Brainerd, Minnesota.