

CERTIFICATE OF LOCATION OF GOVERNMENT CORNER

East Quarter Corner of Section 30, Township 140, Range 30, 5th P.M.

STATE OF MINNESOTA, County of Cass

At the corner location shown on the sketch:

- On 04/06/81 found a 1" pinched pipe.
DATE
- left monument as found, lowered monument, removed monument (explain)
- On 09/01/82 placed a Minnesota Department of Transportation cast iron
DATE monument.

SKETCH OF REFERENCE TIES

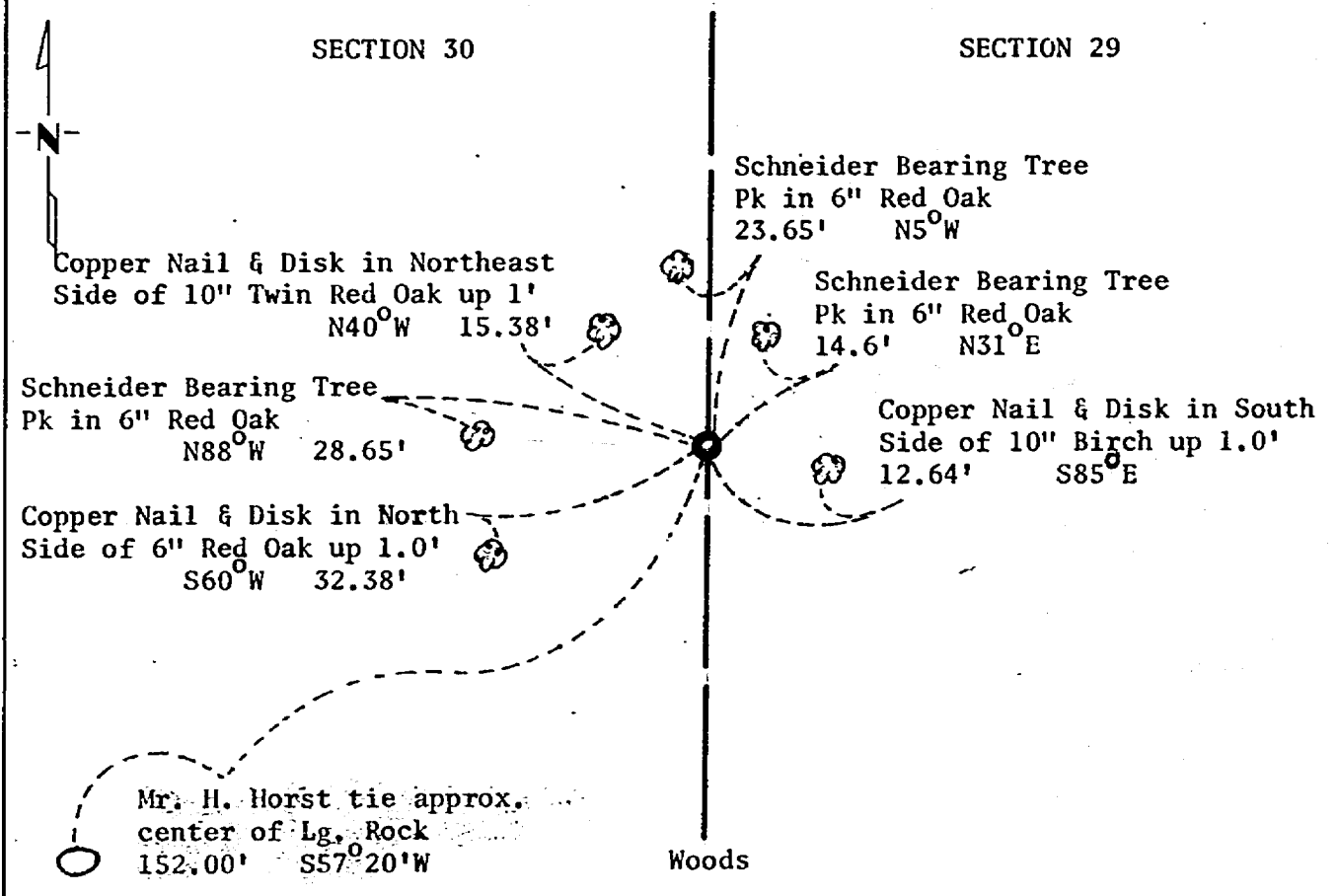

Statement of evidence relative to this corner location is on back of page. 267932

I hereby certify that this document and the data contained herein was prepared by me or under my direct supervision.

James W. Nielsen 3/4/83
SIGNATURE DATE

Registration No. 11865

Land Surveyor, Professional Engineer
 County Surveyor, County Engineer

OFFICE OF THE COUNTY RECORDER
County of Cass

I hereby certify that this document was filed in the Co. Recorders office at 10:30 A.M. on the 4 day of April A.D., 1983

County Recorder Claudine Kayler
By MS, Deputy

DOCUMENT NO. 267932

Statement of Evidence: East Quarter Section 30, Township 140 North,
Range 30 West, 5th Principal Meridian

The original Public Land Survey was run in 1865 and a wood post was set to mark the corner.

In 1908 Mr. B. Brennan set the corner while doing a road survey.

In 1923 Mr. H. Horst used the corner for making a cemetery plat and made 3 bearing tree ties.

In 1928 the Minnesota Highway Department found a hub 2.0' east of the fence corner.

In 1967 Mr. Robert Schneider shows an iron pipe at the corner and made 3 new bearing tree ties.

In 1981 the Minnesota Department of Transportation recovered a 1" pinched pipe at the corner and the large rock Mr. Horst used as a BT. This large rock fits the bearing and distance from the pinched pipe. The Minnesota Department of Transportation accepts the pipe as the correct location for the corner.

For details and survey analysis contact the Minnesota Department of Transportation Surveys Office in Brainerd, Minnesota.