

CERTIFICATE OF LOCATION OF GOVERNMENT CORNER

Southeast Corner of Section 5, Township 141N, Range 25W, 5th P.M.

STATE OF MINNESOTA, County of Cass

At the corner location shown on the sketch:

- On Aug 24 1981 found a 5 in. x 5 in. x 4 ft. square Cedar post lying in the swamp ^{DATE} covered with moss. Scribing was visible on 2 sides.
 - left monument as found, lowered monument, removed monument (explain)
- On Aug 24 1981 placed a 2 in. x 5 ft. galvanized iron pipe with a 2 1/2 in. brass cap, in a pothole in a Cedar swamp, up 1.9 ft.

Declination $4\frac{1}{2}^{\circ}E$.

SKETCH OF REFERENCE TIES

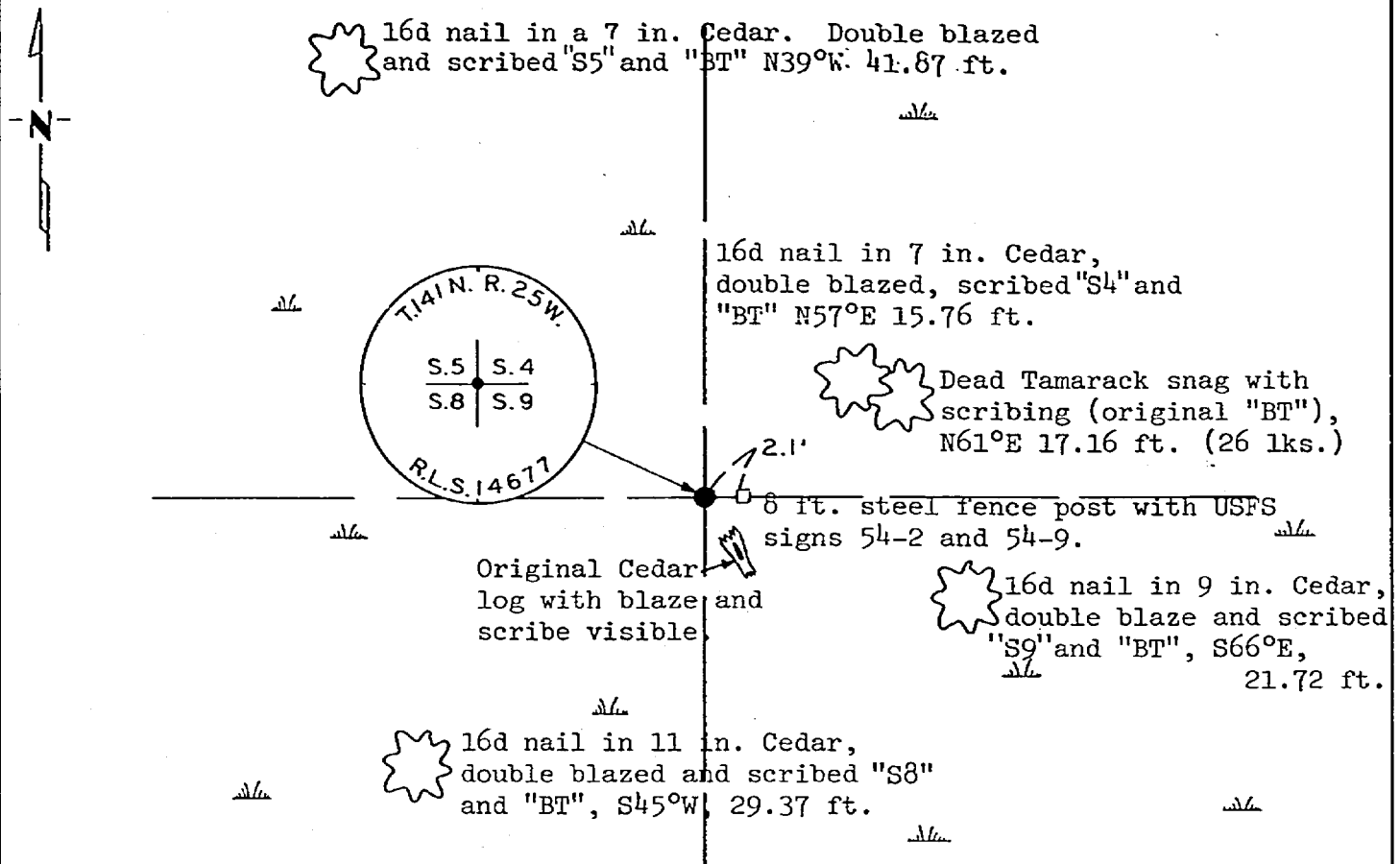

All bearing trees marked with red enamel and Forest Service tags (54-3).

Statement of evidence relative to this corner location is on back of page.

I hereby certify that this document and the data contained herein was prepared by me or under my direct supervision.

[Signature] 12-17-82
SIGNATURE DATE

Registration No. 14677

Land Surveyor, Professional Engineer

County Surveyor, County Engineer

267408
OFFICE OF THE COUNTY RECORDER

County of Cass

I hereby certify that this document was filed in the Co. Recorders office at 9:30 A.M. on the 23 day of Feb. A.D., 1983

County Recorder Claudine Kayler

By MS Deputy

DOCUMENT NO. 267408 **MICROFILM**

Statement of Evidence: Southeast Corner of Section 5, T141N, R25W, 5th P.M.

This corner was originally set in April 1871 by Edgar P. Putnam and William P. Allen. The type of monument was not specified. The bearing trees were a 12" Tamarack, N61°E, 26 lks. (17.16'); an 8" Cedar, N40°W, 19 lks. (12.54'); an 8" Cedar, S37°W, 34 lks. (22.44'); and a 6" Cedar, S29°E, 6 lks. (3.96'). No subsequent record of this corner location can be found.

On April 19, 1978, Milo Stefan, RLS, chained east from Meander Corner No. 2, on east shore of Birch Lake. At 1586 feet (24.03 chains) he found a Tamarack snag but there was too much snow cover and frost to complete a search.

In April 1981, R. Olesen and D. Roerick rough chained north from a fence and road intersection near the southeast corner of Section 8. At approximately 5350 ft. they found a 5 in. x 5 in. x 4 ft. square Cedar post lying on the ground and covered with moss. They also found a Tamarack snag with the scribing visible.

On August 24, 1981, R. Olsesen, D. Roerick, and I went back in to this corner for a more extensive search. We set a point at record bearing and distance from the found Tamarack. From this point we found a 9" Cedar log lying in the swamp covered with moss. It would fit original bearing and distance if it were standing (S29E, 3.96'). The blazes with scribing were visible but very decayed and it disintegrated when we touched it. We did manage to salvage one small piece of reverse image from the overgrowth. We set a 2 in. x 5 ft. galvanized iron pipe with a 2½ in. brass cap and cut new bearing trees as shown on the sketch.