

CERTIFICATE OF LOCATION OF GOVERNMENT CORNER

A.P. #1 of TR 1589 Corner of Section 31, Township 142, Range 30, 5th P.M.

STATE OF MINNESOTA, County of CASS

At the corner location shown on the sketch:

On 3/12/81 found a GLO brass cap monument as set in 1917.
DATE

left monument as found, lowered monument, removed monument (explain)

On _____ placed a _____
DATE

SKETCH OF REFERENCE TIES

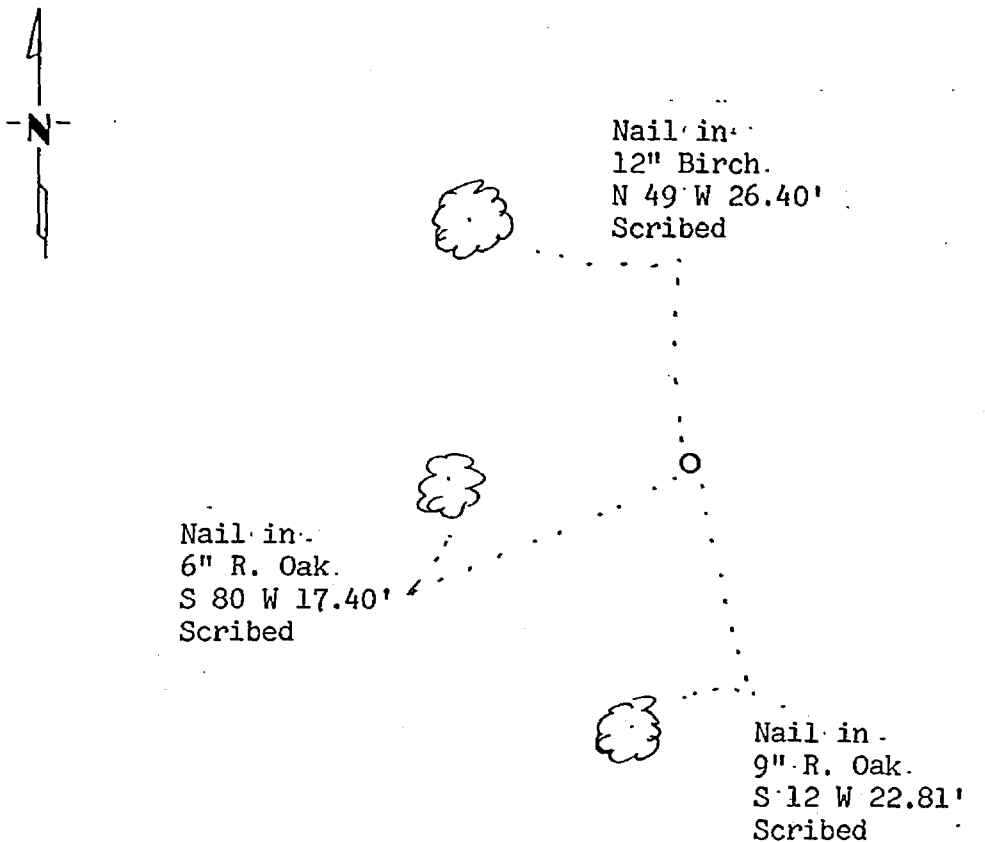

BEARINGS ARE APPROXIMATE

Statement of evidence relative to this corner location is on back of page.

I hereby certify that this document and the data contained herein was prepared by me or under my direct supervision.

May H. Stevens 9-15-82
SIGNATURE DATE

Registration No. 12684

Land Surveyor, Professional Engineer

County Surveyor, County Engineer

265259
OFFICE OF THE COUNTY RECORDER

County of Cass

I hereby certify that this document was filed in the Co. Recorders office at 10:20 A.M. on the 29 day of Sept. A.D., 1982

County Recorder Burrah Hardin

By MS County Recorder
Deputy

DOCUMENT NO. 265259

Statement of Evidence:

- 1917 U.S. General Land Office dependent resurvey established this corner and an iron pipe with a marked brass cap was set to mark the corner.
- 1981 U.S. Forest Service technician W. Olson found the corner monumented with a GLO brass cap monument in good condition up 0.2'. Three new bearing trees were marked and are shown on this certificate. Steel sign posts were set 4.0' north and 4.0' south of the corner. Line was run from the Center $\frac{1}{4}$ corner of Section 30 south through this corner to the CS 1/16 corner of Section 30. The monument fit good with the line and rough-distance measurements also checked good with the 1917 GLO resurvey record.
- 1982 County Surveyor's Records in the Recorder's Office were checked and no resurvey information was found on this corner.
- 1982 On Sept. 9 I visited the corner and found items as per the 1981 USFS reports. The U.S. Forest Service information indicates that the monument was found in the same position as when set in 1917.