

CERTIFICATE OF LOCATION OF GOVERNMENT CORNER

NORTH QUARTER Corner of Section 31, Township 144, Range 30, 5th P.M.

STATE OF MINNESOTA, County of CASS

At the corner location shown on the sketch:

On 3/2/81 found a GLO brass cap monument as set in 1930.
DATE

left monument as found, lowered monument, removed monument (explain)

On _____ placed a _____
DATE

SKETCH OF REFERENCE TIES

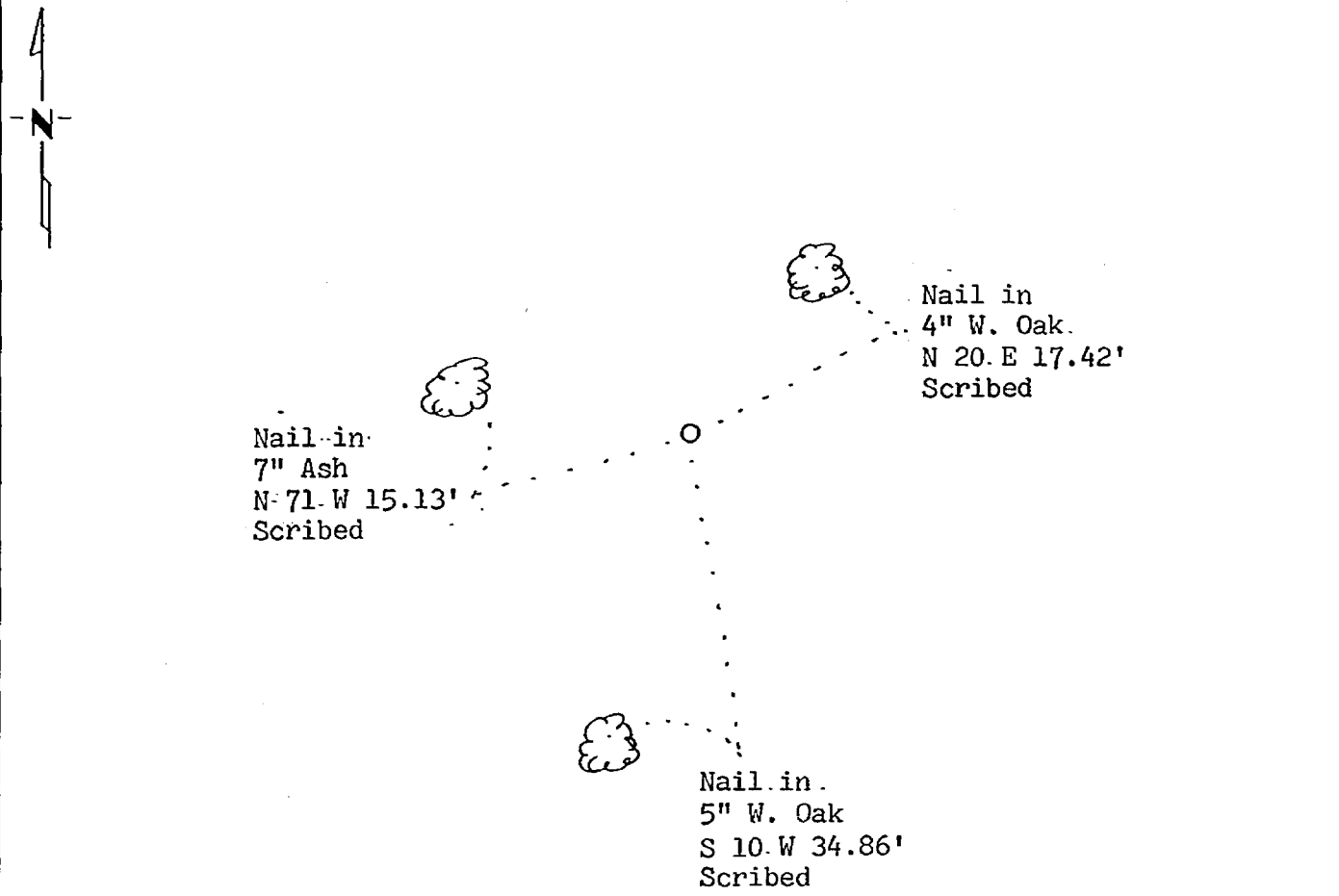

BEARINGS ARE APPROXIMATE

Statement of evidence relative to this corner location is on back of page.

I hereby certify that this document and the data contained herein was prepared by me or under my direct supervision.

Dary H. Stevenson 9-11-82
SIGNATURE DATE

Registration No. 12684

- Land Surveyor, Professional Engineer
 County Surveyor, County Engineer

264960
 OFFICE OF THE COUNTY RECORDER
 County of Cass

I hereby certify that this document was filed in the Co. Recorders office at 10:21 A.M. on the 14 day of Sept. A.D., 1982

County Recorder Beverly Hendricks

By MS, Deputy

DOCUMENT NO. 264960

Statement of Evidence:

- 1875 U.S. General Land Office survey set wood post for this corner and marked the following bearing trees: 4" Sugar S 50 E 290 links and 6" Ash S 29 E 261 links.
- 1930 U.S. General Land Office dependent resurvey reestablished this corner by proportionate distance. No evidence was found of the original corner or bearing trees. An iron pipe with a marked brass cap was set to mark the corner. The following bearing trees were marked: 8" Elm N 15 E 25 links and 8" Poplar S 32 $\frac{1}{2}$ E 56 links.
- 1934 U.S. Forest Service records show the following: CCC record shows brass cap monument and the two 1930 bearing trees found.
- 1981 U.S. Forest Service technician G. Brama found GLO brass cap monument in good condition up 6". The following bearing trees were found: 17" Poplar S 32 E 37.0' and 16" Elm N 15 E 16.5' cut down and now a 3' high stump. Three new bearing trees were marked and are shown on this certificate. Steel sign posts were set 2.6' north and 3.4' south of the corner.
- 1982 County Surveyor's Records in the Recorder's Office were checked and no resurvey information was found on this corner.
- 1982 On Sept. 7 I visited the corner and found items as per the 1981 USFS reports. The 1930 Poplar bearing tree was now a windfall with 4' snag in place. I accepted the monument as marking the same position as when set in 1930 by the GLO resurvey based on the bearing tree evidence.